

1 Existing Elevation A
1:25 @ A0

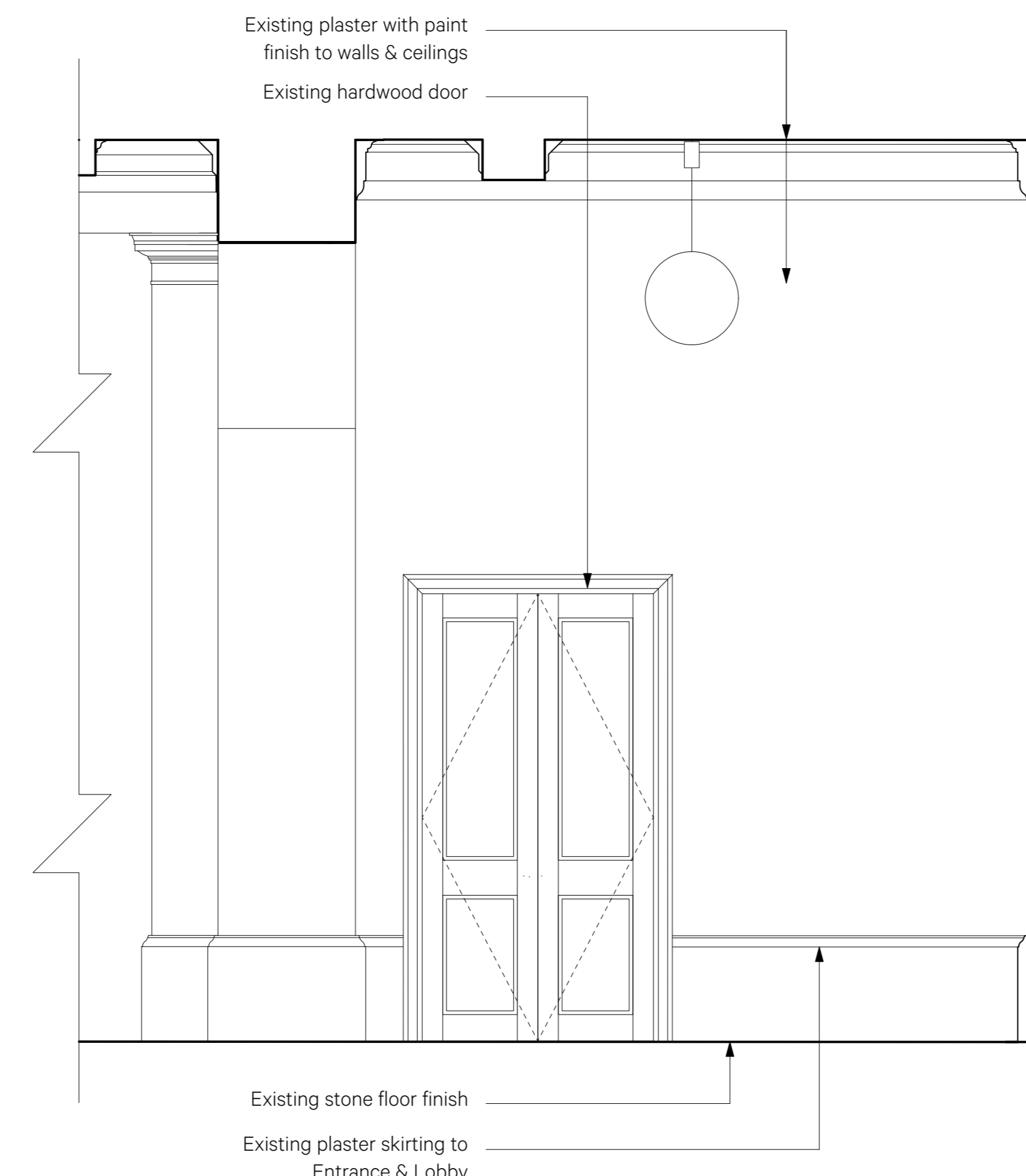

2 Existing Elevation B
1:25 @ A0

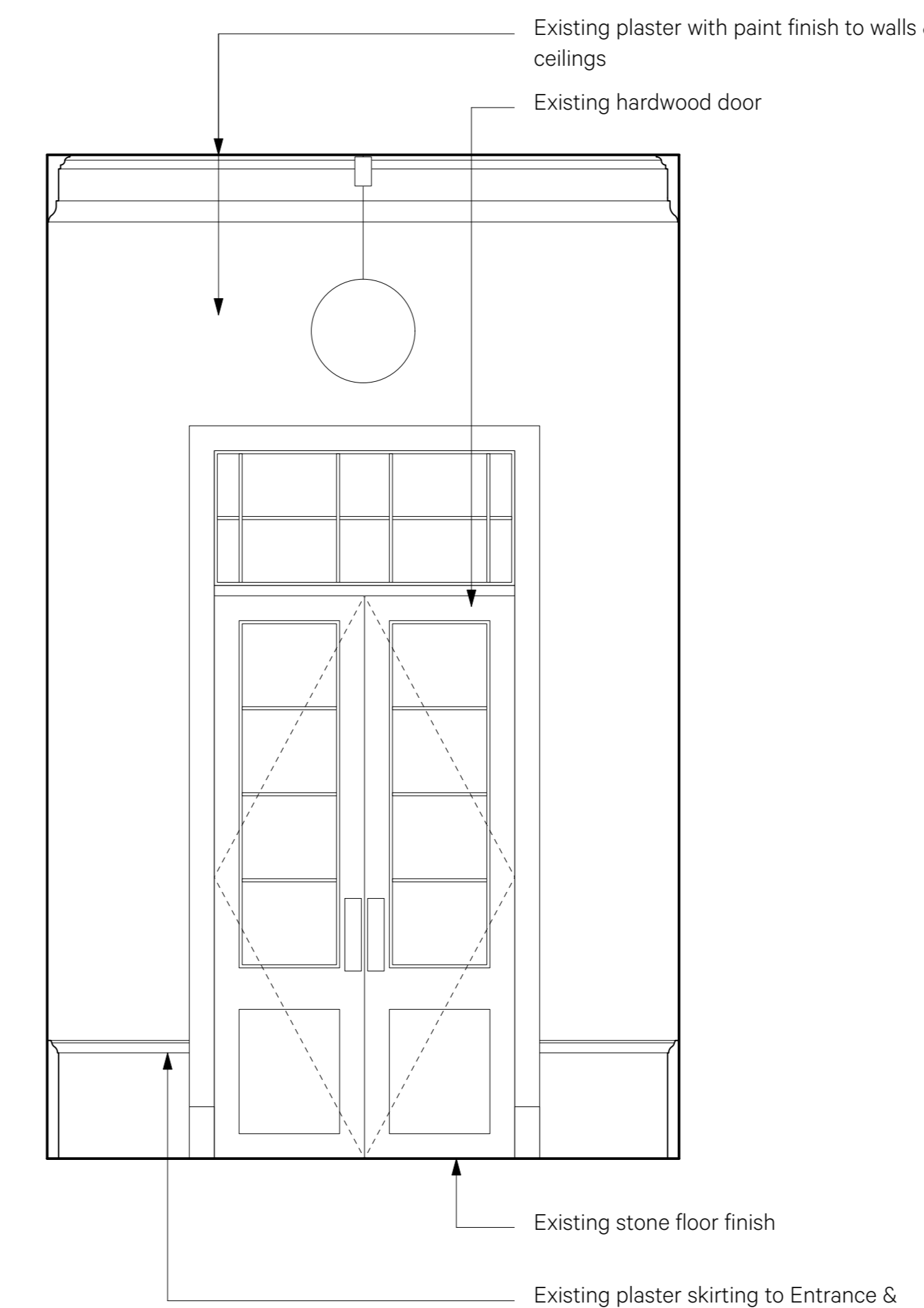

3 Existing Elevation C
1:25 @ A0

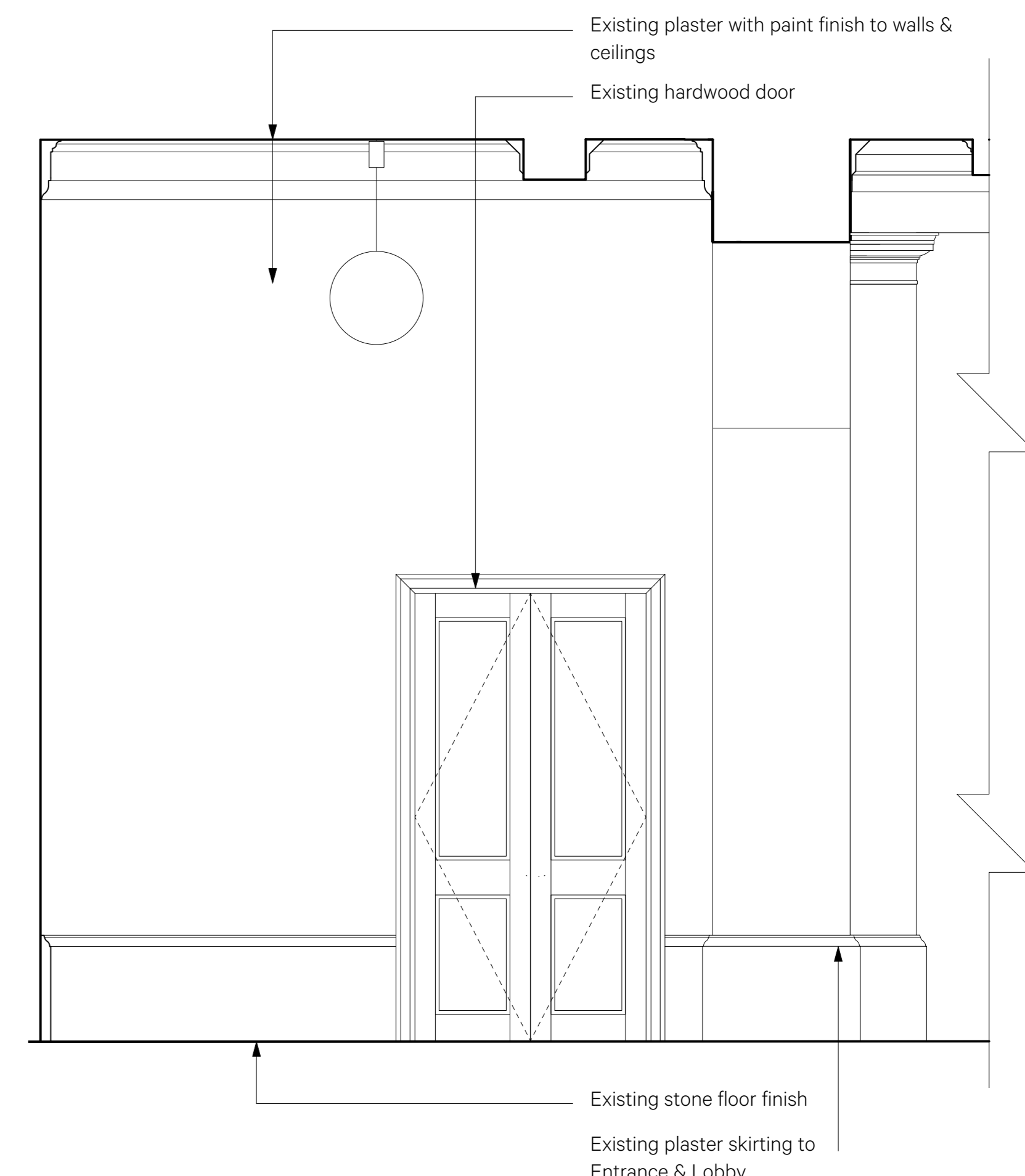

4 Existing Elevation D
1:25 @ A0

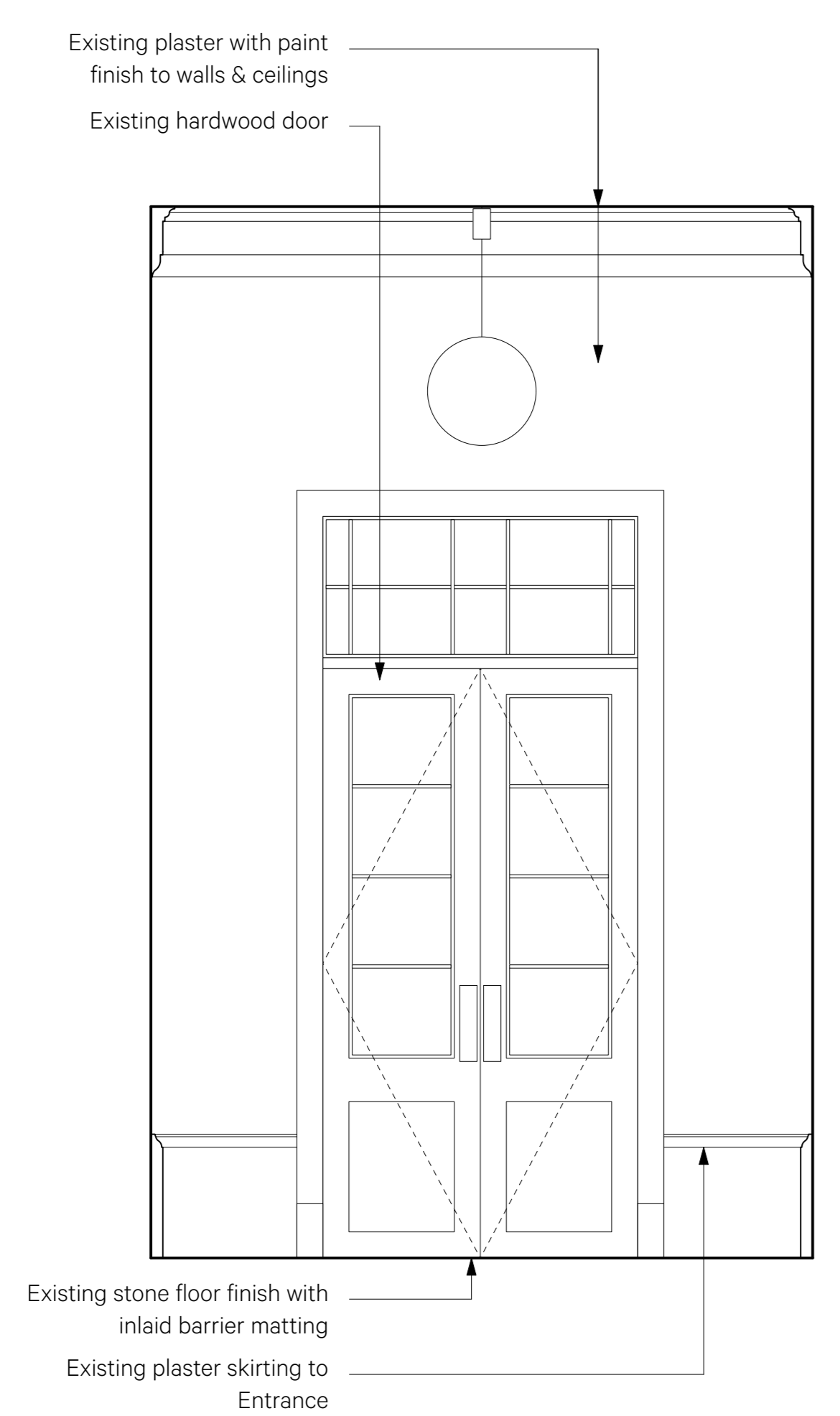

5 Existing Elevation E
1:25 @ A0

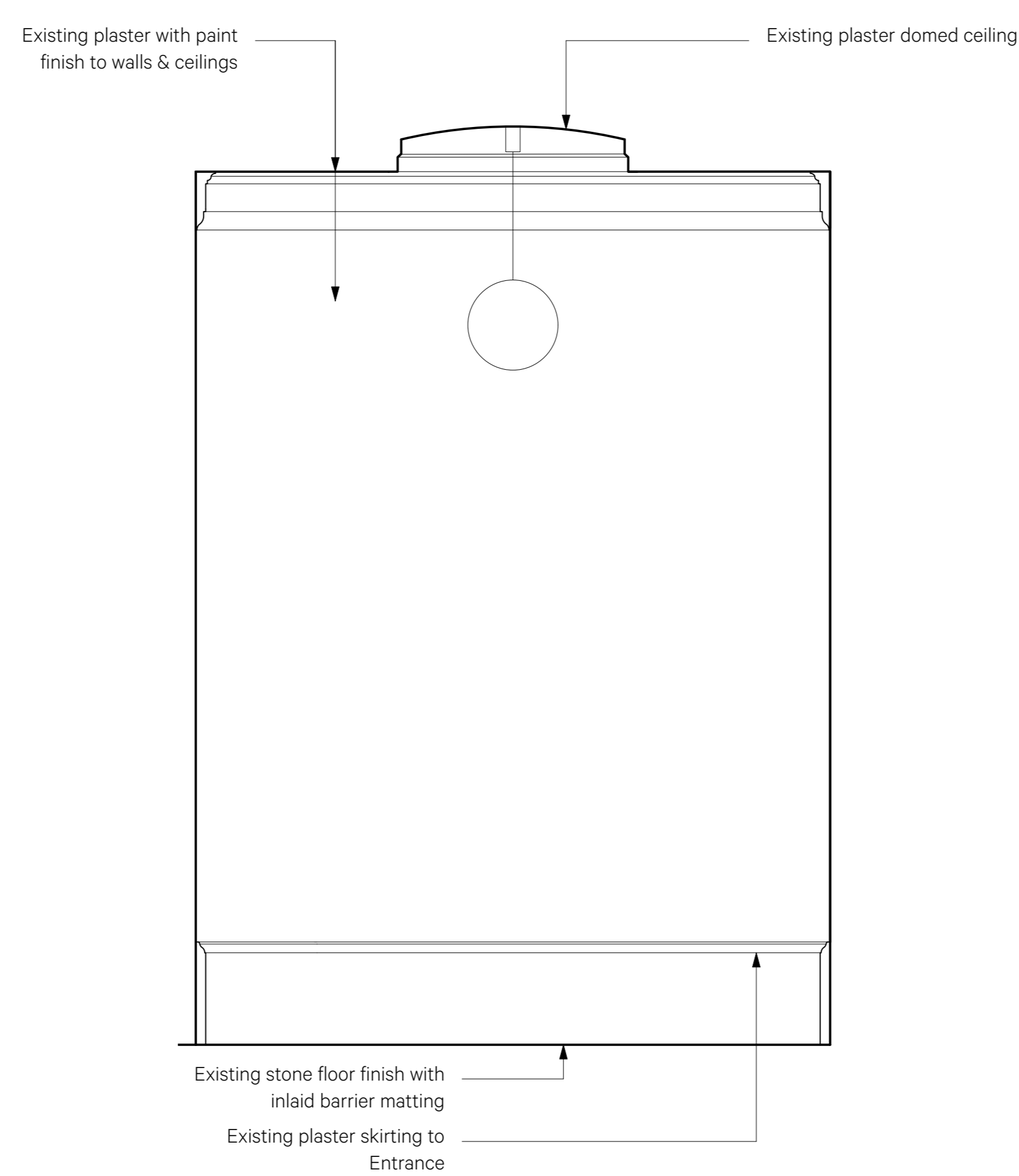

6 Existing Elevation F
1:25 @ A0

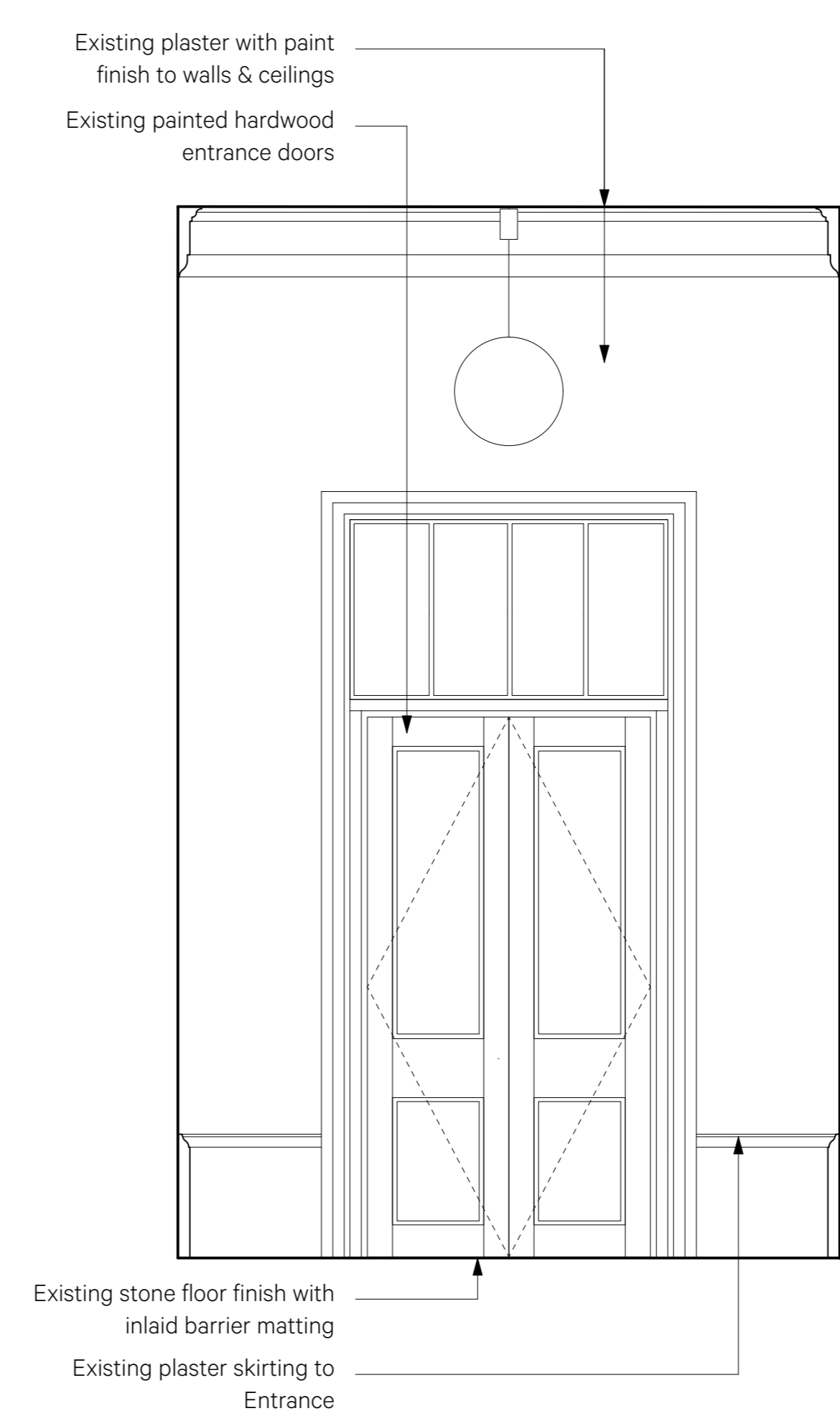

7 Existing Elevation G
1:25 @ A0

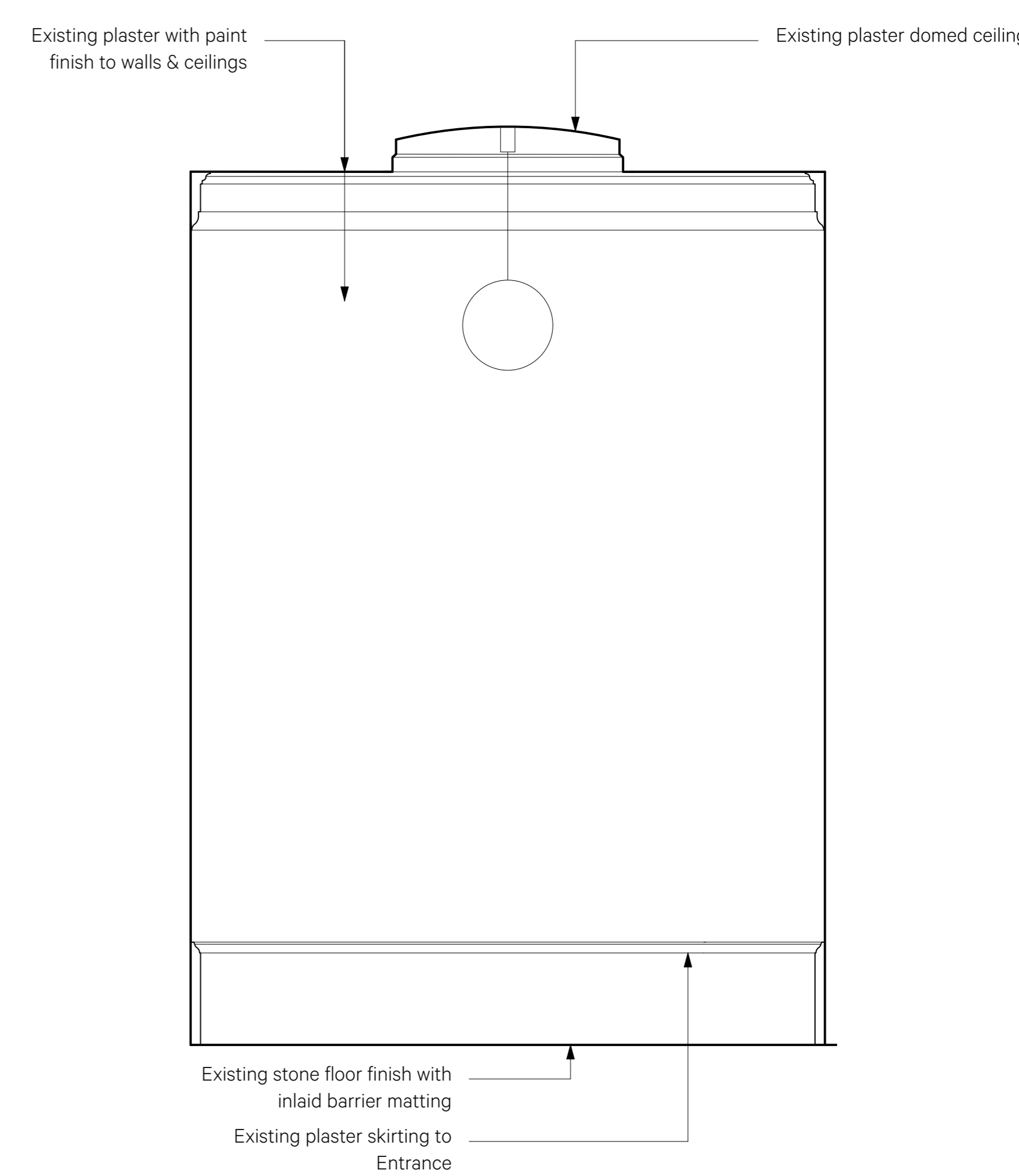

8 Existing Elevation H
1:25 @ A0

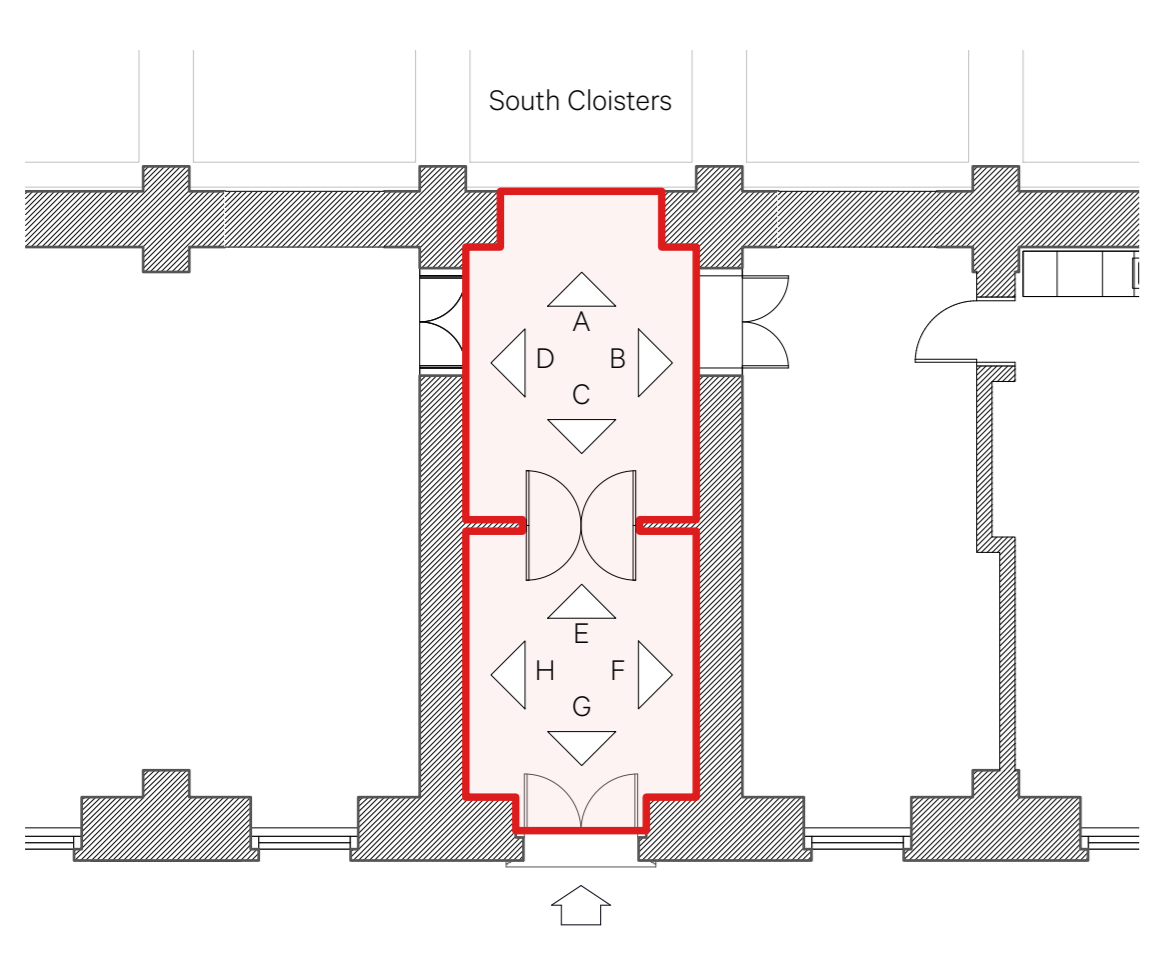

9 South Cloisters Entrance Existing Plan
1:100 @ A0

Date	Revision	Reviewed by	Issue Notes
19/04/2024	P1	SP	First Issue
21/06/24	P2	CP	Stage 3 Issue
19/07/24	P3	CP	Planning Issue

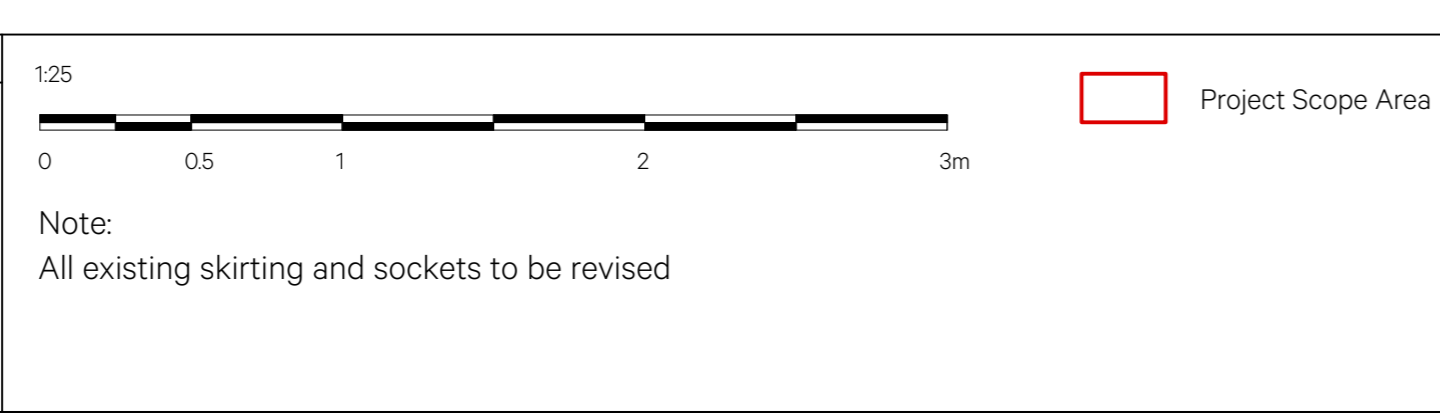

Wilkins Building South Cloisters Entrance - Existing Elevations Existing Elevations		Project Director: SP Drawn By: MM Date: 03/04/2024 Revision: P3	Project No: 980 Scale: 1:50 CAD File Name: 980-A-1230-Wilkins South.wdw Sheet No: 980-A-1237	Client: UCL Design Firm: UNIT 0.01 California Building Debris Gateway London SE13 7JH 020 8306 6010 info@burwellarchitects.com www.burwellarchitects.com	
--	--	--	---	--	--

MEMORANDUMS ARE TO BE KEPT WITH THIS DRAWING. THE CONTRACTOR/MANUFACTURER IS RESPONSIBLE FOR CHECKING ALL DIMENSIONS AND NOTIFYING ANY DISCREPANCIES. THIS DRAWING IS THE PROPERTY OF BURWELL ARCHITECTS LTD. COPYRIGHT IS RESERVED BY THEM AND THE DRAWING IS ISSUED ON CONDITION THAT IT IS NOT COPIED, REPRODUCED, RETAINED OR DELICED TO ANY UNAUTHORIZED PERSON, EITHER WHOLLY OR IN PART, WITHOUT WRITTEN CONSENT.