

New bespoke suspended ceiling fixture with integrated lighting. Fins to be constructed from 18mm Efficiency Ultralight Poplar Plywood (with inner XPS core), with hardwood nosings to all exposed edges, over veneered with hardwood veneer to all faces.

Walls to be made good and redecorated throughout

Ceiling to be made good and redecorated throughout

Existing hardwood doors and skirting to be made good and redecorated with an oil finish to match existing

New engineered hardwood floor finish laid on acoustic underlay. Contractor to allow for smoothing compound to be installed locally beneath the underlay to remove any low spots to provide a level base

New Exhibition / Display Cabinet with LED video wall (comprising 3 no. screens abutting one another, each approx. 2.54m wide x 1.44m high) with integral ventilated AV cabinet and 2 no. recessed display cabinets at low level (with lighting, humidity and temperature control), all housed within PPC aluminium bespoke frame

New inset suspended MF ceiling raft with 12.5mm moisture resistant plasterboard, with perimeter set in 100mm from adjacent downstand beams / walls, with acoustic plaster finish (Baswa Phon Fine 30mm o/a with metal trim to perimeter or equal and approved). Finished ceiling level to be set out 100mm below existing soffit level, which leaves 57.5 mm zone between rear face of plasterboard and existing soffit for cable routes.

New E130 glazed steel doors within metal framed arched portal, colour RAL 8040, with new stone threshold to base of portal. Doors to be capable of being held in the open position with hold open closers.

New hardwood skirting to match existing to be installed where internal partitions have been removed

1 Proposed Elevation A  
125@A0



New bespoke suspended ceiling fixture with integrated lighting. Fins to be constructed from 18mm Efficiency Ultralight Poplar Plywood (with inner XPS core), with hardwood nosings to all exposed edges, over veneered with hardwood veneer to all faces.

Walls to be made good and redecorated throughout

Ceiling to be made good and redecorated throughout

Existing skirting to be made good and redecorated with an oil finish to match existing

New engineered hardwood floor finish laid on acoustic underlay. Contractor to allow for smoothing compound to be installed locally beneath the underlay to remove any low spots to provide a level base

New FCU below window with bespoke PPC aluminium casing, colour RAL 9010

Existing skirting behind to be removed.

New hardwood skirting to match existing to be installed where internal partitions have been removed

Glass within existing painted single glazed timber sash windows to be carefully removed and replaced with Histoglass Mono RT+ glass to improve thermal performance. Contractor to allow for rubbing down, filling any defects, making good and installing new glass with putty detail to match existing profiles and redecorating windows internally and externally with new paint to match existing finish.

New inset suspended MF ceiling raft with 12.5mm moisture resistant plasterboard, with perimeter set in 100mm from adjacent downstand beams / walls, with acoustic plaster finish (Baswa Phon Fine 30mm o/a with metal trim to perimeter or equal and approved). Finished ceiling level to be set out 100mm below existing soffit level, which leaves 57.5 mm zone between rear face of plasterboard and existing soffit for cable routes.

3 Proposed Elevation C  
125@A0

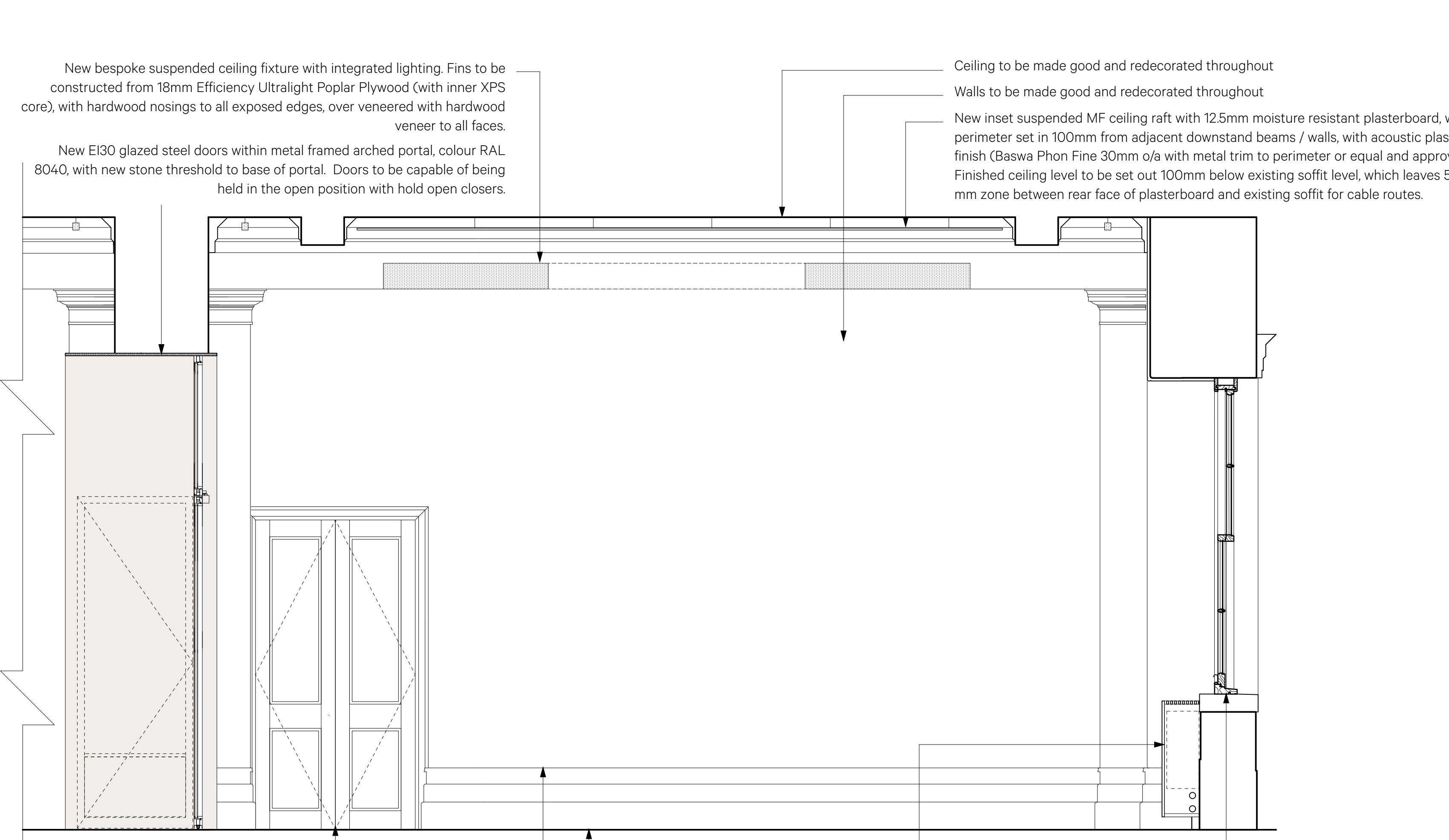

New bespoke suspended ceiling fixture with integrated lighting. Fins to be constructed from 18mm Efficiency Ultralight Poplar Plywood (with inner XPS core), with hardwood nosings to all exposed edges, over veneered with hardwood veneer to all faces.

Walls to be made good and redecorated throughout

Ceiling to be made good and redecorated throughout

Existing hardwood doors and skirting to be made good and redecorated with an oil finish to match existing

New engineered hardwood floor finish laid on acoustic underlay. Contractor to allow for smoothing compound to be installed locally beneath the underlay to remove any low spots to provide a level base

New E130 glazed steel doors within metal framed arched portal, colour RAL 8040, with new stone threshold to base of portal. Doors to be capable of being held in the open position with hold open closers.

New inset suspended MF ceiling raft with 12.5mm moisture resistant plasterboard, with perimeter set in 100mm from adjacent downstand beams / walls, with acoustic plaster finish (Baswa Phon Fine 30mm o/a with metal trim to perimeter or equal and approved). Finished ceiling level to be set out 100mm below existing soffit level, which leaves 57.5 mm zone between rear face of plasterboard and existing soffit for cable routes.

Glass within existing painted single glazed timber sash windows to be carefully removed and replaced with Histoglass Mono RT+ glass to improve thermal performance. Contractor to allow for rubbing down, filling any defects, making good and installing new glass with putty detail to match existing profiles and redecorating windows internally and externally with new paint to match existing finish.

New FCU below window with bespoke PPC aluminium casing, colour RAL 9010

Existing skirting behind to be removed.

2 Proposed Elevation B  
125@A0

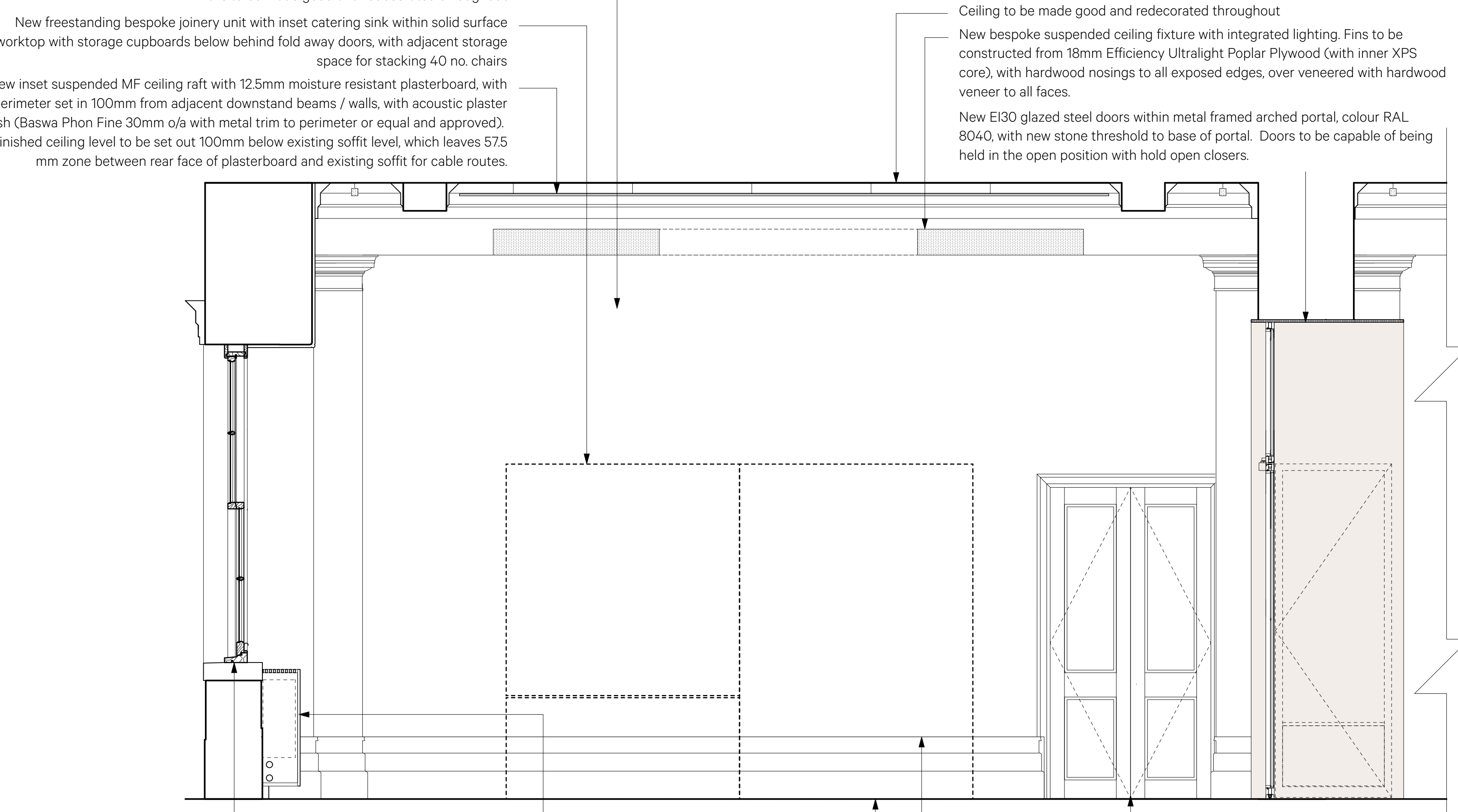

Walls to be made good and redecorated throughout

New freestanding bespoke joinery unit with inset catering sink within solid surface worktop with storage cupboards below behind fold away doors, with adjacent storage space for stacking 40 no. chairs

New inset suspended MF ceiling raft with 12.5mm moisture resistant plasterboard, with perimeter set in 100mm from adjacent downstand beams / walls, with acoustic plaster finish (Baswa Phon Fine 30mm o/a with metal trim to perimeter or equal and approved). Finished ceiling level to be set out 100mm below existing soffit level, which leaves 57.5 mm zone between rear face of plasterboard and existing soffit for cable routes.

Ceiling to be made good and redecorated throughout

New bespoke suspended ceiling fixture with integrated lighting. Fins to be constructed from 18mm Efficiency Ultralight Poplar Plywood (with inner XPS core), with hardwood nosings to all exposed edges, over veneered with hardwood veneer to all faces.

New E130 glazed steel doors within metal framed arched portal, colour RAL 8040, with new stone threshold to base of portal. Doors to be capable of being held in the open position with hold open closers.

Glass within existing painted single glazed timber sash windows to be carefully removed and replaced with Histoglass Mono RT+ glass to improve thermal performance. Contractor to allow for rubbing down, filling any defects, making good and installing new glass with putty detail to match existing profiles and redecorating windows internally and externally with new paint to match existing finish.

New FCU below window with bespoke PPC aluminium casing, colour RAL 9010

Existing skirting behind to be removed.

Existing hardwood doors and skirting to be made good and redecorated with an oil finish to match existing

New engineered hardwood floor finish laid on acoustic underlay. Contractor to allow for smoothing compound to be installed locally beneath the underlay to remove any low spots to provide a level base

4 Proposed Elevation D  
125@A0

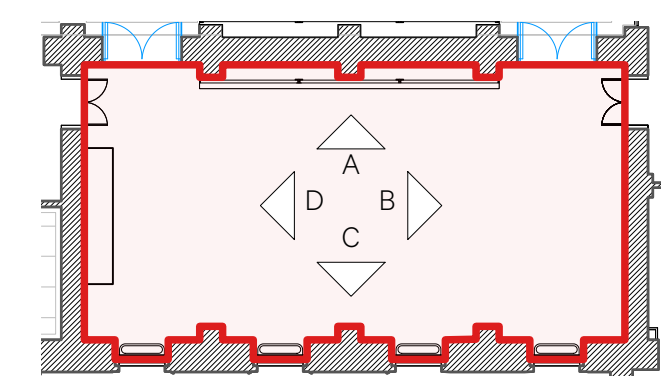

5 Flexible Room 2 Proposed Plan  
1200@A0

Date	Revision	Reviewed by	Issue Notes
25/04/2024	P1	CP	First Issue
21/06/24	P2	CP	Stage 3 Issue
19/06/24	P3	CP	Planning Issue

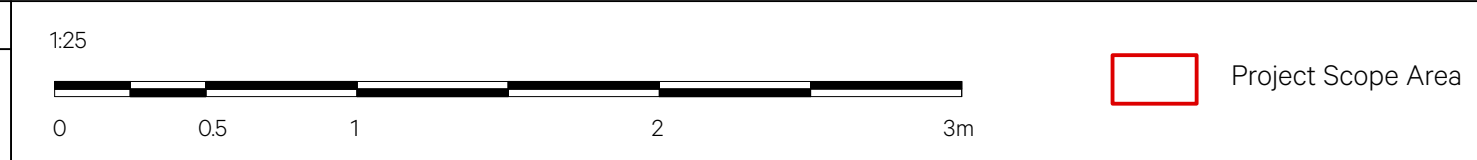

<b>Wilkins Building</b>		Project Director: SP	Project No: 980	Client: UCL
		Drawn By: MM	Scale: 150	
<b>Flexible Room 2 - Proposed Elevations</b>		Date: 03/04/2024	CAO File Name: 980_A_000_Wilkins North.wks	Design Firm: <b>Burwell Architects</b> Unit 001 California Building Deals Gateway London SE13 7JH 020 8305 6070 info@burwellarchitects.com www.burwellarchitects.com
		Revision: P3	Sheet No: 980-A-1228	

NO INFORMATION ARE TO BE SCALED FROM THIS DRAWING. THE CONTRACTOR/MAINFACTORY IS RESPONSIBLE FOR CHECKING ALL DIMENSIONS AND VERIFYING ANY DISCREPANCIES. THE DRAWING IS THE PROPERTY OF BURWELL ARCHITECTS LTD. COPYRIGHT IS RESERVED BY THEM AND THE DRAWING IS ISSUED ON CONDITION THAT IT IS NOT COPIED, REPRODUCED, RETAINED OR DISCLOSED TO ANY UNAUTHORISED PERSON, EITHER WHOLLY OR IN PART, WITHOUT WRITTEN CONSENT.