

NOTE:
All stone sizes are nominal and will be sized to minimise carbon output from the quarry

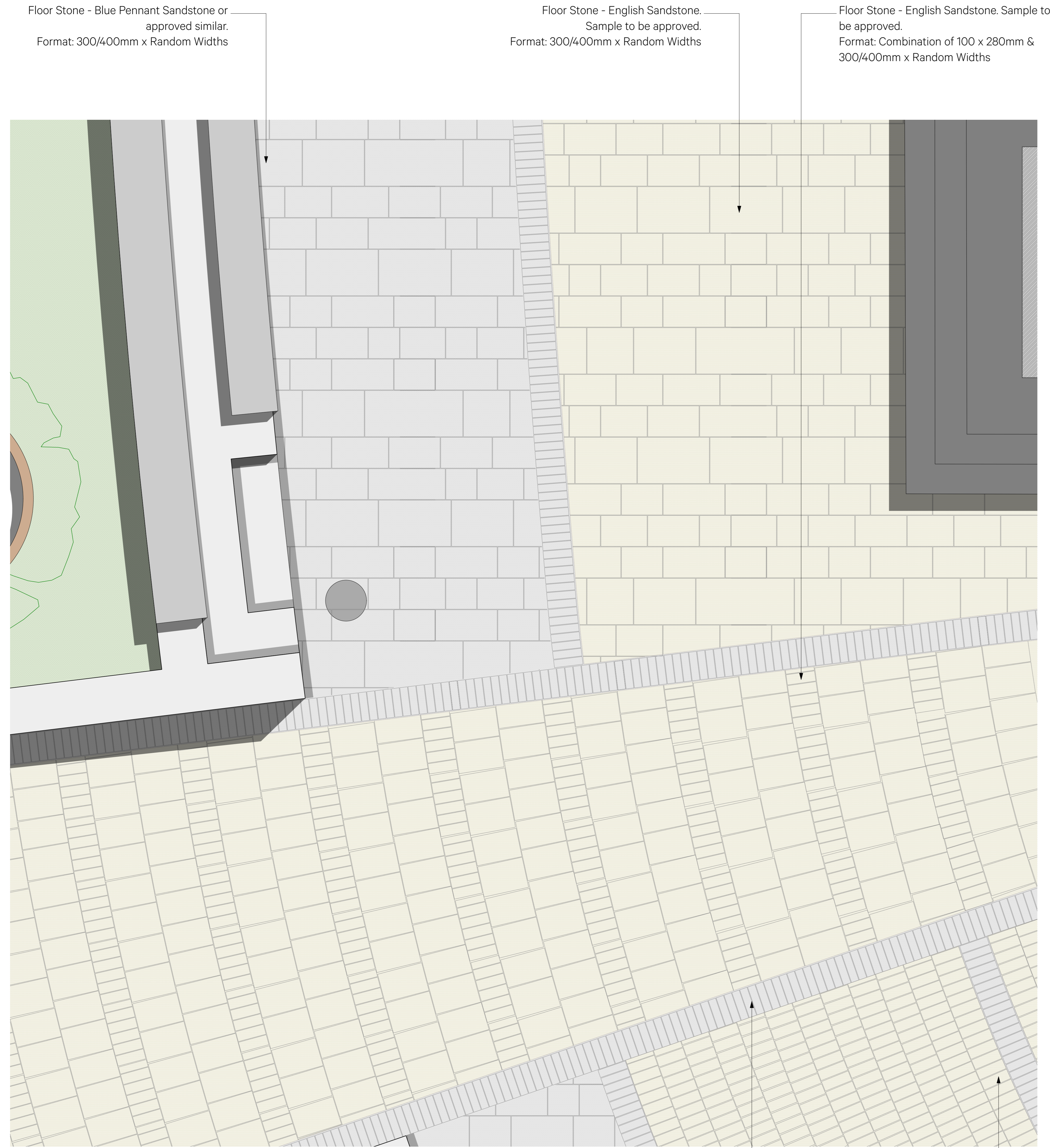

1 Area 03 - Portico Steps & Centre Quad
Scale: 1:20 @ A0

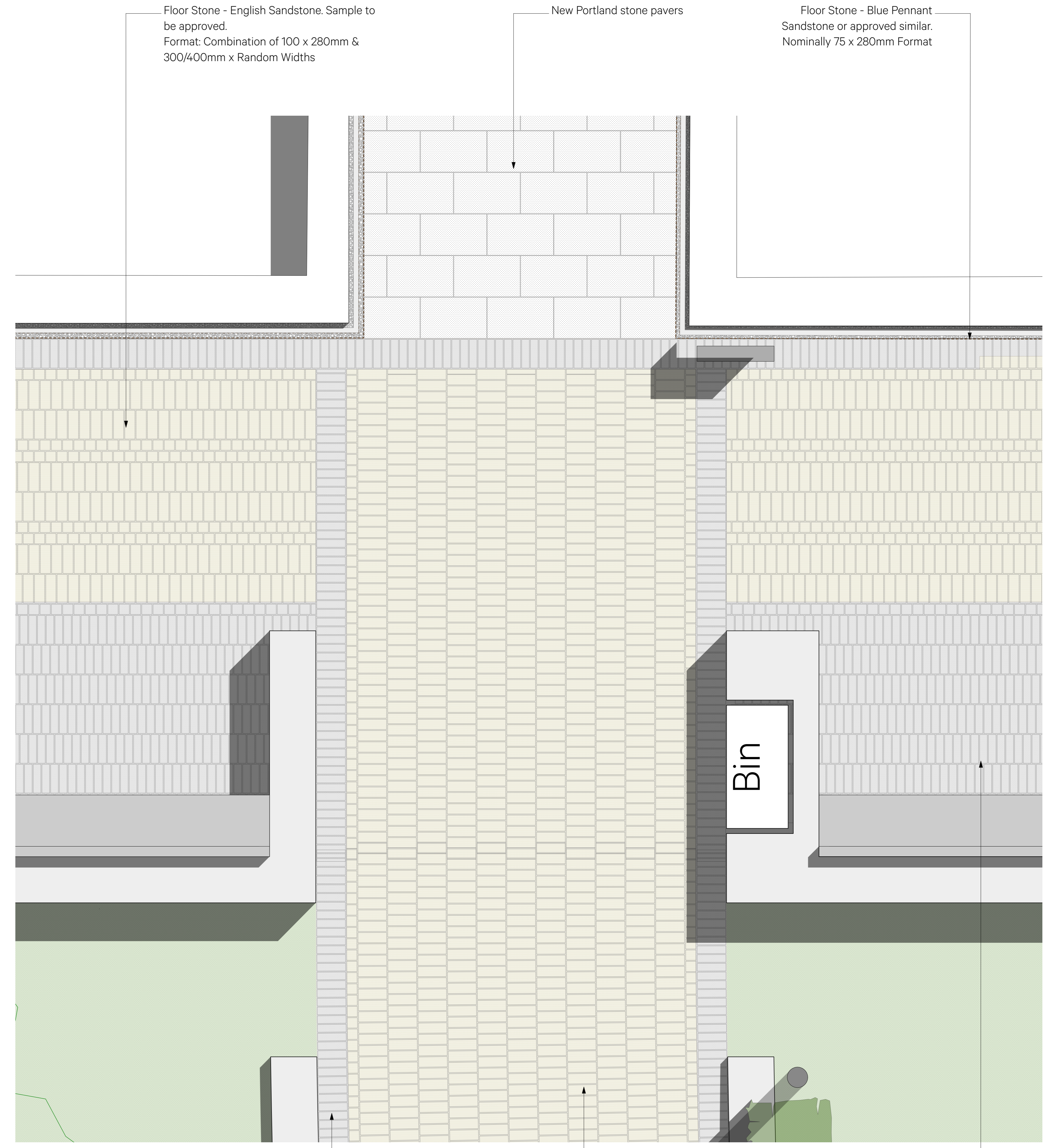
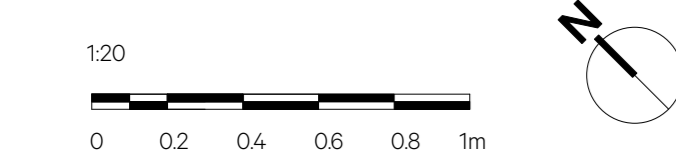

2 Area 04 - North Cloister Entrance
Scale: 1:20 @ A0

Date	Revision	Reviewed by	Issue Notes
07/06/2024	P1	GW	Stage 03 Issue
25/07/2024	P2	GW	ISSUED FOR PLANNING

NO DIMENSIONS ARE TO BE SCALED FROM THIS DRAWING. THE CONTRACTOR/MANUFACTURER IS RESPONSIBLE FOR CHECKING ALL DIMENSIONS AND QUERING ANY DISCREPANCIES. THIS DRAWING IS THE PROPERTY OF BURWELL ARCHITECTS LTD. COPYRIGHT IS RESERVED BY THEM AND THE DRAWING IS ISSUED ON CONDITION THAT IT IS NOT COPIED, REPRODUCED, RETAINED OR DISCLOSED TO ANY UNAUTHORISED PERSON EITHER WHOLLY OR IN PART WITHOUT WRITTEN CONSENT.

Project Title UCL Bi-centennial Main Quad & Wilkins	Project Director NB	Project No. 979	Client UCL London, WICE 6BT
Sheet Title Proposed Stone Patterns (2 of 2)	Drawn By GW	Scale 1:20 @ A0	Design Firm Unit 0.01 California Building Deals Gateway London SE13 7SB 020 8305 6010
Date 29/04/2024	Revision P2	CAD File Name 979-A-0140 Series - Floor Stone Patterns.vwx	Sheet No. 979-A-0141
			Info@burwellarchitects.com www.burwellarchitects.com

