

1 West Road - Proposed Plan (North)
Scale: 1:200

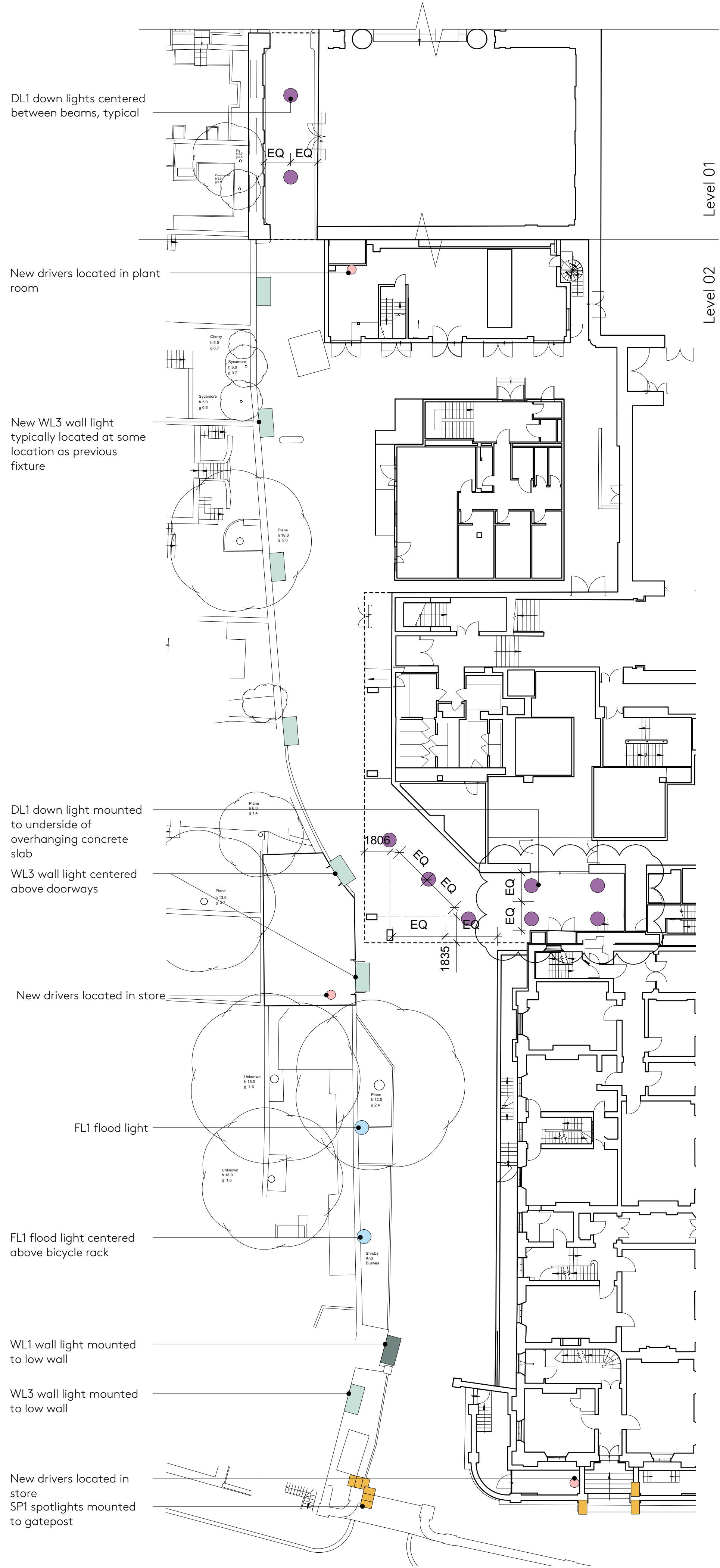

2 West Road - Proposed Plan (South)
Scale: 1:200

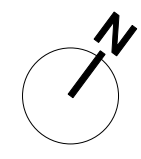

GENERAL NOTES

DO NOT SCALE DRAWINGS. USE DIMENSIONED DRAWINGS ONLY.
ALL DIMENSIONS TO BE CHECKED PRIOR TO COMMENCEMENT OF ANY WORKS. AND / OR PREPARATION OF ANY SHOP DRAWINGS.
ALL DISCREPANCIES TO BE REPORTED TO THE ARCHITECT.
THIS DRAWING TO BE READ IN CONJUNCTION WITH ALL OTHER ARCHITECTS DRAWINGS AND SPECIFICATIONS AND OTHER CONSULTANTS INFORMATION
ALL STRUCTURAL ELEMENTS TO BE CROSS CHECKED WITH ENGINEERS DOCUMENTS

- NOTES
- LIGHT FIXTURE KEY (symbols not to scale)
- WL1 (231W x 30D x 161H)
 - WL2 (180W x 100D x 100H)
 - WL3 (265W x 225D x 70H)
 - XL1 (890L x 81D x 55H)
 - SP1 (50W x 85D x 83H)
 - DL1 (130Diam. x 135H)
 - FL1 (147W x 198D x 100H)
 - PJ1 (231W x 418D x 311H) (at roof level)
 - L1 (10W x 10H x Var.L.)
 - B1 (295W x 240D x 1100H)
 - External Driver cabinet (350w x 300d x 600h)
 - Drivers wall-mounted internally (300w x 150d x 700h)

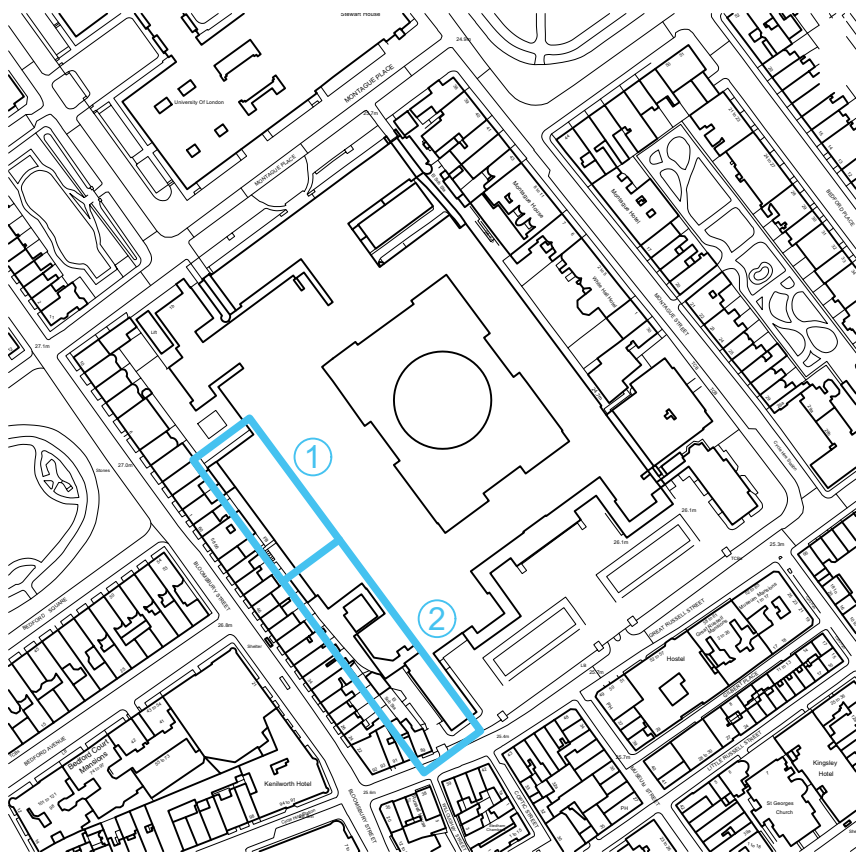

SCHEDULE REFERENCES

REVISION SCHEDULE				
REVISION	DATE	DESCRIPTION	ISSUED BY	
A	21/11/2023	For information	JD	
B	31/01/2024	For information. Revisions to specific light setting outs	JD	
P1	24/04/2024	Planning and Listed Building Applications Issue	JD	
P2	24/06/2024	Revise Planning and Listed Building Applications Issue	JD	

Nex—
55 Whitfield St,
London W1T 4AH
e: office@nex-architecture.com
t: +44 20 7183 0900

—The British Museum
Great Russell St, London WC1B 3DG

PROJECT: BM Lighting			
DRAWING: External Lighting West Road Plan - Proposed			
STATUS: Information	DATE: 24/06/2024	DRAWN: AS	CHECKED: JD
SCALE: 1:200 @ ISO A1	DRAWING NO.: 113-Nex-00-XX-DR-A-211	REVISION: P2	