

EXISTING MEZZANINE PLAN - PLANT ROOM

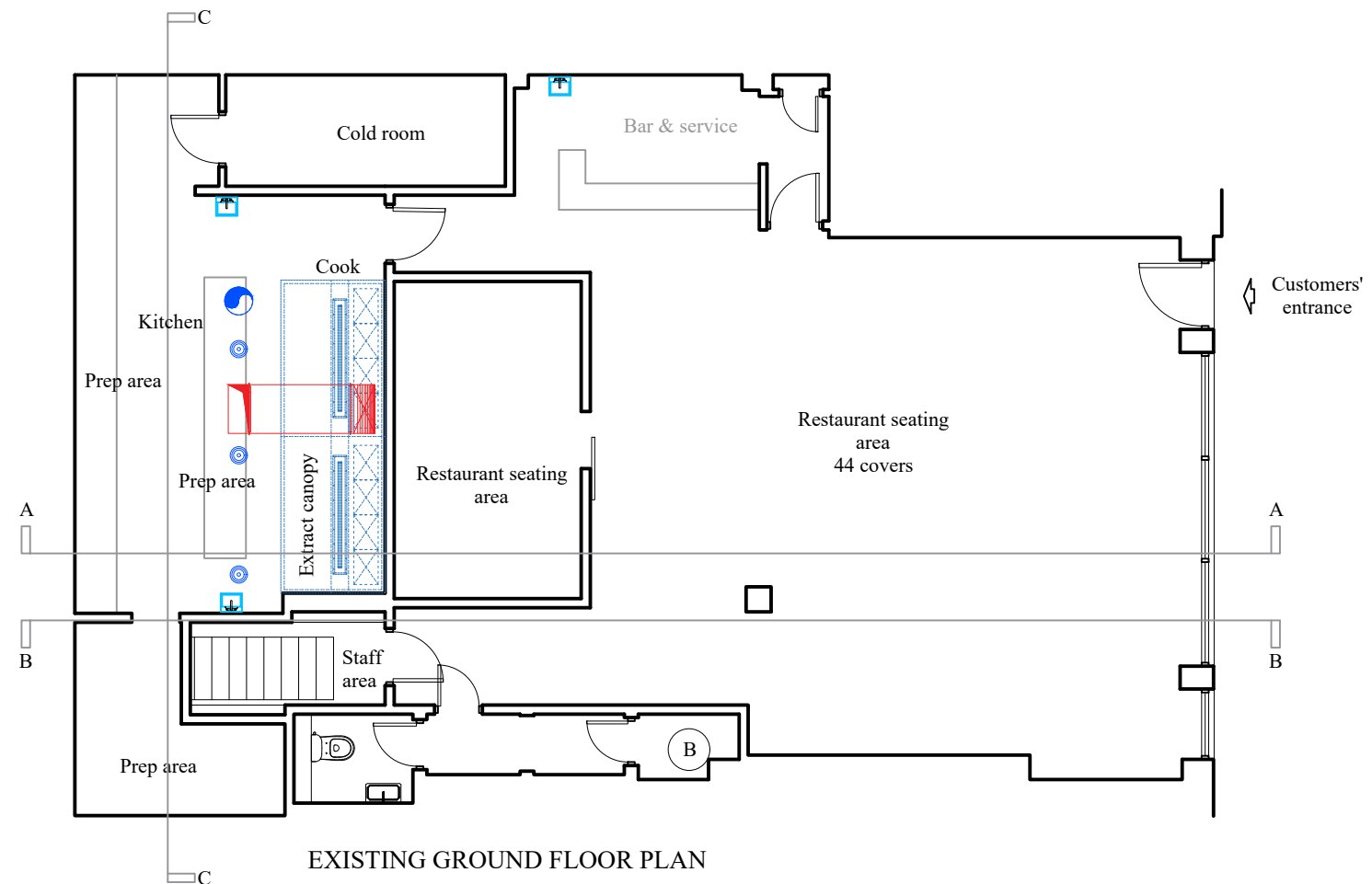

EXISTING GROUND FLOOR PLAN

All dimensions and levels shown are to be verified on site. This drawing is prepared for planing/building regulations application only. All rights reserved.

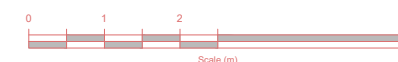

MMPCC
Unit 20, Angerstein
Business Park
Horn Lane
London SE10 0RT

PROJECT:
5 - 7 TOTTENHAM STREET
LONDON
W1T 2AG
TITLE:
DRAWING OF EXISTING

SCALE:
1:100@A3
DRAWN BY:
RG
DATE:
JULY 2024
DRAWING NO:
2402 - 101 - P001

Planning