

ONE LANTERNLIGHT REQUIRED AS DRAWN
Scale 1:30

SPECIFICATION

SPG5b type aluminium glazing bars with PC1 aluminium pressure plates and PC2 type aluminium 'snap on' caps. 500mm high aluminium box section upstand frame, with extruded aluminium cill, ridge & hip sections. 16 gauge aluminium insulated flashings to cill, ridge, and corner positions.

Glazed with 28mm thick double glazed units comp:- 4mm Activ 'self clean' Neutral Toughened outer 18mm argon filled black warm edge spacer 6mm Clear toughened Low e inner pane with clear shatter resistant film applied to inside face

2No Aluminium 'top-hung' ventilators with top aluminium faced panels. Glazed with double glazed units as above Vents fitted with 24v silver 250mm throw slimline chain actuators Operated by single control switch and with external wired rain sensor

Aluminium sections to be polyester powder coated:
~ RAL 7016 matt 'Anthracite Grey'

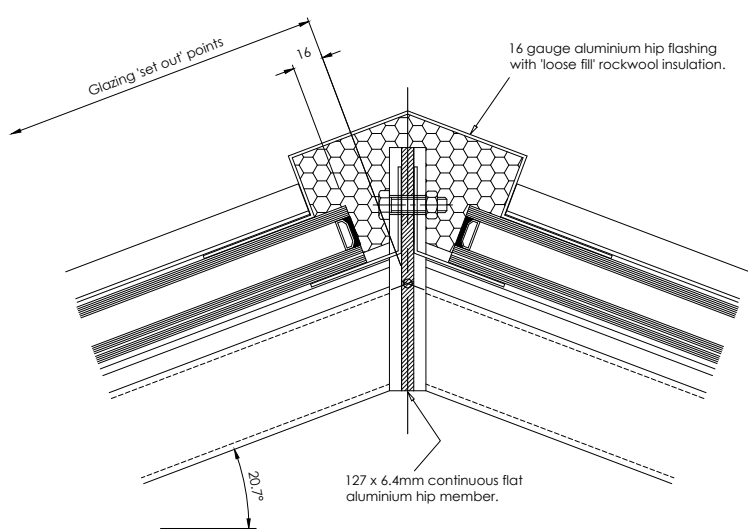
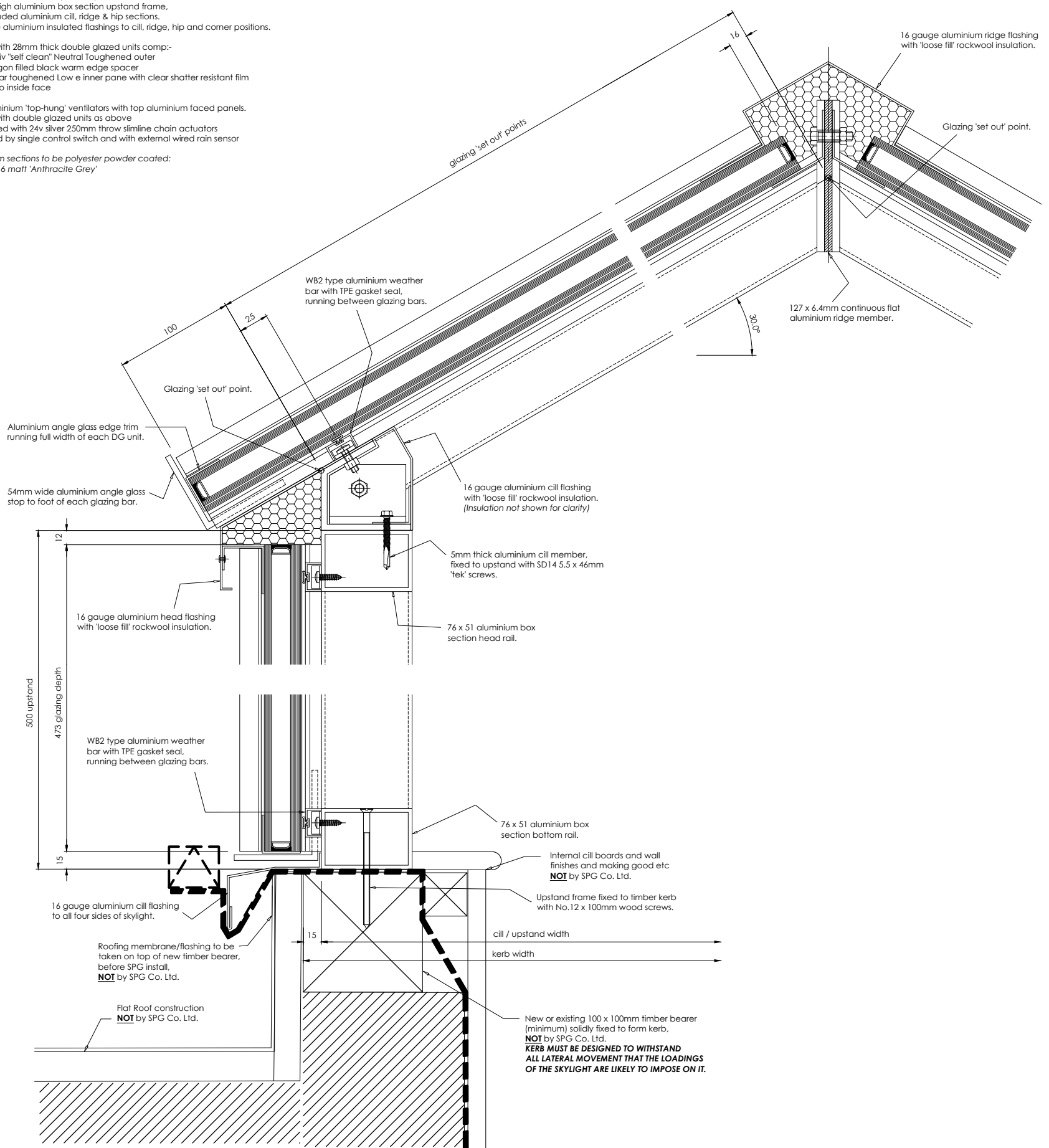

SECTION C - C
Scale 1:2

- NOTES**
1. This drawing is copyright. It must not be copied or disclosed (in whole or in part) to third parties without our written consent.
 2. The design and details shown on this drawing conform to the requirements of BS 5516: Parts 1 and 2 - Patent Glazing and Sloping Glazing for Buildings.
 3. Do not scale dimensions or details from this drawing. If in doubt, please ask.
 4. Structure to be designed by a Structural Engineer to withstand all loadings imposed by the patent glazing.
 5. The Standard Patent Glazing Company is not responsible for the overall design of the project, and our drawings are for reference only.
 6. Details embody current designs but we reserve the right to amend or modify profiles and fittings without notice.
 7. Size Variations : Bar lengths and frame ±1.5mm. Composite installations may exceed this.



REV.	DATE	DESCRIPTION	INITIALS
C	18/12/23	Issued for construction	TG
B	17/11/23	Site sizes added following site survey	CJR
A	09/11/23	First Issue	EJG

TITLE
Self Supporting Lantern Light

PROJECT
Hayworthe House
Haywards Heath
Sussex
RH16 1DB

MAIN CONTRACTOR
Sunninghill Construction

ARCHITECT



Email: info@patent-glazing.com

QOP 3 - 3			
DRAWN BY:	EJG	DATE:	09/11/23
CHECKED BY:	CJR	DATE:	09/11/23
DRAWING No.	31033 /01	REV.	C
ISSUED FOR: For Construction			