

Notes

- 1 All dimensions and levels are to be determined and or checked by the contractor on site, should any discrepancy be identified between the dimensions, and or details determined on site, and those shown those shown on the relevant drawings, the architect shall be notified immediately, and their instructions obtained prior to the commencement of the work.
- 2 The contractor shall be responsible for the design and implementation of all temporary works, and the safety and stability of the new works and adjacent structures during construction.
- 3 Where a product is specified to be obtained from a manufacturer or supplier, the contractor shall install the product in accordance with the instructions supplied by the manufacturer. Should there be any variation between the work specified on the drawings and the manufacturers instructions, the contractor shall refer the matter to the architect for instruction before proceeding.
- 4 If there are any discrepancies between architectural and any consultant information, the design team must be notified immediately, structural information takes precedence.

Drawing Notes / Legend

No	Date	Description
01	18.07.24	ASHP Planning App

Revisions

Air source heat pump within acoustic enclosure

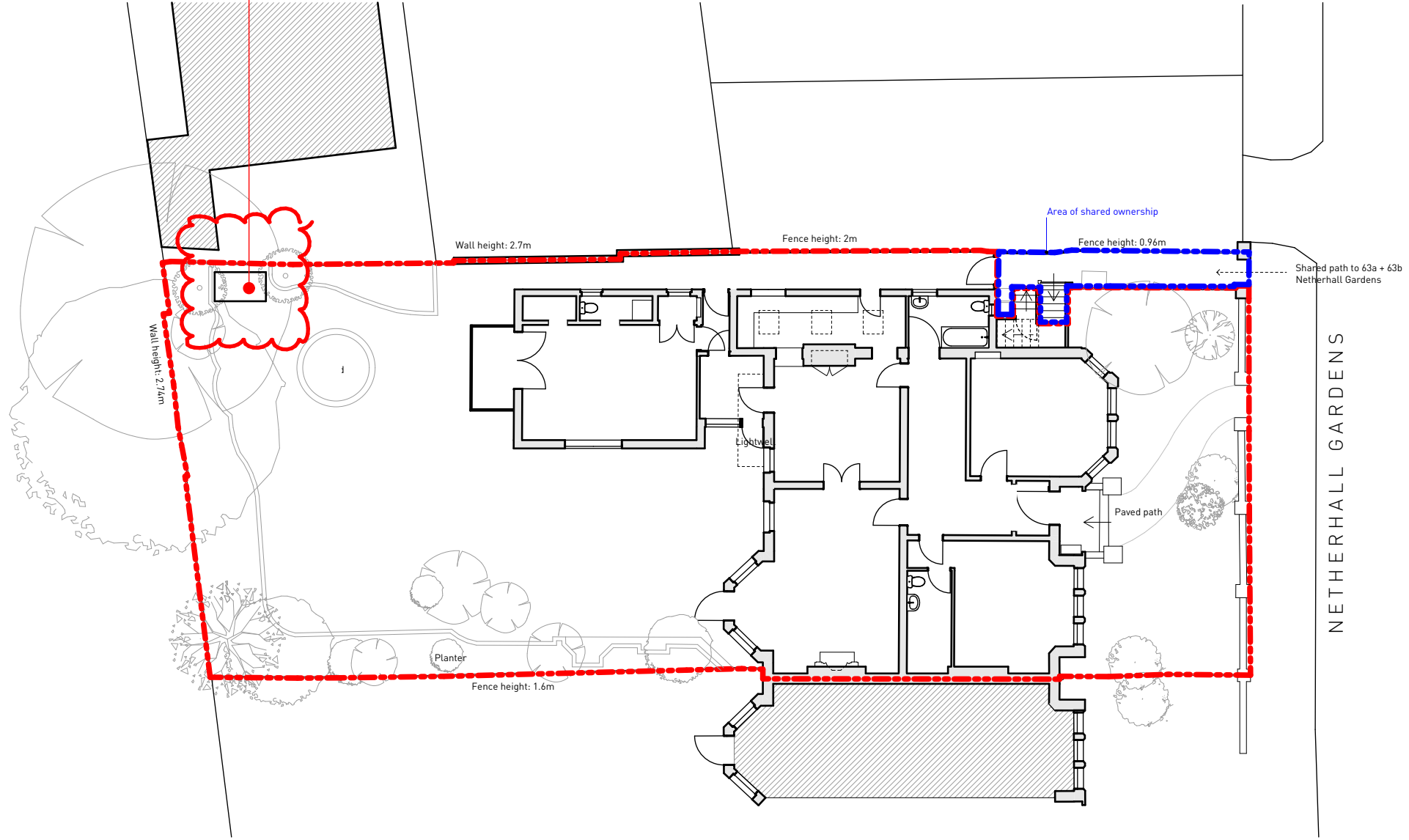

Proposed Site Plan 1:200

Project	FF23-014	
Client	Adele	
Location	63 Netherhall Gardens London NW3 5RE	

Fraher and Findlay		
Unit 3, Mercy Terrace		
Ladywell Rd		
London SE13 7LX		
www.fraherandfindlay.com		
+44 (0)20 8314 5221		

Title	Proposed Site Plan	
Status	Planning	Scale 1:200@A3
Drawn	JH	Checked JH Authorised EF
Revision	P01	Date 18.07.2024
FF23-014-PL-032		