

- Notes
- Existing
 - Proposed
 - Site boundary
 - Proposed soft landscaping

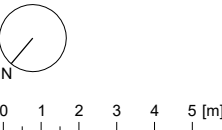

20 Eton Villas

Proposed

097-A-001

Site Plan

07.12.23	1:200 @ A3
RC	MC

HESSELBRAND

© Hesselbrand Ltd. All rights described in Chapter IV of the Copyright, Designs and Patents Act 1988 have been asserted. The drawing is to be read in conjunction with specifications and all relevant drawings. Contractor to check all dimensions on site. Do not scale from this drawing. Hesselbrand Ltd is to be advised of any variation between the drawings and the site conditions.

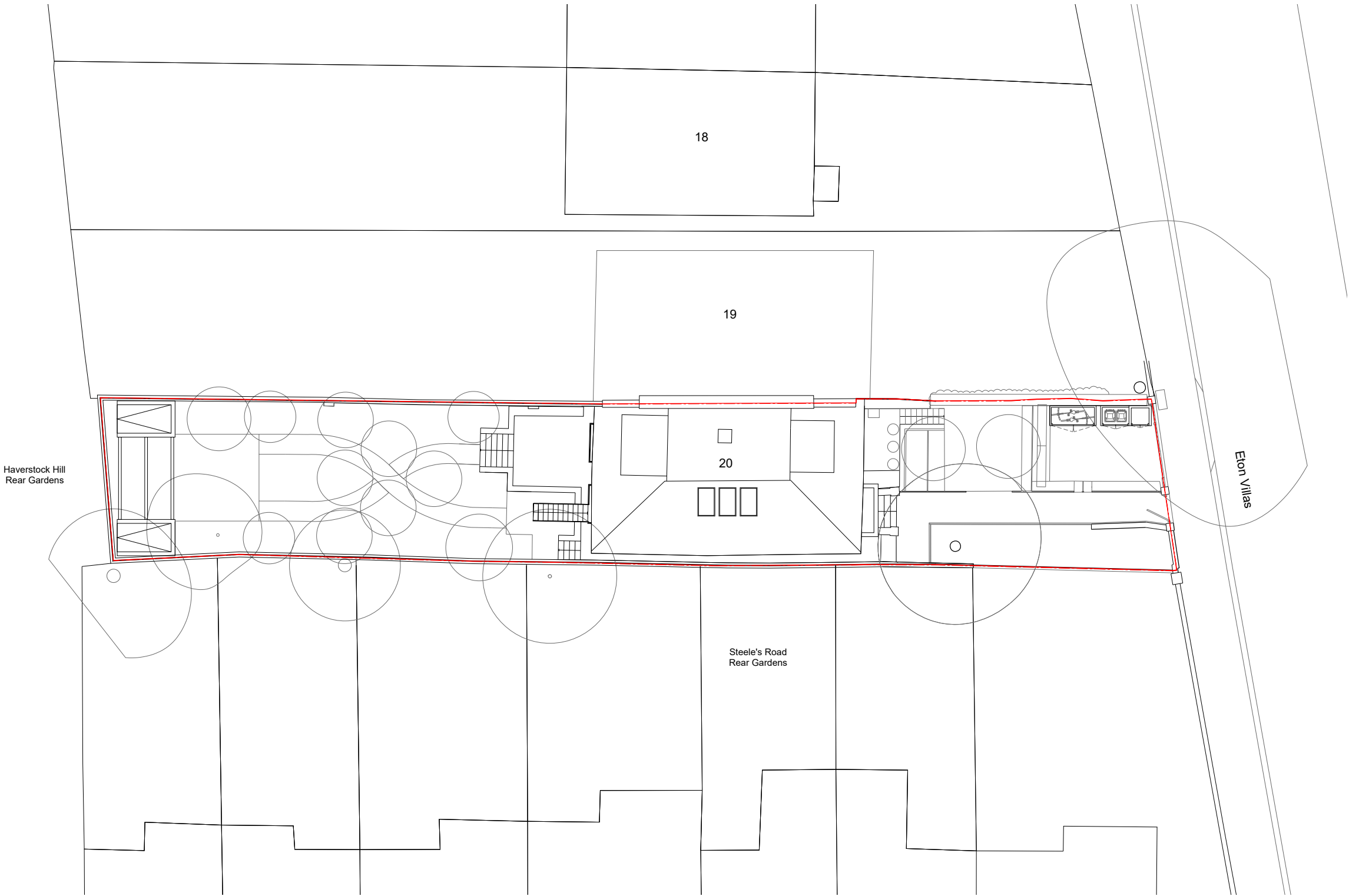

- Notes
- Existing
 - Proposed
 - Site boundary
 - Proposed soft landscaping

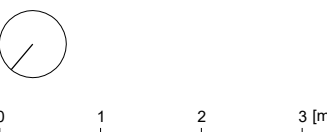
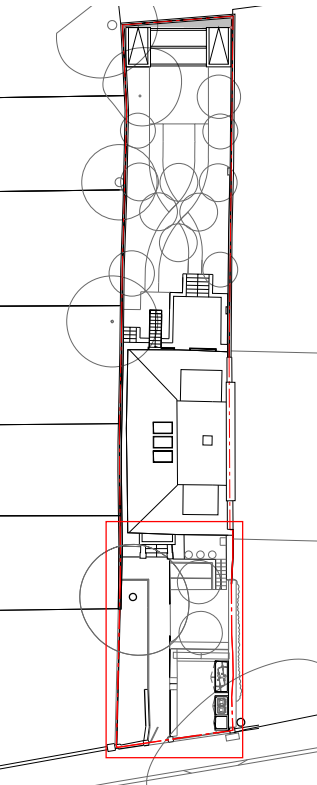
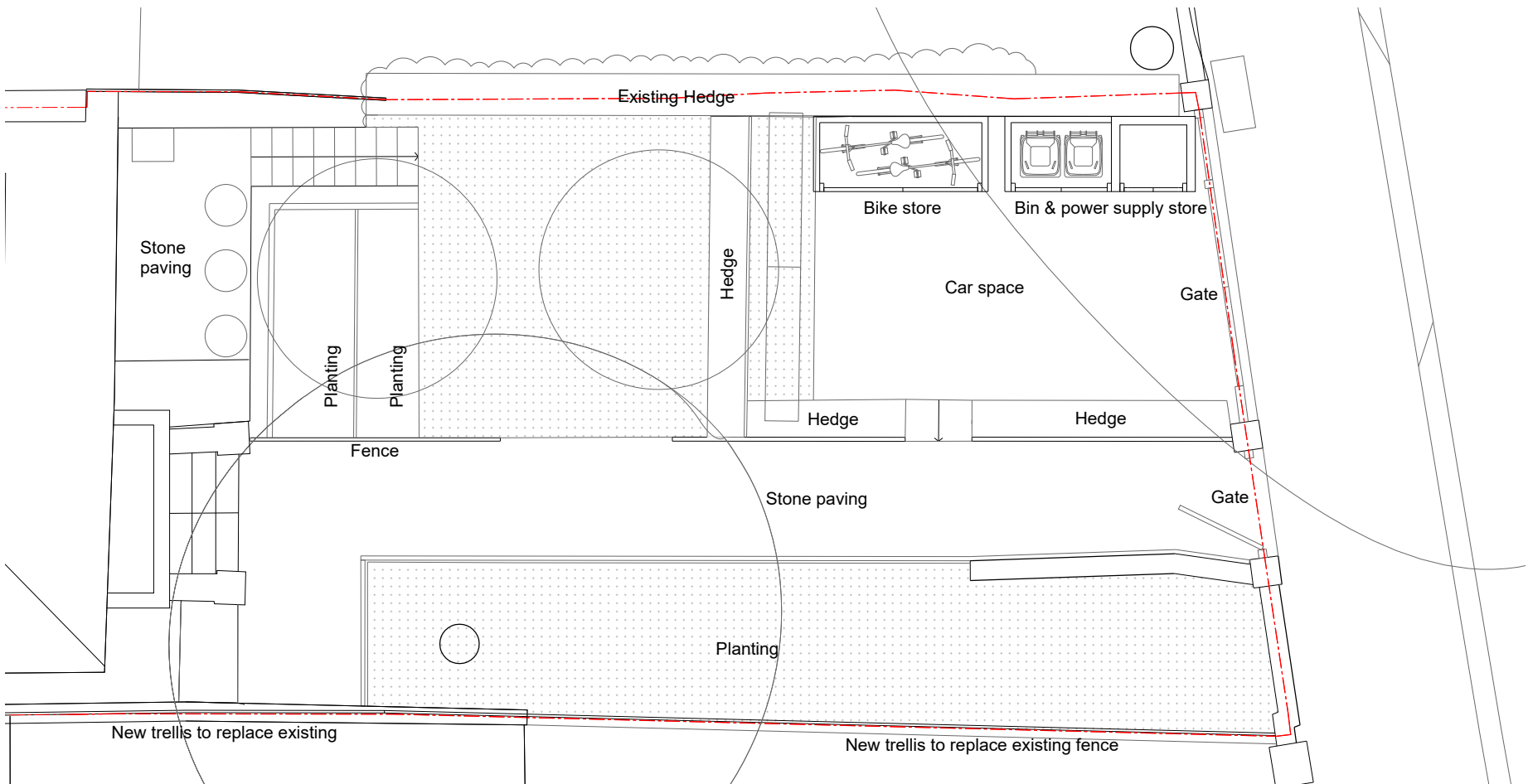

20 Eton Villas
Proposed

097-A-010

Front Garden Plan

07.12.2023	1:75 @ A3
KP	RC

HESSELBRAND

- Notes
- Existing
- Proposed
- Site boundary
- Proposed soft landscaping

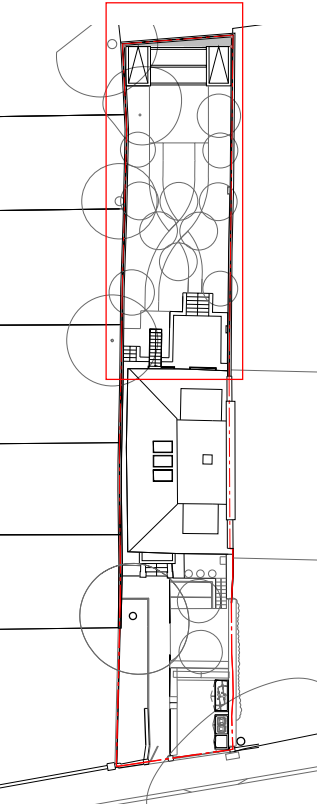

20 Eton Villas

Proposed

097-A-011

Rear Garden Plan	
07.12.2023	1:75 @ A3
KP	RC

HESSELBRAND

© Hesselbrand Ltd. All rights described in Chapter IV of the Copyright, Designs and Patents Act 1988 have been asserted. The drawing is to be read in conjunction with specifications and all relevant drawings. Contractor to check all dimensions on site. Do not scale from this drawing. Hesselbrand Ltd is to be advised of any variation between the drawings and the site conditions.

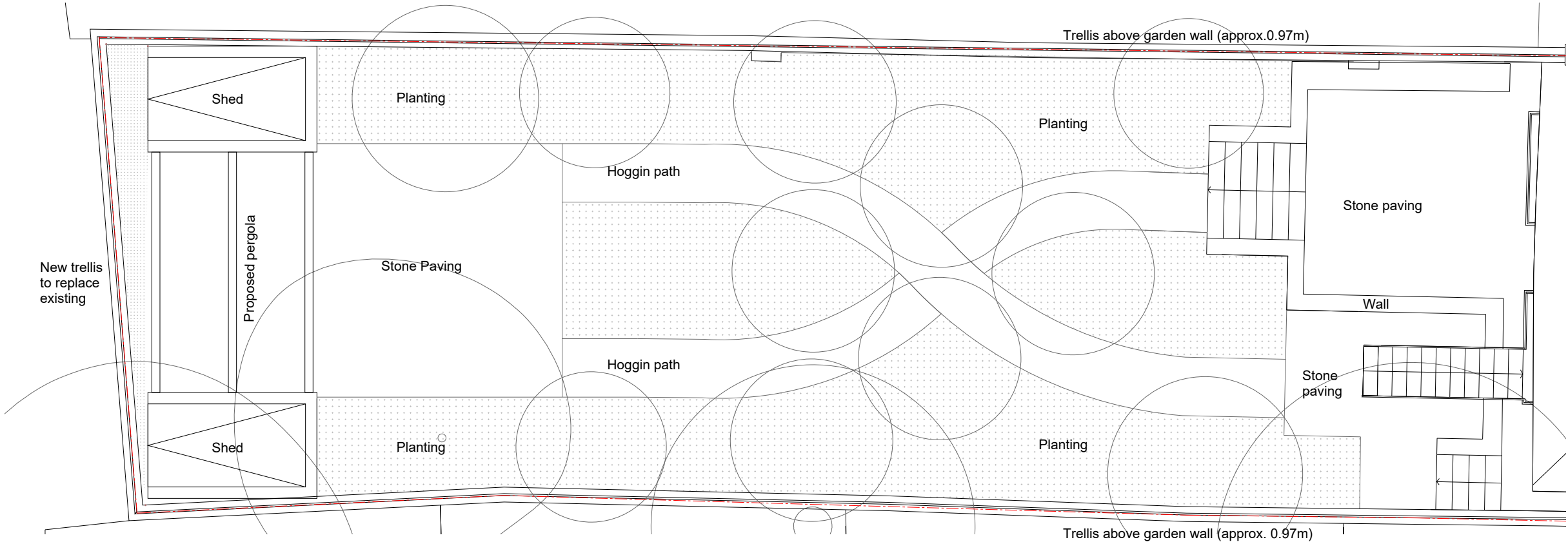

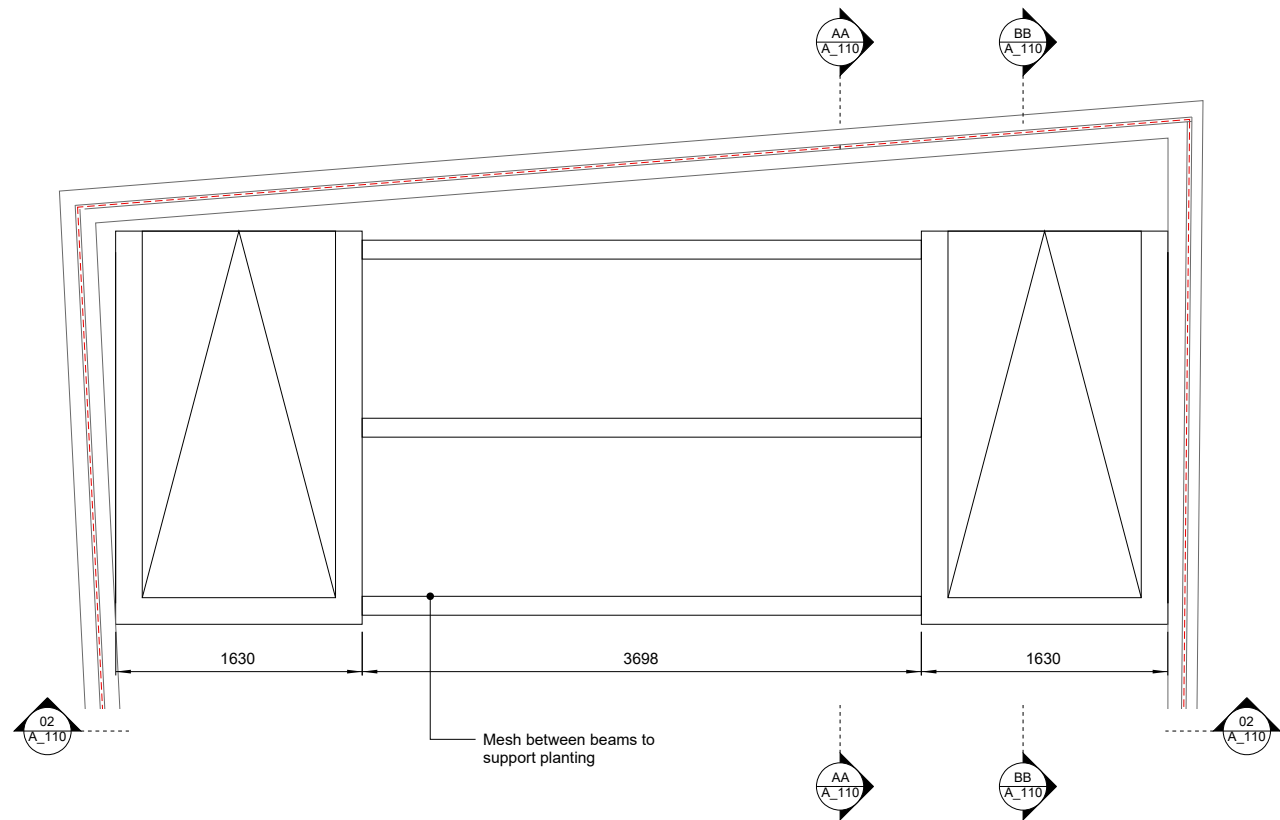

Pergola
1:50 @ A1 / 1:25 @ A3

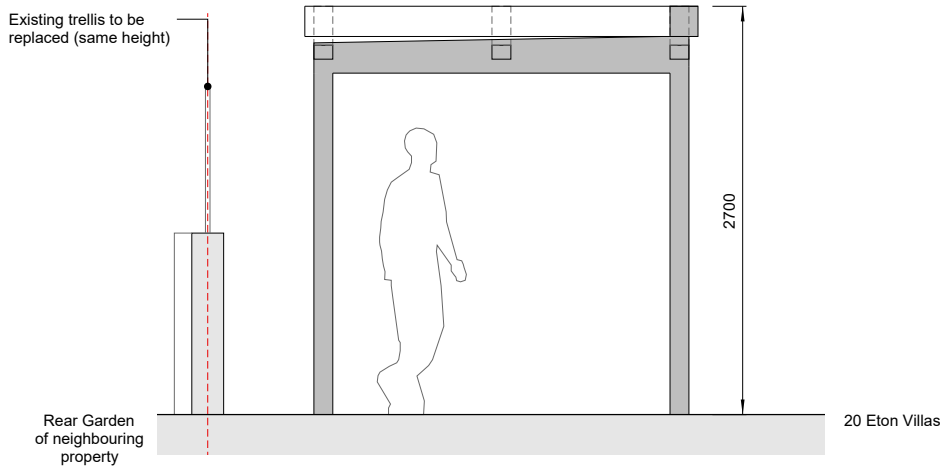

01 Section AA
1:50 @ A1

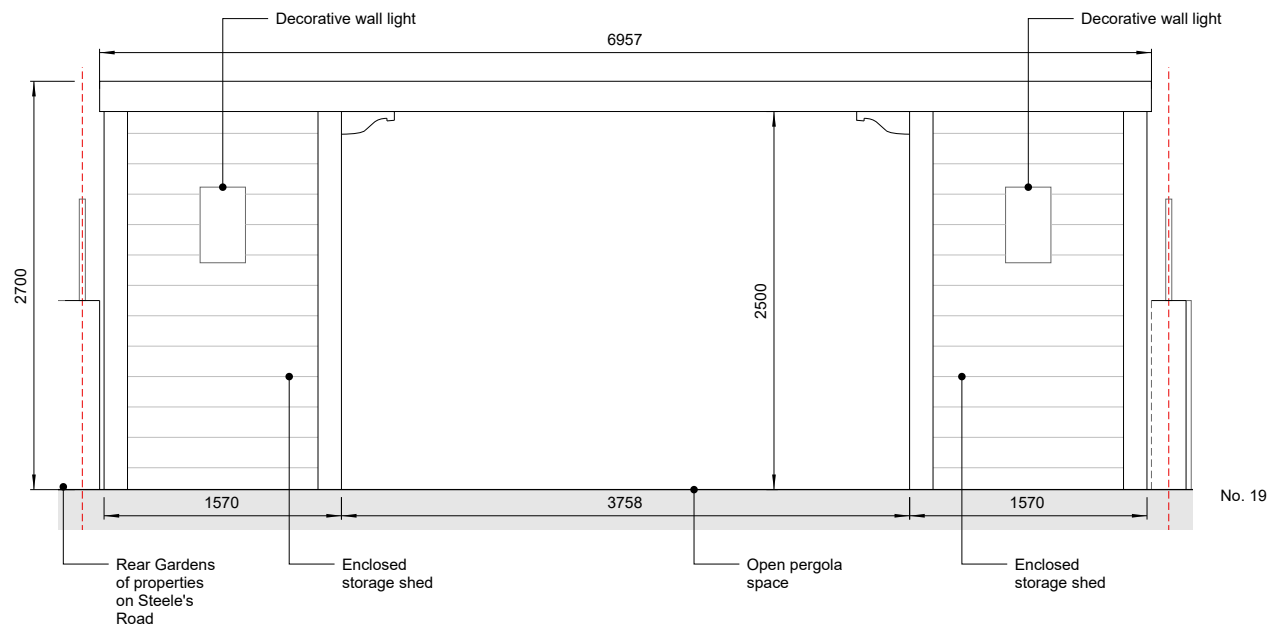

02 Front Elevation
1:50 @ A1

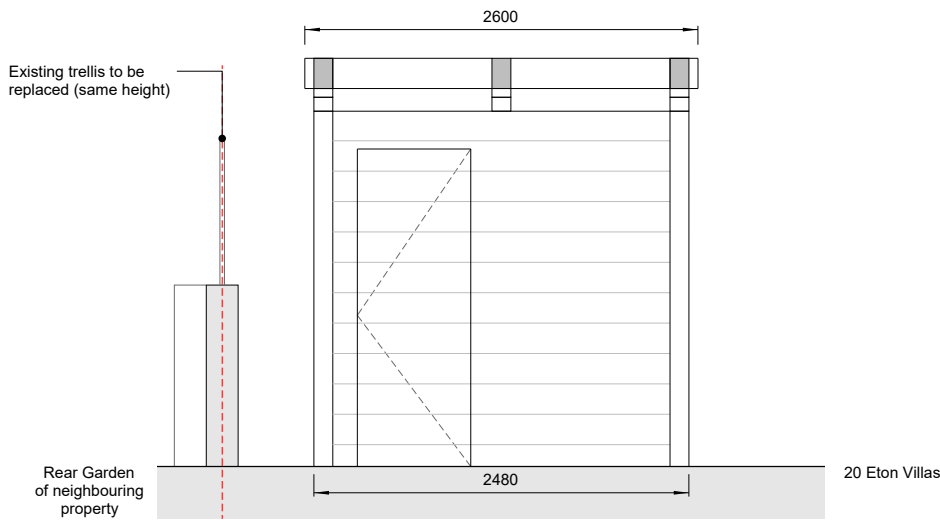

03 Section BB
1:50 @ A1

Issued
V0 07.12.23 Issued for planning

- Notes
- Existing
 - Proposed
 - Site boundary
 - Proposed soft landscaping

0 1m

20 Eton Villas

Proposed

097-A-110

Proposed Pergola

07.12.23 1:100 @ A3

KP RC

HESSELBRAND

© Hesselbrand Ltd. All rights described in Chapter IV of the Copyright, Designs and Patents Act 1988 have been asserted. The drawing is to be read in conjunction with specifications and all relevant drawings. Contractor to check all dimensions on site. Do not scale from this drawing. Hesselbrand Ltd is to be advised of any variation between the drawings and the site conditions.

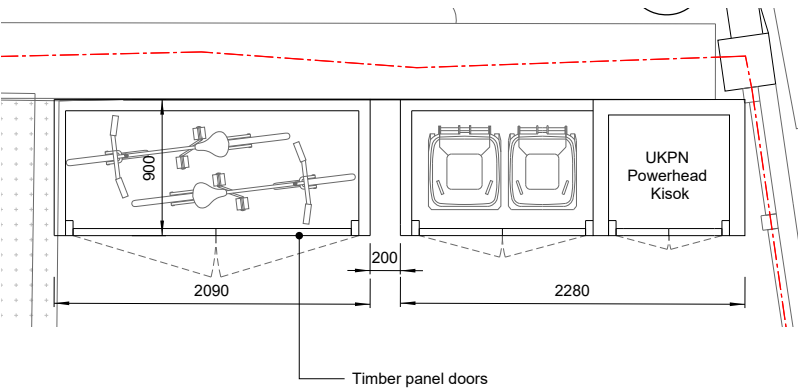

Bin, Bike & Power Store
1:50 @ A1 / 1:25 @ A3

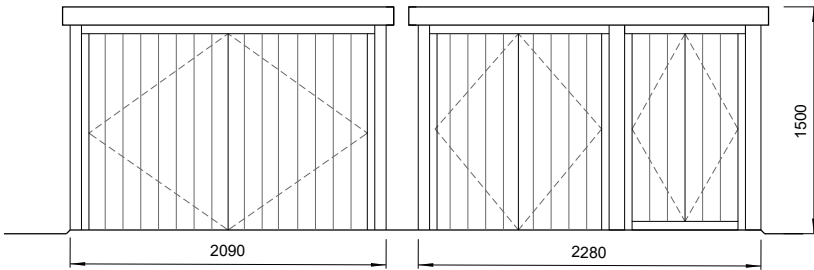
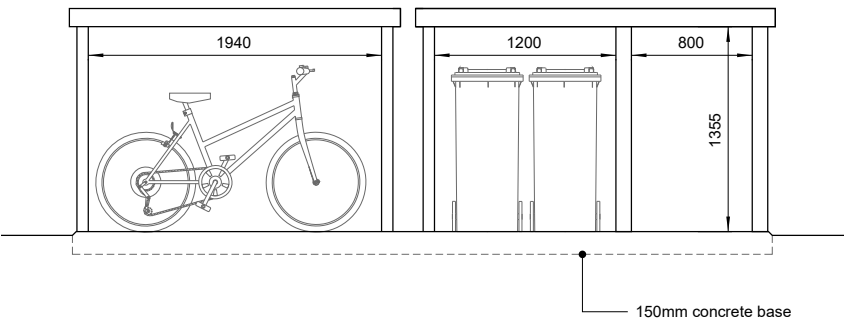

02 Front Elevation
1:20 @ A1

Issued
V0 07.12.23 Issued for planning

- Notes
- Existing
 - Proposed
 - Site boundary
 - Proposed soft landscaping

0 1m

20 Eton Villas

Proposed

097-A-120

Proposed Bin, Bike & UKPN store

07.12.23 1:100 @ A3

KP RC

HESSELBRAND

© Hesselbrand Ltd. All rights described in Chapter IV of the Copyright, Designs and Patents Act 1988 have been asserted. The drawing is to be read in conjunction with specifications and all relevant drawings. Contractor to check all dimensions on site. Do not scale from this drawing. Hesselbrand Ltd is to be advised of any variation between the drawings and the site conditions.

Issued
V0 07.12.23 Issued for planning
V1 17.05.24 Issued for planning
V2 02.07.24 Issued for planning

- Notes
- Existing
 - Proposed
 - Site boundary
 - Proposed soft landscaping



0 1 2 3 4 [m]

20 Eton Villas

Proposed

097-A-305

Street Elevation

02.07.24 1:100 @ A3

KP RC

HESSELBRAND

© Hesselbrand Ltd. All rights described in Chapter IV of the Copyright, Designs and Patents Act 1988 have been asserted. The drawing is to be read in conjunction with specifications and all relevant drawings. Contractor to check all dimensions on site. Do not scale from this drawing. Hesselbrand Ltd is to be advised of any variation between the drawings and the site conditions.