

EXISTING SITE PLAN 1:100 @A1

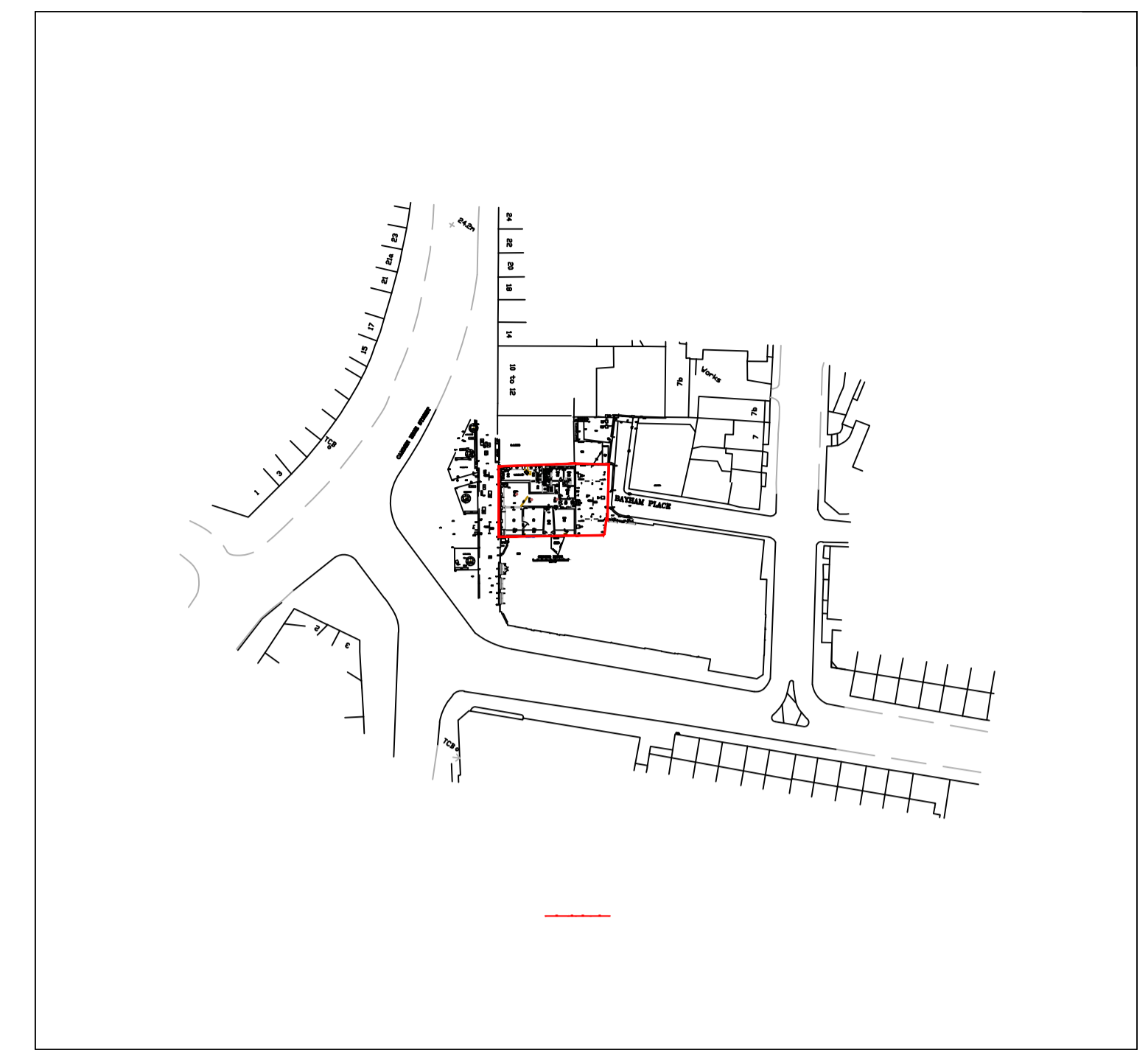

LOCATION PLAN 1:1250 @A1

revision	date	initials	description of amendments
?	??/??/??	??	?
?	??/??/??	??	?

Omnibus, 39-41 North Road, London, N7 9DP Email: info@foundation-architecture.com

Foundation
architecture
ltd.

PROJECT: **2-6 CAMDEN HIGH STREET**
 TITLE: **SITE / LOCATION PLAN EXISTING**
 SCALE: 1:100/1250 @ OCT 2017
 DRAWN: [] CHECKED: []
 NO. 540
E001
 All dimensions to be verified on site.

*Scale is 1:200 at A3