

Motor Output	24V DC
Motor Lines	1
Motor Load	5 Amp / 8 Amp

SCP500/800

Single-zone smoke control unit. Can be linked to a fire alarm or smoke sensor for automatic opening of an AOV smoke vent(s). Manually triggered using manual call points. Facility to link several control units together to form a multi-zone system.



Easy to Configure

System parameters are simple to configure via dip switches - making it easy to program the system logic as per the desired cause and effect.

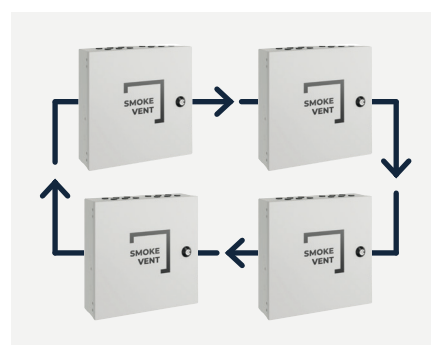

Bus Technology

Using MODBUS technology, multiple SCP500/800 control units can be networked to form larger multi-zone systems. Making it the ideal choice for larger buildings with smoke ventilation shafts and communal smoke corridors.

Certification

Certified and tested in accordance to EN 12101-10

Tested in accordance to prEN 12101-9



Part Codes

SCP-500	SCP500 Control Unit 24V 5 Amp
SCP-800	SCP800 Control Unit 24V 8 Amp

Technical Data

Primary Voltage (Input)	230V AC
Secondary Voltage (Output)	24V DC
Motor Load	5 Amp / 8 Amp
Motor Lines	1
Inputs For	Manual Call Point, Smoke Sensor, Fire Alarm, BMS, Switch, Thermostat, Wind/Rain Sensor
Operating Condition	-5°C - +40°C, max
Battery Backup	72 Hours
Size	365mm (w) x 353mm (h) x 103mm (d)
Protection Type	IP30
Delivery	1 x Control Unit, 2 x Batteries
Battery Size	2 x 12v 7Ah
Certification	EN 12101-10

SCP500/800

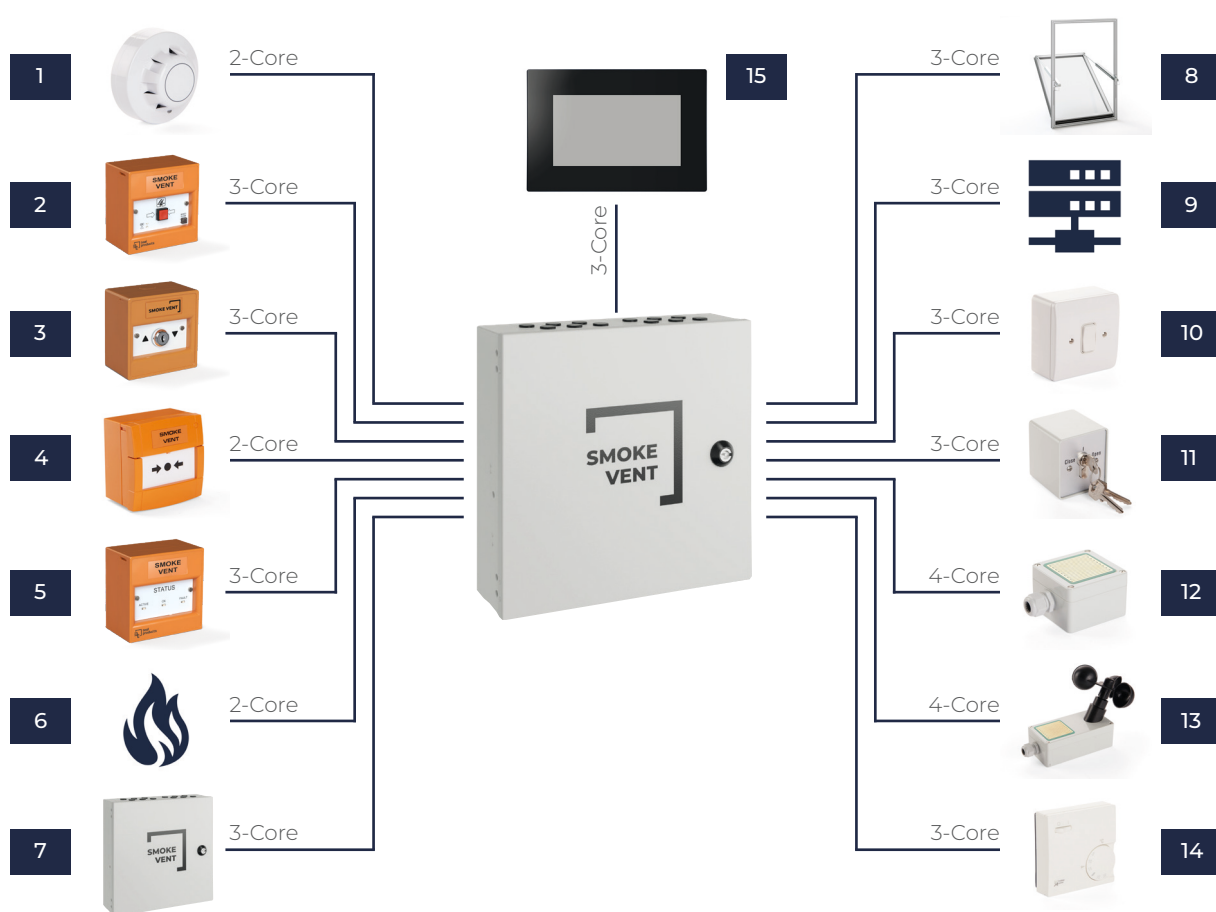

Key

1	SSR-D Smoke Sensor
2	BG3/FOS Override Switch
3	BG2/FOS Override Key-Switch
4	BG1/S Breakglass Call Point
5	WSC MP2 LED Indicator
6	Fire Alarm Signal (NO/C)
7	SCP500/800 (Network)

8	24V DC Smoke Vent
9	BMS with MODBUS
10	S50 Rocker Switch
11	RRTKEY Key Switch
12	WLA 331 Rain Sensor
13	WLA 330 Wind & Rain Sensor
14	WLA 110 Thermostat
15	HMI-SCP Touchscreen User Interface 16-Zone

The SCP500/800 single-zone control unit is perfect for stairwell applications with a single AOV.

Using MODBUS technology, multiple SCP500/800's can be networked to form larger multizone systems. Making it the ideal choice for larger buildings with smoke ventilation shafts and communal smoke corridors.

The SCP500/800 can also be linked to BMS systems running MODBUS. This can then allow more complex cause and effect strategies to be implemented and controlled from a 3rd party BMS system. Advanced users are no longer locked into 'standard' functionality and can enjoy the flexibility to control any element of any SCP as they choose.

Wiring Schematic

