

2 Proposed Ground Floor Plan
Scale: 1:50

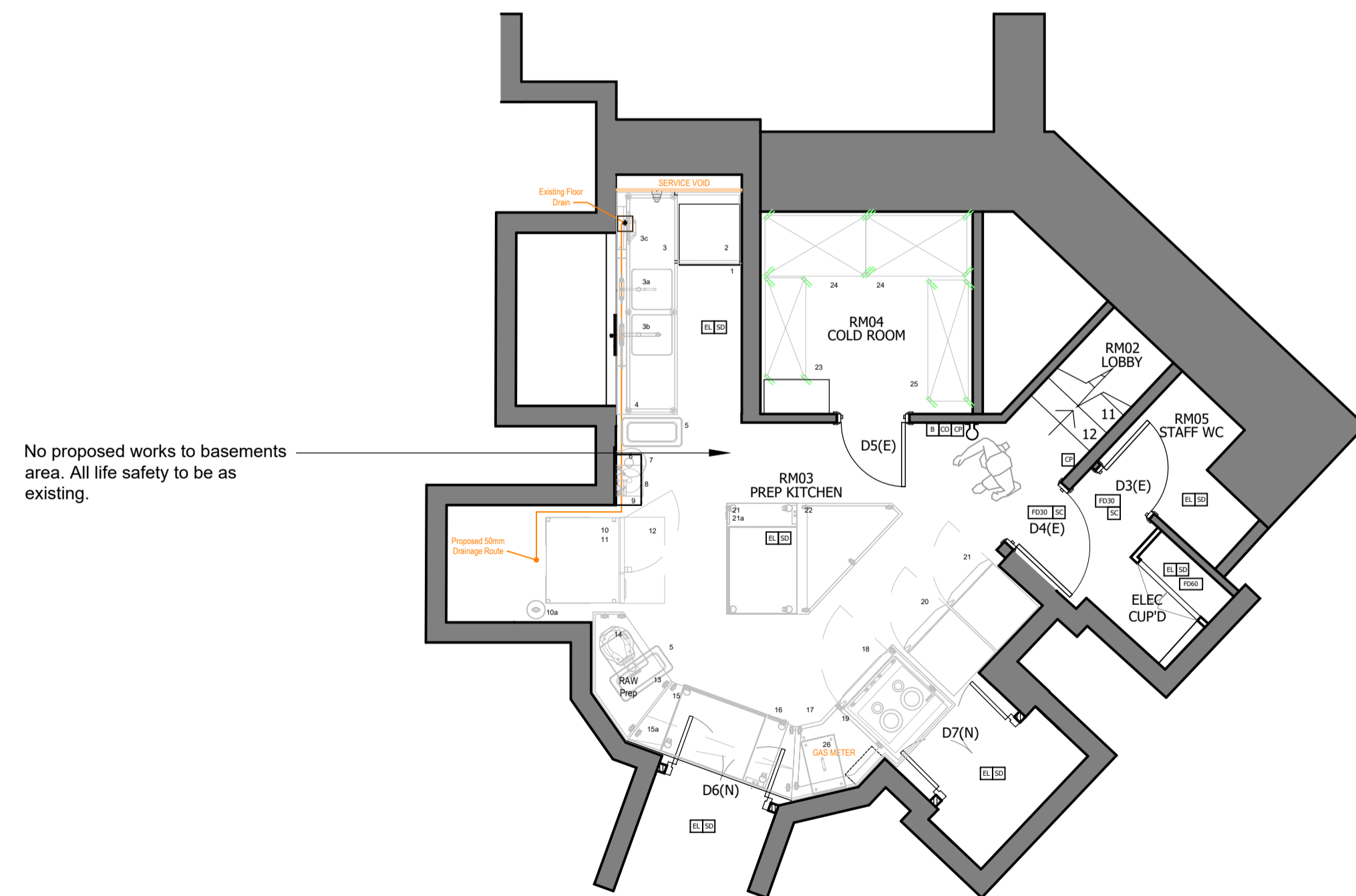

1 Proposed Basement Plan
Scale: 1:50

FIRE DETECTION SYSTEM SYMBOLS	
EL	Maintained Emergency Light
EIS	Illuminated exit sign over door
SD	Ceiling Mounted Smoke Detector
SD	Ceiling mounted Heat Detector
FDS	Fire Door keep clear sign located on direction of opening side door
FDL	Keep Door Locked sign located on direction of opening side door
B	Wall mounted Fire blanket in container
CO	2Kg wall mounted Carbon Dioxide Fire Extinguisher
W	9 litre wall mounted water fire extinguisher
CP	Manual Fire alarm call point location
FD30	Half hour fire door including intumescent smoke seal strips and positive overhead door closures, fire stops and sign
FD60	One hour fire door including intumescent smoke seal strips and positive overhead door closures, fire stops and sign
☉	Visible Fire Alarm warning beacon
🔔	Fire alarm sounder
SC	Positive overhead door closures
PP	Emergency door push pad or bar & sign
FES	Emergency exit sign indicating direction of means of escape
VP	Vision panel in door comprising FR glass and HW beads in intumescent paste Minimum size of vision panel 250mm dia.

KEY NOTES

- GLAZING**
All front of house glazing and mirrors are to comply with BS 6262-4:2005 / BR Approved Document K: 2013 ie. 12mm laminated or toughened, or as specified.
- FABRICS**
Any upholstery fabrics and foam must be treated to crib 5 or Source 5 certification and BS 7176: 2007 and BS 5852:2006
- TOILETS**
The toilets are designed in accordance with BS 6465-1:2006+A1:2009, and BS 6465 2: 2017
- DOORS**
All fire doors are to meet British Standards including BS 8214: 2016 Timber-based fire door assemblies

KEY FIRE DETECTION / PROTECTION NOTES

- An automatic fire detection system is to be installed throughout the demise in accordance with BS 5839-1:2017 - Fire detection and fire alarm systems for buildings. Code of practice for design, installation, commissioning and maintenance of systems in non-domestic premises or BS 5839-8:2013 Fire detection and fire alarm systems for buildings. Code of practice for the design, installation, commissioning and maintenance of voice alarm systems
- The life systems designer / contractor is to ensure strict compliance to local and national criteria at the design stage. the keys and symbols on this layout should be noted and modified if required.
- The fire alarm system is to be linked, where necessary, to the main landlord system. The contractor is to ensure the integration of the 2 systems is achieved to the satisfaction of the Landlord and Building Control.

AREAS

1	Total Area Of Demise	66 sqm
4	FOH service area and seating	12 sqm
5	BOH staff and kitchen area	54 sqm

OCCUPANCY LEVELS

8	Internal occupancy standing or queuing	15
11	Staff occupancy	10
12	The minimum clear width required for under 60 people	750mm

RED OUTLINE AREA FOR THE SALE OF ALCOHOL AND THE PROVISION OF LATE NIGHT REFRESHMENT

THE LOCATION AND TYPE OF ANY FIRE SAFETY AND ANY OTHER SAFETY EQUIPMENT IS SHOWN AS "PROPOSED". THIS MAY BE VARIED FROM TIME TO TIME WITH THE AGREEMENT OF THE FIRE OFFICER OR AFTER FIRE RISK ASSESSMENT

ANYTHING SHOWN ON THIS PLAN, WHICH IS NOT REQUIRED BY THE PLANS REGULATIONS FOR THE LICENSING ACT 2003 IS FOR ILLUSTRATIVE PURPOSES ONLY AND DOES NOT FORM PART OF THE LICENSE.

GENERAL NOTES

- All finishes are to conform to the required current Building Codes & Regulations in the applicable country.
- The Contractor must verify all site dimensions, drawings, details and specifications and report any discrepancies to DesignLSM before proceeding with any work.
- The contractor is to conform to the DesignLSM project preliminaries & scope of works document.
- All requested drawings showing fixings and construction details are required to be approved by DesignLSM prior to commencement of work.
- All specified items are to be installed in accordance with the manufacturers recommendations on a suitable substrate.
- The Contractor is to provide a safe and suitable working environment which conforms to the current Health and Safety and Local Authority regulations.
- All finishes are to be implemented to a high quality.
- Any dimensions are to be taken from the setting out plan only and are not to be scaled from the drawings.
- It is the contractors responsibility to ensure that any building works are carried out in accordance with current Building Regulations and Local Authority requirements.
- The contractor is to check and appraise all design and construction details and offer alternatives, as appropriate, to implement the design.
- In the event that there is a conflict in information, the Contractor is to highlight the discrepancies to the designer / Contract Administrator.
- This drawing is to read in conjunction with the other relevant drawings, specifications, schedules and co-consultants information.
- Copyright of DesignLSM and is not to be reproduced without permission.

Rev	Date	Item
REV D	13.08.19	Updated as licensing requirements
REV C	09.07.19	Updated for construction issue
Rev	Date	Item

- Information only
- Application for Local Authority
- Tender
- Construction
- As built

PROJECT

Fafa's

TITLE

Proposed Licensing Plans

DRAWN	DATE	SCALE	CHECKED
JB	05.19	1:50@A1	

PROJECT No.	DWG No.	REVISION
02301	08-01	D

DESIGNLSM

+44 (0)1273 820 033
hello@designlsm.com
designlsm.com

93 Islingword Road,
Brighton, East Sussex.
UK BN2 9SJ