

EXISTING LOWER GROUND FLOOR PLAN

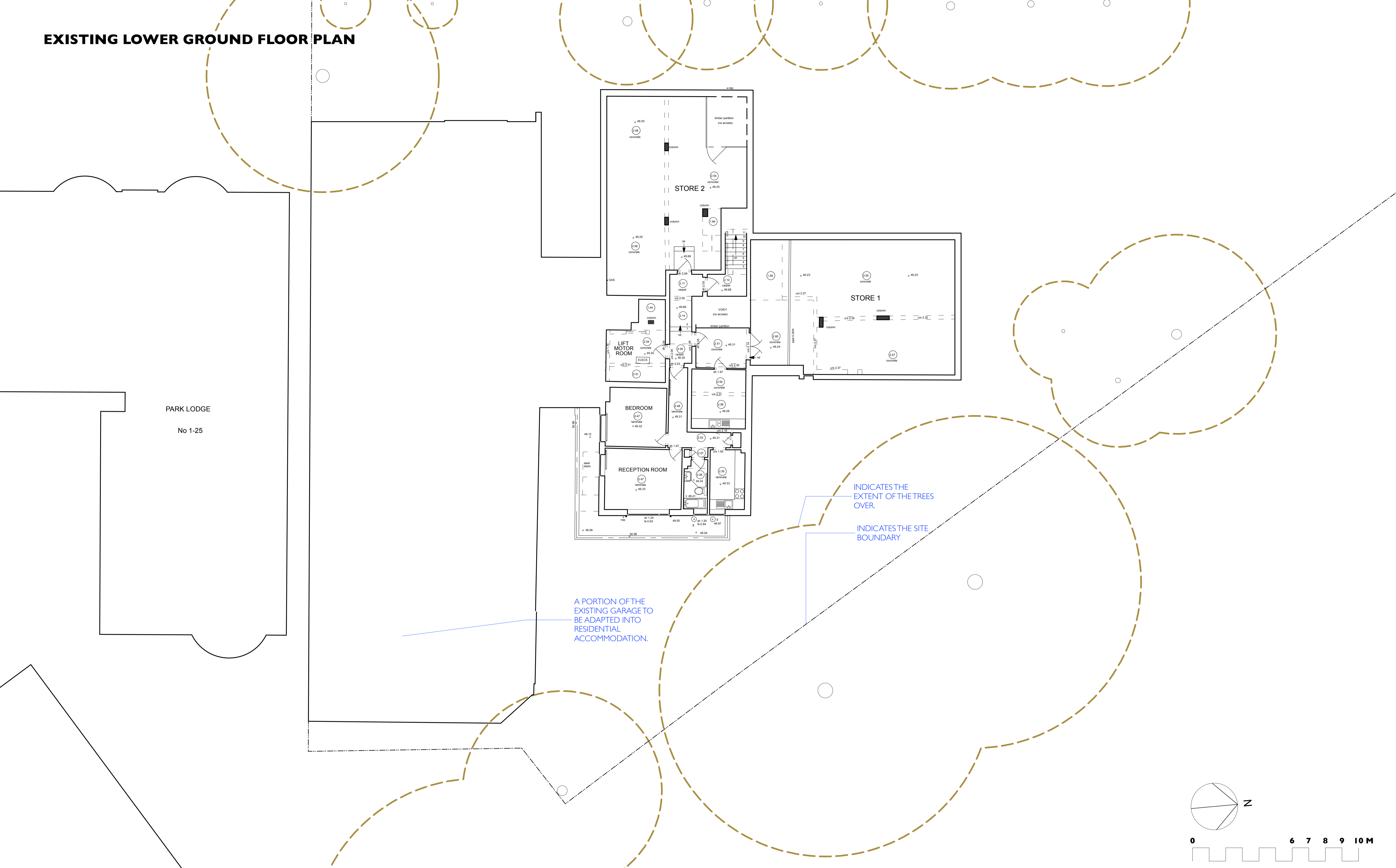

PARK LODGE
No 1-25

A PORTION OF THE
EXISTING GARAGE TO
BE ADAPTED INTO
RESIDENTIAL
ACCOMMODATION.

INDICATES THE
EXTENT OF THE TREES
OVER.

INDICATES THE SITE
BOUNDARY

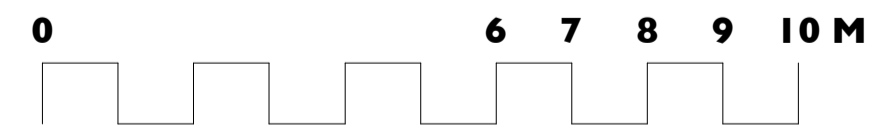
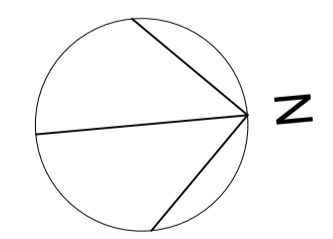

Unit 25, BASEPOINT
EVESHAM
WORCESTERSHIRE
WR11 1GP
t : 020 7328 2576
Email: info@hubarchitects.co.uk

All dimensions are to be checked on site before commencement of works.
All sizes and dimensions to any structural elements are indicative only. See structural engineer's drawings for actual sizes/dimensions.
Sizes of and dimensions to any service elements are indicative only. See service engineer's drawings for actual sizes/dimensions.
This drawing to be read in conjunction with all relevant Architect's drawings, specifications and other consultants' information.

Rev.	Date.	Description.	Initial.

EXISTING

Project: 95 Avenue Road, London, NW8 6HY	Drawing: Existing Lower Ground Floor Plan
Scale: 1:100 @ A3 & 1:200 @ A3	DWG: 1289 - EX - PP3 - 003
Date: Jan 2021	Revision: /