

PROPOSED LOWER GROUND FLOOR PLAN

- House 1
- House 2
- New Walls

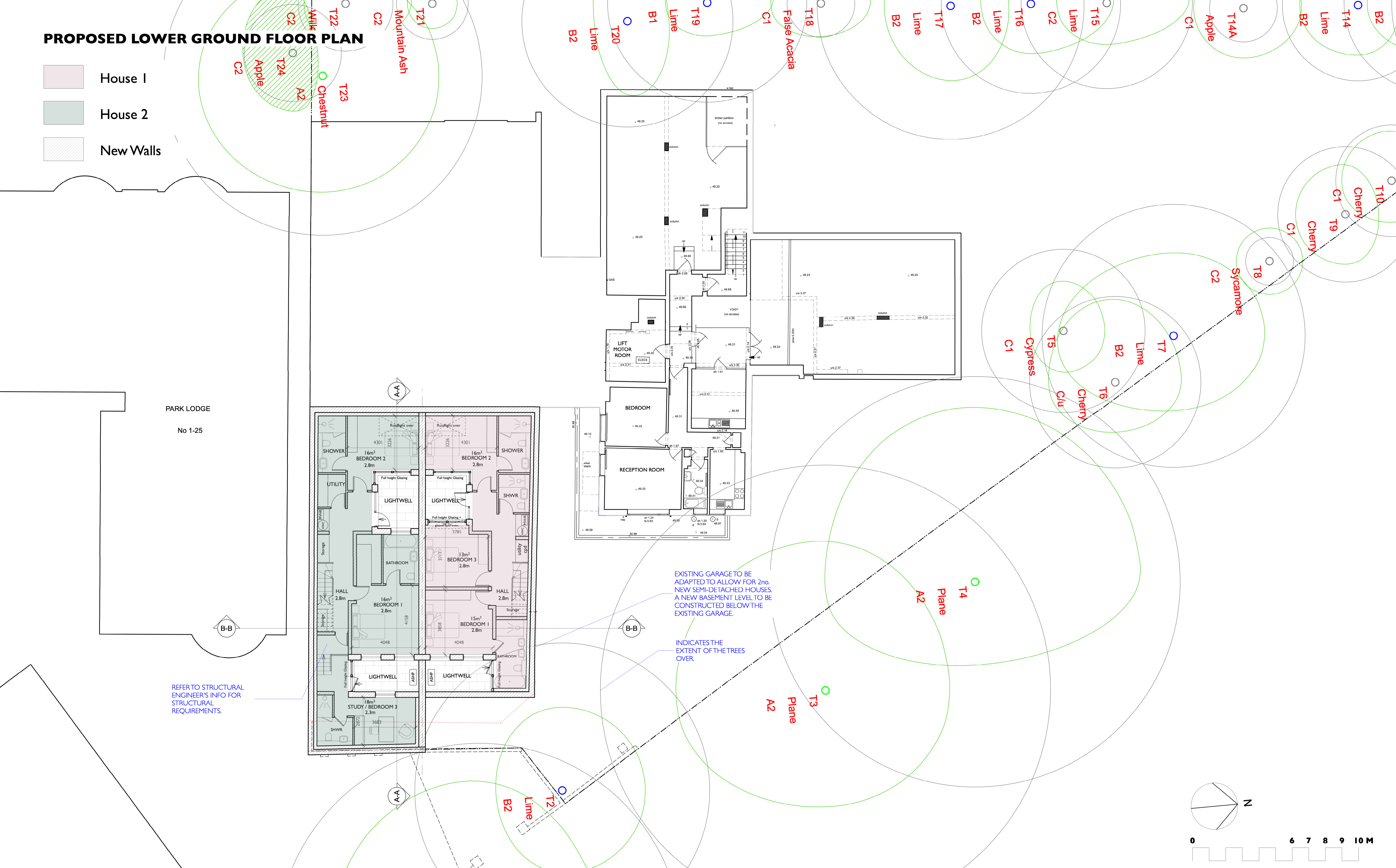

PARK LODGE
No 1-25

REFER TO STRUCTURAL ENGINEER'S INFO FOR STRUCTURAL REQUIREMENTS.

EXISTING GARAGE TO BE ADAPTED TO ALLOW FOR 2no. NEW SEMI-DETACHED HOUSES. A NEW BASEMENT LEVEL TO BE CONSTRUCTED BELOW THE EXISTING GARAGE.

INDICATES THE EXTENT OF THE TREES OVER.

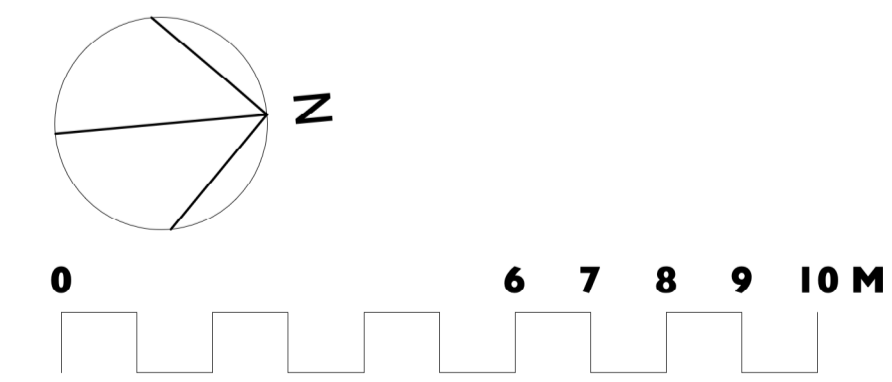

Unit 25, BASEPOINT
EVESHAM
WORCESTERSHIRE
WR11 1GP
t : 020 7328 2576
Email: info@hubarchitects.co.uk

All dimensions are to be checked on site before commencement of works.
All sizes and dimensions to any structural elements are indicative only. See structural engineer's drawings for actual sizes/dimensions.
Sizes of and dimensions to any service elements are indicative only. See service engineer's drawings for actual sizes/dimensions.
This drawing to be read in conjunction with all relevant Architect's drawings, specifications and other consultants' information.

Rev.	Date.	Description.
C	2206-16	General drawing update, H1 updated.
D	2208-09	General drawing update, Landmark Trees RPA info added.
E	2301-05	General drawing update following receipt of structural info.
F	2305-03	General drawing update H1 Bed 3 glazed roof/window.
G	2401-08	General drawing update, services coordination.

Initial.
JC
JC
JC
JC
JC
JC

PLANNING

Project: 95 Avenue Road, London, NW8 6HY	Drawing: Proposed Lower Ground Floor Plan
Scale: 1:100 @ A3 & 1:200 @ A3	DWG: 1289 - PP3 - 203
Date: Jan 2021	Revision: G