

**EXISTING WEST ELEVATION**

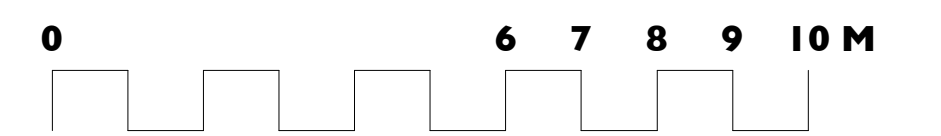
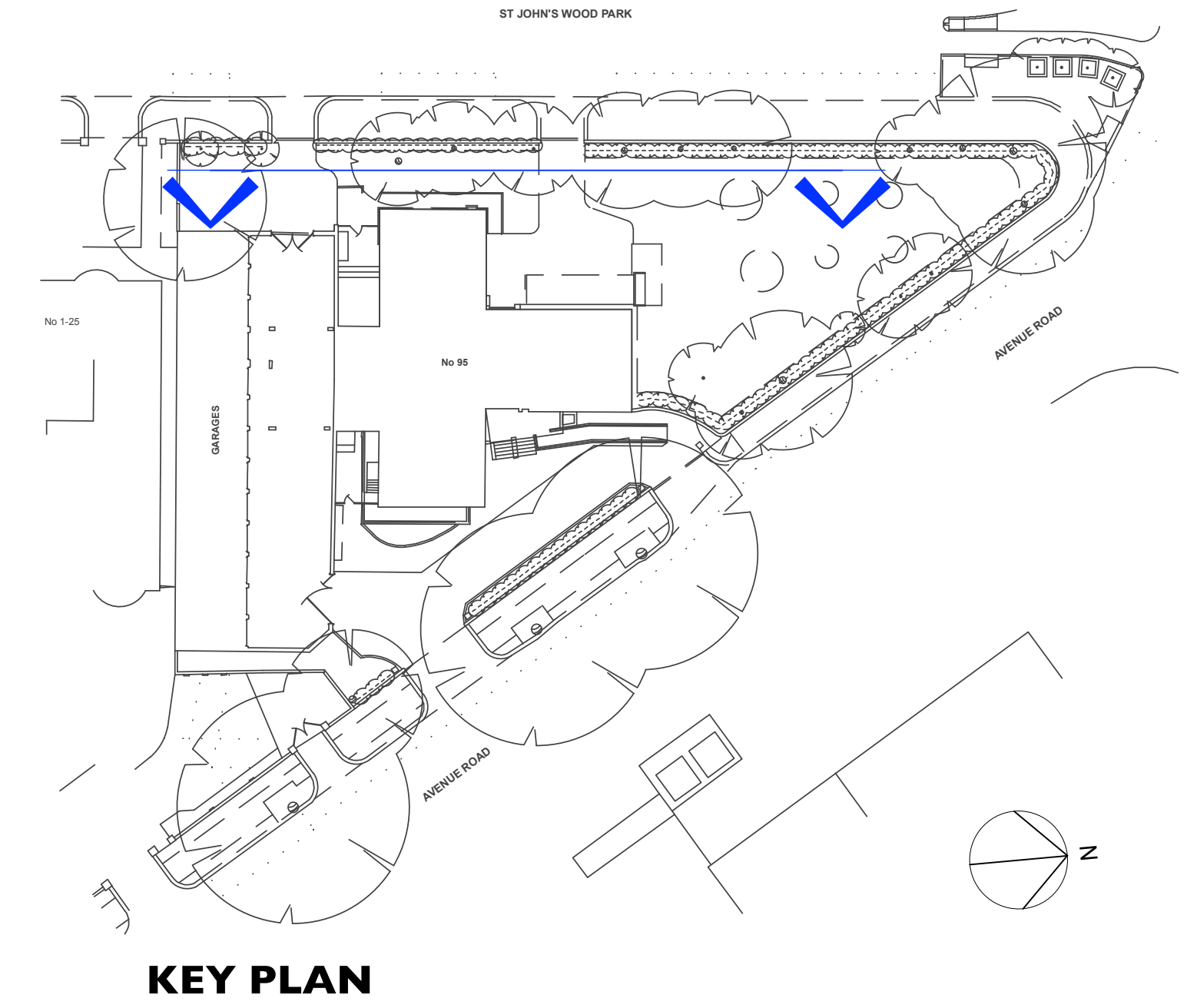

Unit 25, BASEPOINT  
EVESHAM  
WORCESTERSHIRE  
WR11 1GP  
t : 020 7328 2576  
Email: info@hubarchitects.co.uk

All dimensions are to be checked on site before commencement of works.  
All sizes and dimensions to any structural elements are indicative only. See structural engineer's drawings for actual sizes/dimensions.  
Sizes of and dimensions to any service elements are indicative only. See service engineer's drawings for actual sizes/dimensions.  
This drawing to be read in conjunction with all relevant Architect's drawings, specifications and other consultants' information.

Rev.	Date.	Description.	Initial.

<b>EXISTING</b>	
Project: 95 Avenue Road, London, NW8 6HY	Drawing: Existing West Elevation
Scale: 1:100 @ A1 & 1:200 @ A3	DWG: 1289 - EX - PP2 - 023
Date: Jan 2021	Revision: /