

# EXISTING GROUND FLOOR PLAN

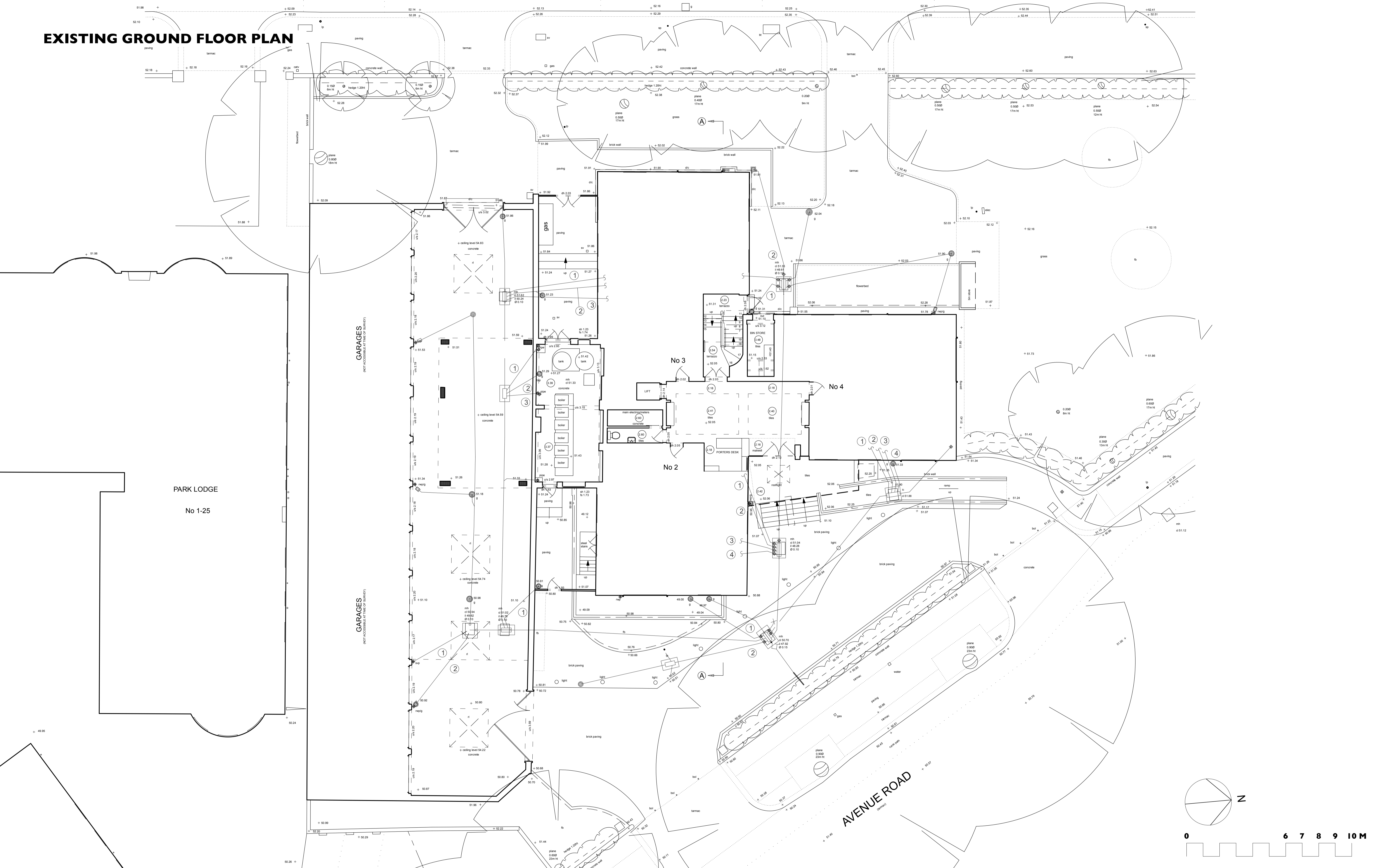

Unit 25, BASEPOINT  
EVESHAM  
WORCESTERSHIRE  
WR11 1GP  
t : 020 7328 2576  
Email: info@hubarchitects.co.uk

All dimensions are to be checked on site before commencement of works.  
All sizes and dimensions to any structural elements are indicative only. See structural engineer's drawings for actual sizes/dimensions.  
Sizes of and dimensions to any service elements are indicative only. See service engineer's drawings for actual sizes/dimensions.  
This drawing to be read in conjunction with all relevant Architect's drawings, specifications and other consultants' information.

Rev. A  
Date. 2211-01

Description.  
General drawing update.

Initial.  
JC

## EXISTING

Project: 95 Avenue Road, London, NW8 6HY

Drawing: Existing Ground Floor Plan

Scale: 1:100 @ A1 & 1:200 @ A3

DWG: 1289 - EX - PP2 - 004

Date: Jan 2021

Revision: **A**