



Do not scale. All dimensions to be confirmed on site. Information contained in this drawing is the sole copyright of Orms designers + architects ltd and is not to be reproduced without permission.

The setting out and dimensions of any existing building elements shown are based on collated archive information, measured surveys and site investigations as available. If there is any reasonable doubt in relation to position of existing building fabric which affects costs or final construction details the contractor should undertake relevant surveys to verify the information, and any changes discovered should be notified to the architect.

This drawing should be read in conjunction with all other project information prepared by Orms and design consultants. In the event of any conflicts between information on this drawing and other project information that may be contained on models, specifications, schedules, etc. seek clarification with Orms.

Please note that dwg or other cad formats provided in addition to pdf documentation are issued to aid co-ordination only. Use of written dimensions and levels is permitted, but all other dimensions extracted from the digital content are not to be relied upon. Data should always be checked against pdf information.

Drawings issued with construction record status or revision are not surveys and are to be verified on site prior to making any use of them. Orms do not take responsibility for any discrepancies between the drawings and actual as build condition.

#### Key Plan

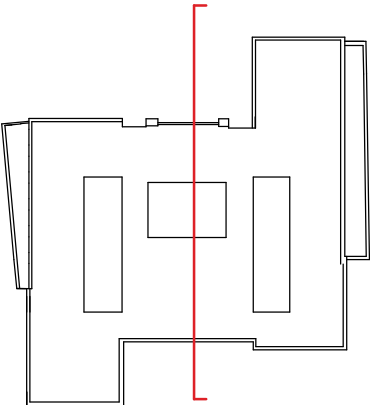

#### Notes

01	New textured stone facade with reused stone
02	New stone coping
03	New metal balustrading
04	New double glazed windows with side vents
05	New planters
07	Existing metal cladding refurbished and cleaned
09	New low profile photovoltaics
10	New double glazed automatic sliding door
11	Existing stone cladding refurbished and cleaned
12	New double glazed curtain walling with pivot doors
13	New metal stair with bike channel
14	New glazed block facade with feature metal framing
15	Existing granite cladding refurbished and cleaned
16	New metal gate with control panel
17	New chrome finish metal clad column
18	New double glazed window in curtain walling
19	New feature stone coping
20	New stone cornice

C01	24.06.24	Planning
Rev.	YY.MM.DD	Description
Checked byGMH Approved by SH		
Status code		
A2 - AUTHORISED AND ACCEPTED		
Status description		
PLANNING		

**Orms**

1 Olver's Yard  
55-71 City Road  
London  
EC1Y 1HQ  
0207 833 8533  
orms@orms.co.uk  
orms.co.uk

Project		
124 Theobalds Road		
Drawing title		
Proposed		
Planning		
Section AA		
Scale@A1	Scale @A3	Project No.
1 : 100	1 : 200	2289
Drawing Number		
Project	Originator	Zone Location Type Role Number
THR - ORM - ZZ - AA - DR - A - 12401		C01

124 Theobalds Road / Mercury House

Extent of Planning Application

