

Existing Block Plan 1:500

Existing outbuilding at
10A Quex Road •

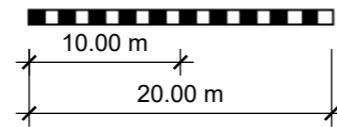

Proposed Block Plan 1:500

Proposed Outbuilding
with roof overhang

Connection to existing
mains sewer via
manhole

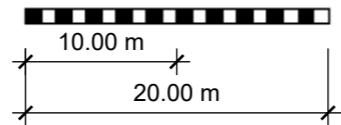

R L Planning

36A Birchington Road, Camden NW6 4LJ

FOR PLANNING PURPOSES ONLY
Crown copyright and database rights OS 100042766

ISSUE
20.06.24

PROJECT NO.
20.93

Proposed Block Plan
1:500 @ A3

**SHEET
NO. 02B**

Changes to scale
and design

Proposed Site Layout Plan 1:100

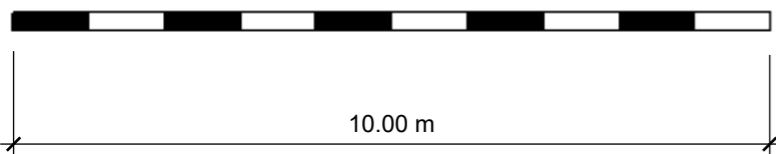
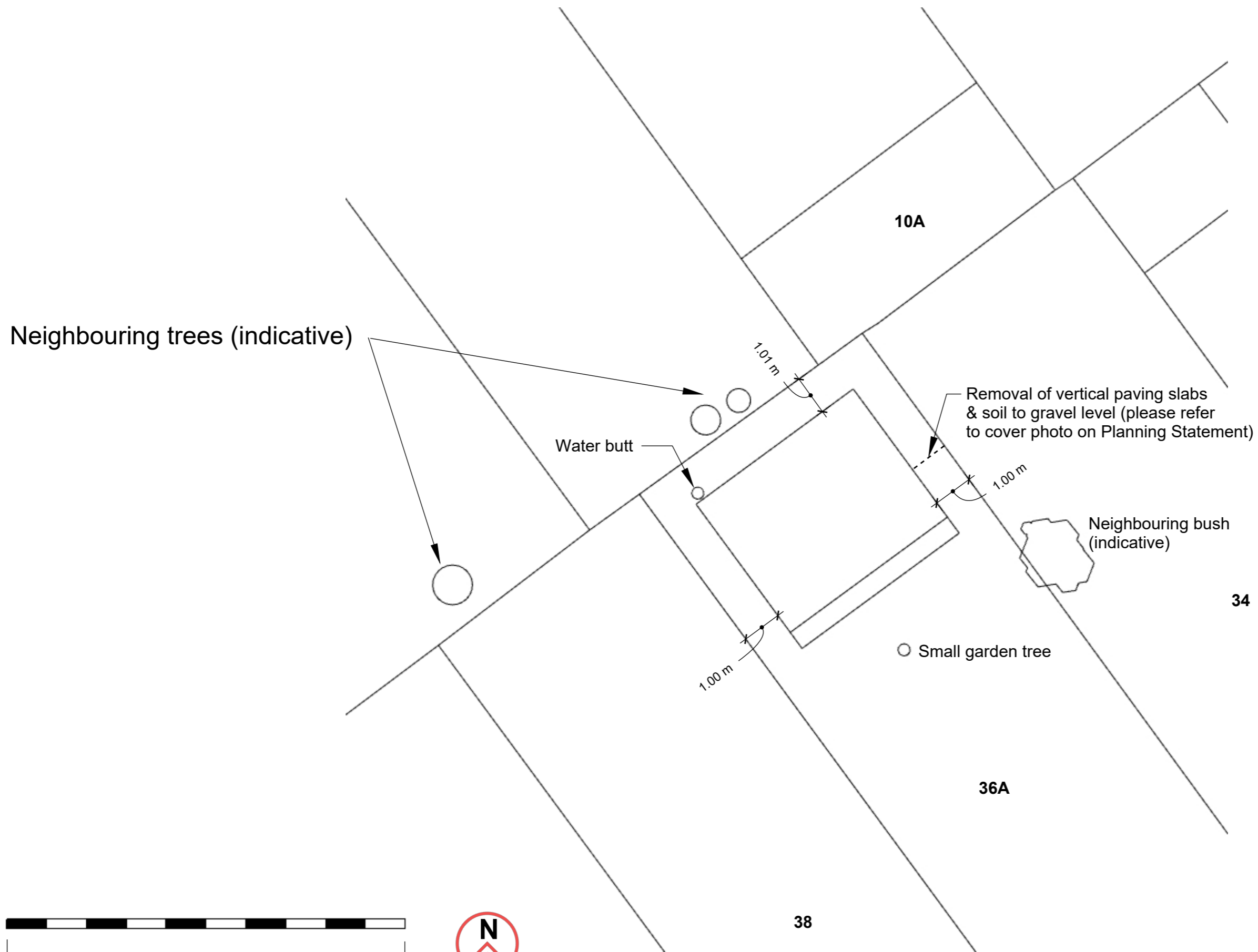

R L Planning

36A Birchington Road, Camden NW6 4LJ

FOR PLANNING PURPOSES ONLY
Crown copyright and database rights OS 100042766

ISSUE
20.06.24

PROJECT NO.
20.93

Proposed Site Layout
Plan 1:100 @ A3

**SHEET
NO. 03B**

Changes to scale
and design