

# Tree Protection Plan

This drawing must be read in conjunction with the *Arboricultural Method Statement* (document AMS 7628).

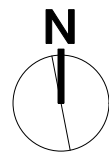
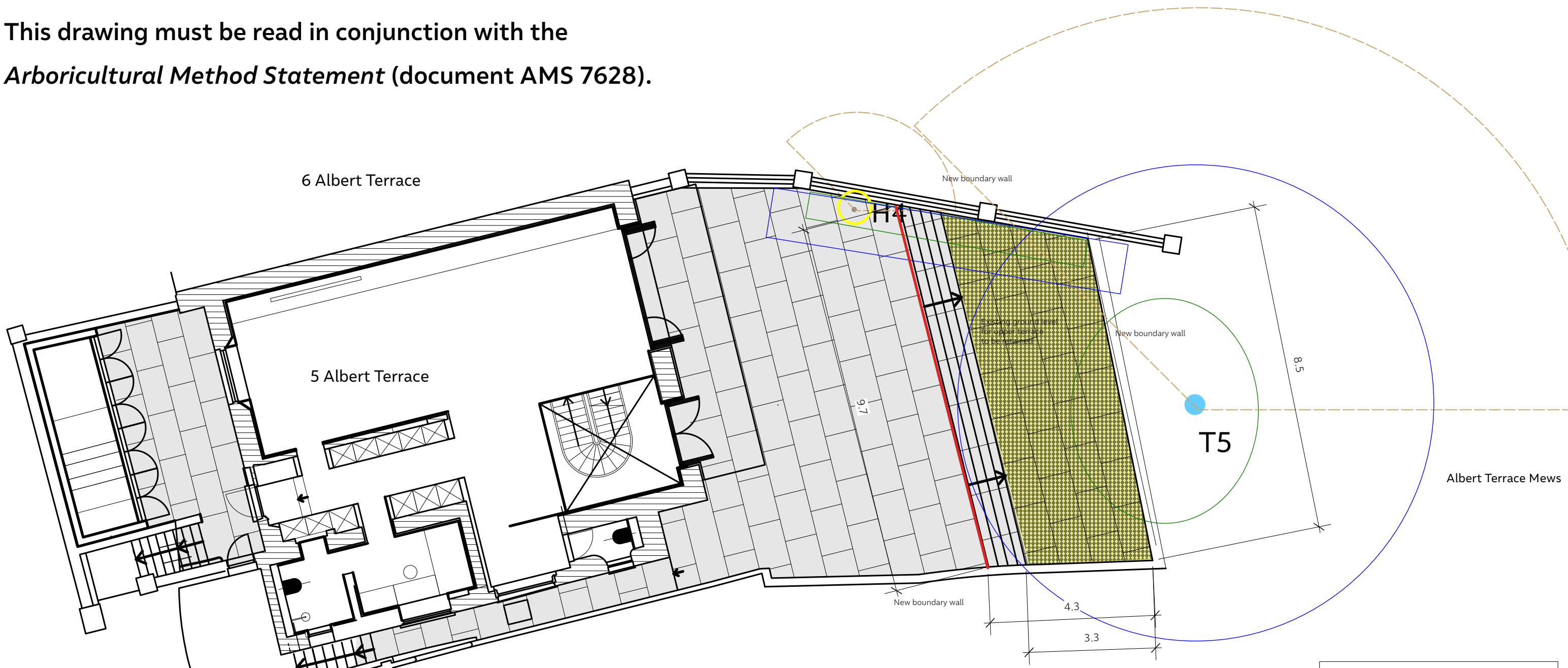

Trees	Construction constraints	Tree protection measures
<ul style="list-style-type: none"> <li>Representational tree trunks</li> <li>Category A: high quality (Green dot)</li> <li>Category B: moderate quality (Blue dot)</li> <li>Category C: low quality or young tree (Grey dot)</li> <li>Category U: unsuitable for retention regardless of the development proposal. (Red dot)</li> </ul>	<ul style="list-style-type: none"> <li>Indicative crown spread (Green circle)</li> <li>Minimum root protection area (Blue circle)</li> <li>Shading by trees (Orange dashed line)</li> </ul>	<ul style="list-style-type: none"> <li>Protective fencing: see AMS 7628 paragraphs 6.1 to 6.6. (Red line)</li> <li>Temporary ground protection: see AMS 7628 paragraphs 11.2 to 11.4. (Green hatched area)</li> </ul>
<ul style="list-style-type: none"> <li>Tree removal</li> <li>Trees to be removed for development (Yellow circle)</li> </ul>	<ul style="list-style-type: none"> <li>Hard landscaping</li> <li>Paving (Grey hatched area)</li> </ul>	

**The Tree Bureau**  
 Old Warwick Studio  
 2a Warwick Road  
 St Albans, Herts AL1 4DL  
 01727 855006  
 info@thetreebureau.co.uk

---

Title: Tree Protection Plan  
 Reference: TPP 7628  
 Site: 5 Albert Terrace, London NW1 7SU  
 Scale: 1:100 @ A3  
 Client: Lawrence Salem  
 Date: 24 05 24

This drawing is in colour and is based, with permission, on supplied drawings. For all non-arboricultural detail, please refer to the appropriate specialists' drawing. Do not scale from this drawing.  
 © The Tree Bureau 2024