

TRADITIONAL SASH WINDOWS ON WEIGHTS & CORDS 150

STANDARD EQUIPMENT

CONSTRUCTION	box thickness: 150mm • leaf thickness: 53mm hardwood threshold: 58mm
OPENING TYPES	top & bottom sash sliding • one sash sliding, one sash fixed,
HARDWARE SYSTEM	pulleys • fitch fasteners • lifts, rings
GLAZING	Standard: double glazed unit 24mm • $U_w=1,1$ Option: double glazed unit 20mm • $U_w=1,3$
TIMBER	high quality multilayer timber • softwood • hardwood
SURFACE COATING	micro porous paint or stain coating system • 4-coat painting system
WEATHERSEALS	Q-Lon Schlegel.
HORNS	external decorative horns
THRESHOLD	58mm thick hardwood threshold

STANDARD EQUIPMENT



OPTIONAL EQUIPMENT



head drip • internal window boards • external cills • internal horns • top lintel arched • flush trickle vent • astragal & structural bars • leads • ornamental & stained glass • toughened & laminated glass • & more...

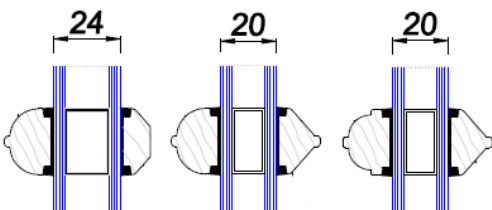

Przek. B-B

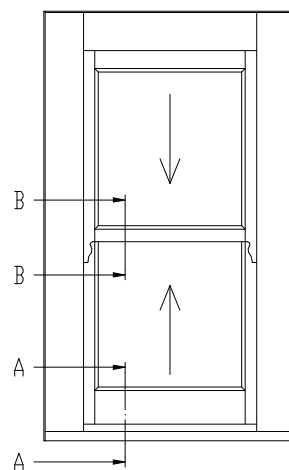
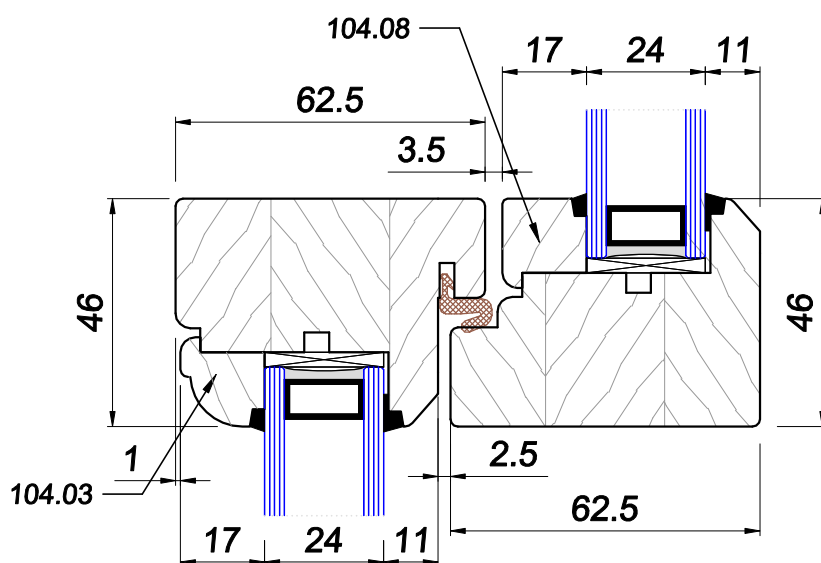

Przek. A-A

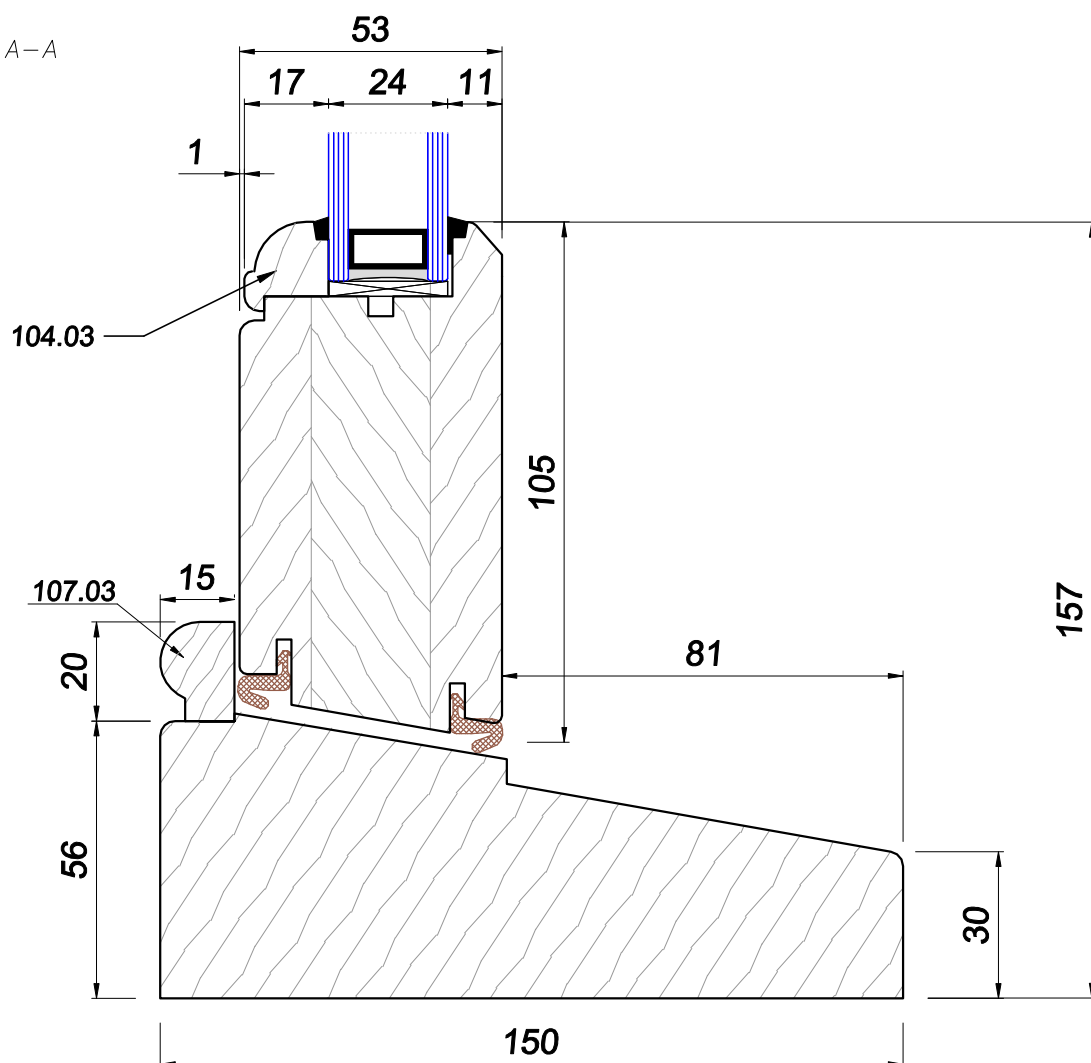

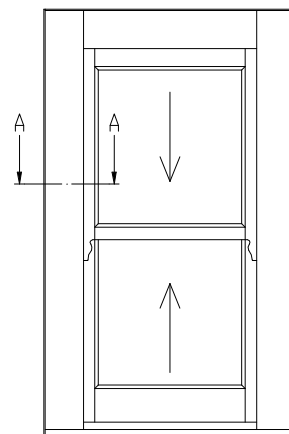

Przek. A-A

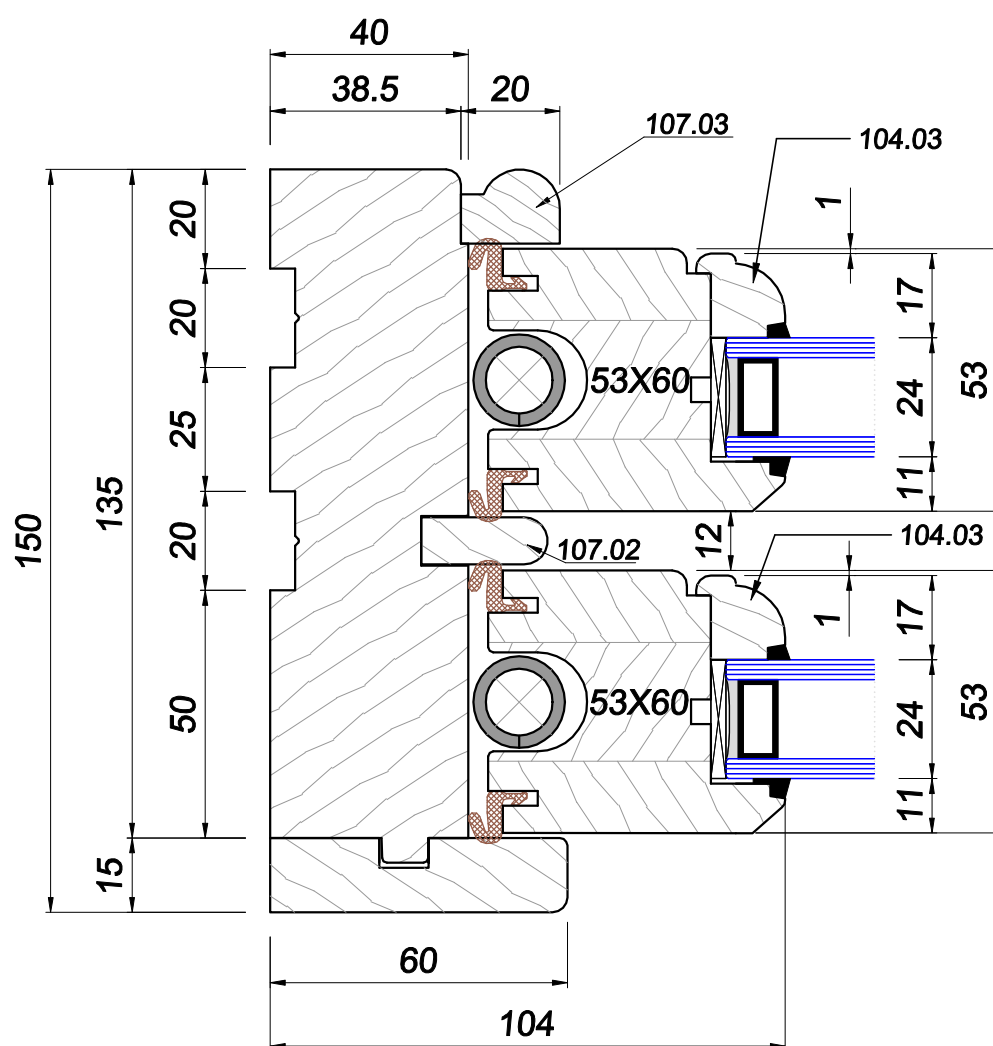

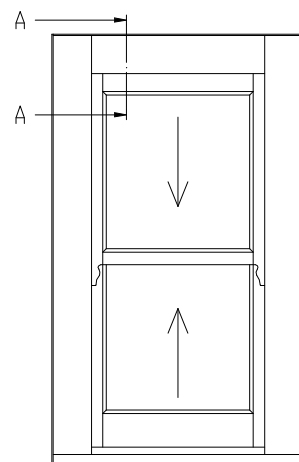

Przek. A-A

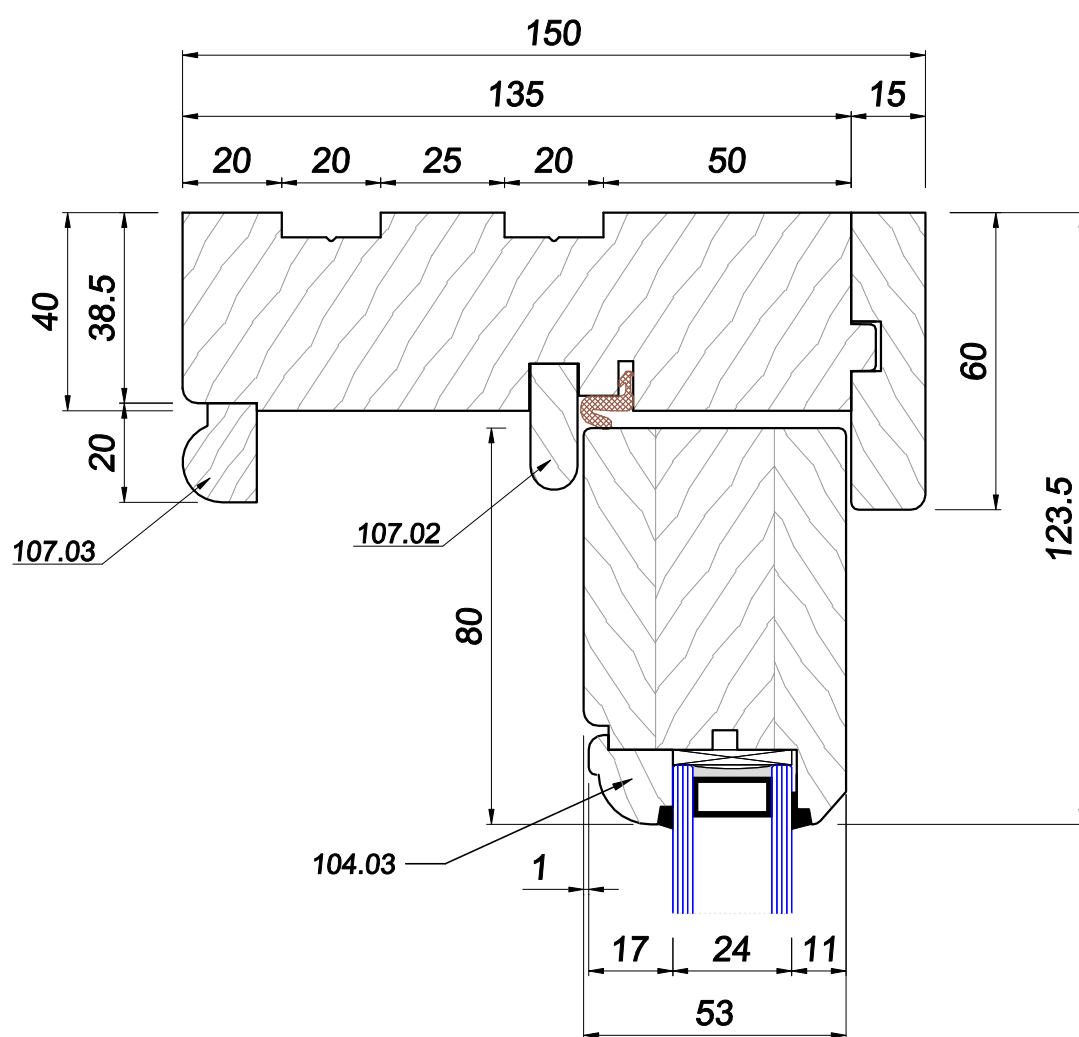

Przek. B-B

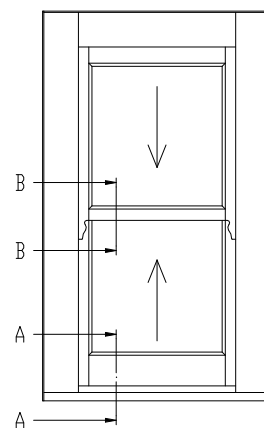
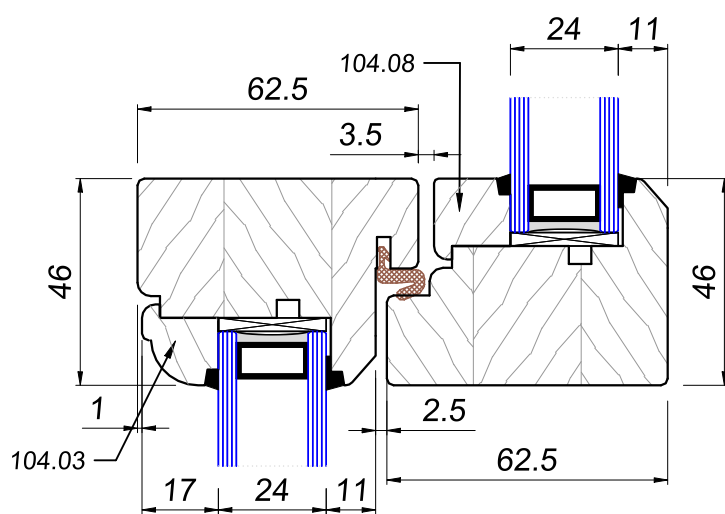

Przek. A-A

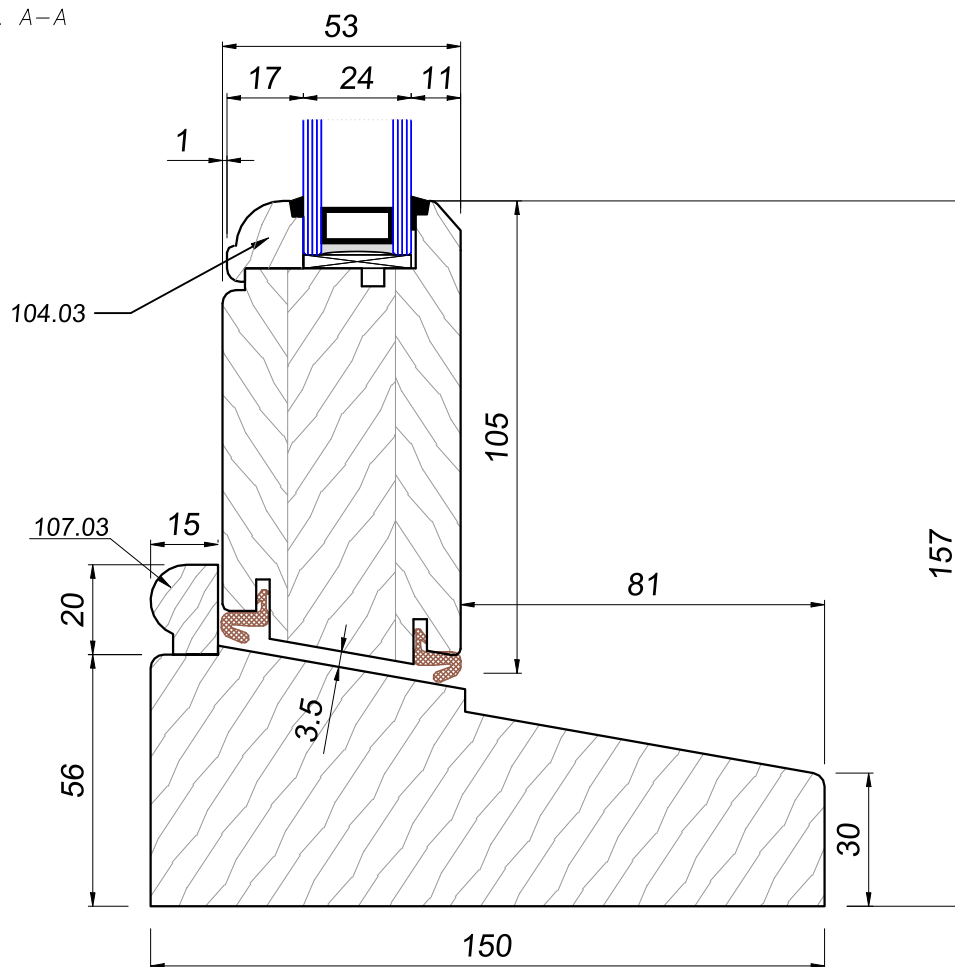

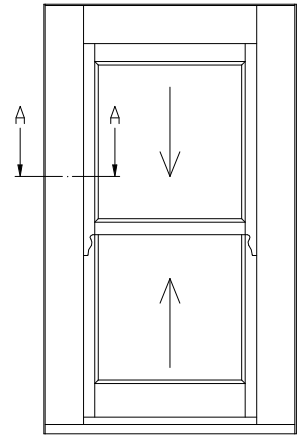

Przek. A-A

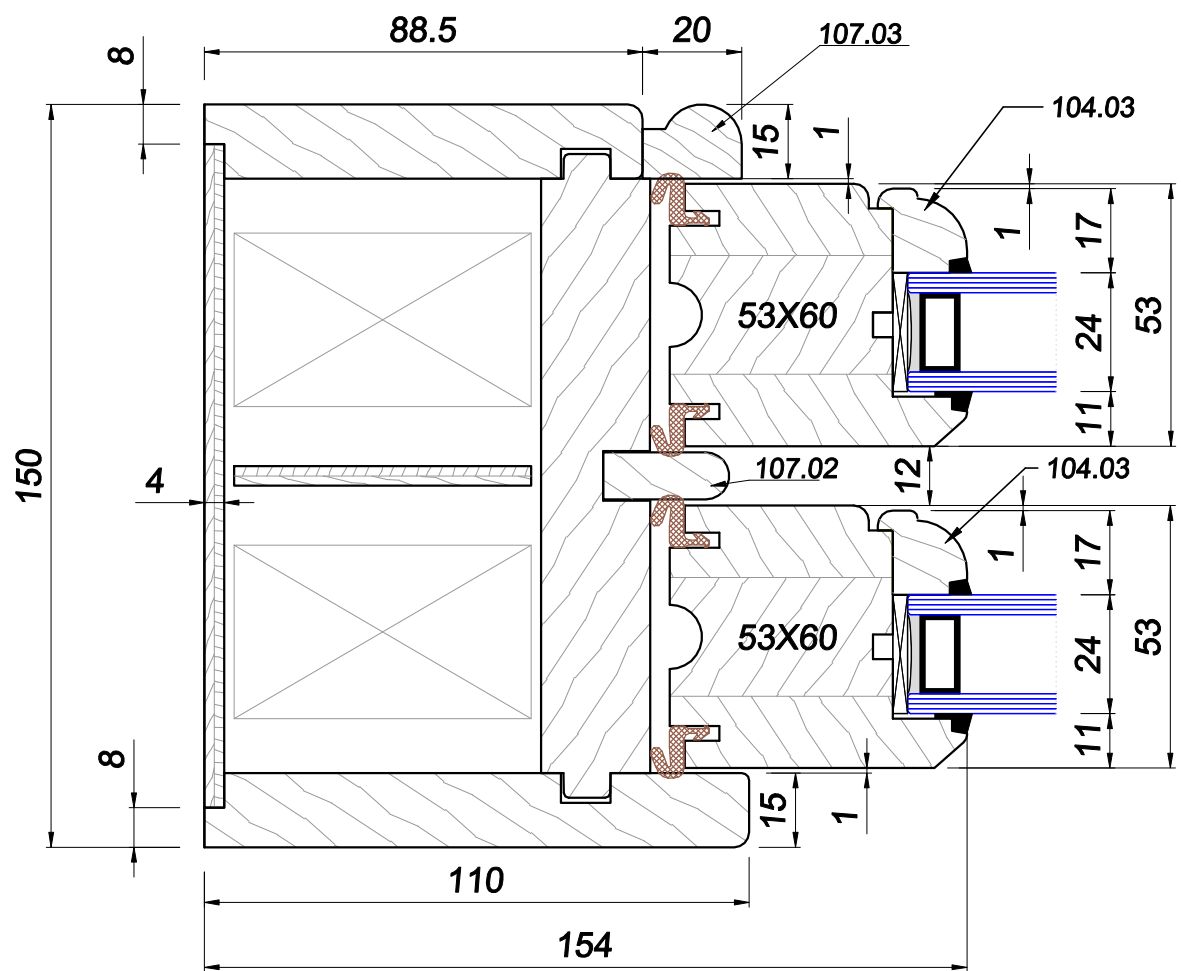

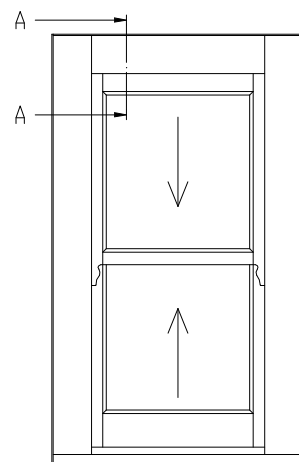

Przek. A-A

