

TYPICAL JOINT EXISTING-PROPOSED  
CONCRETE SLAB

OPTION A (CUTTING BACK OPTION) [SCALE 1:20]

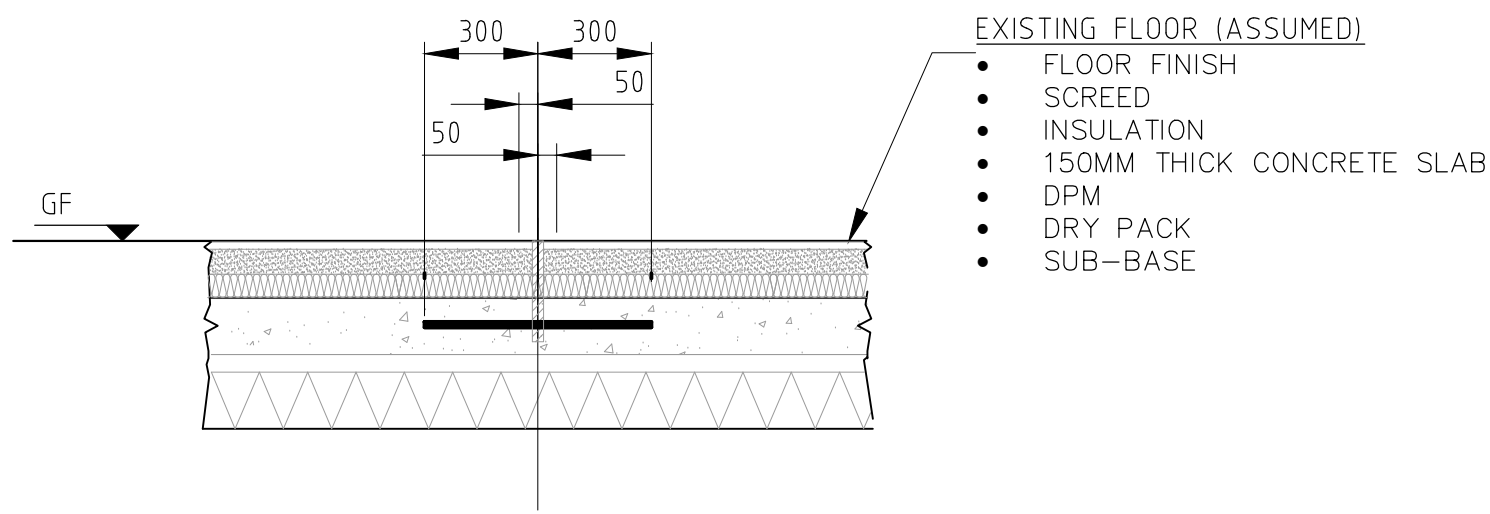

TYPICAL JOINT EXISTING-PROPOSED  
CONCRETE SLAB

OPTION B (DOWEL BARS OPTION) [SCALE 1:20]

ENSURE EXISTING FACE OF CONCRETE IS THOROUGHLY DAMP AND APPLY BONDING AGENT BEFORE CASTING NEW CONCRETE

EXISTING DPM TO BE PROPERLY LAPPED AND SEALED

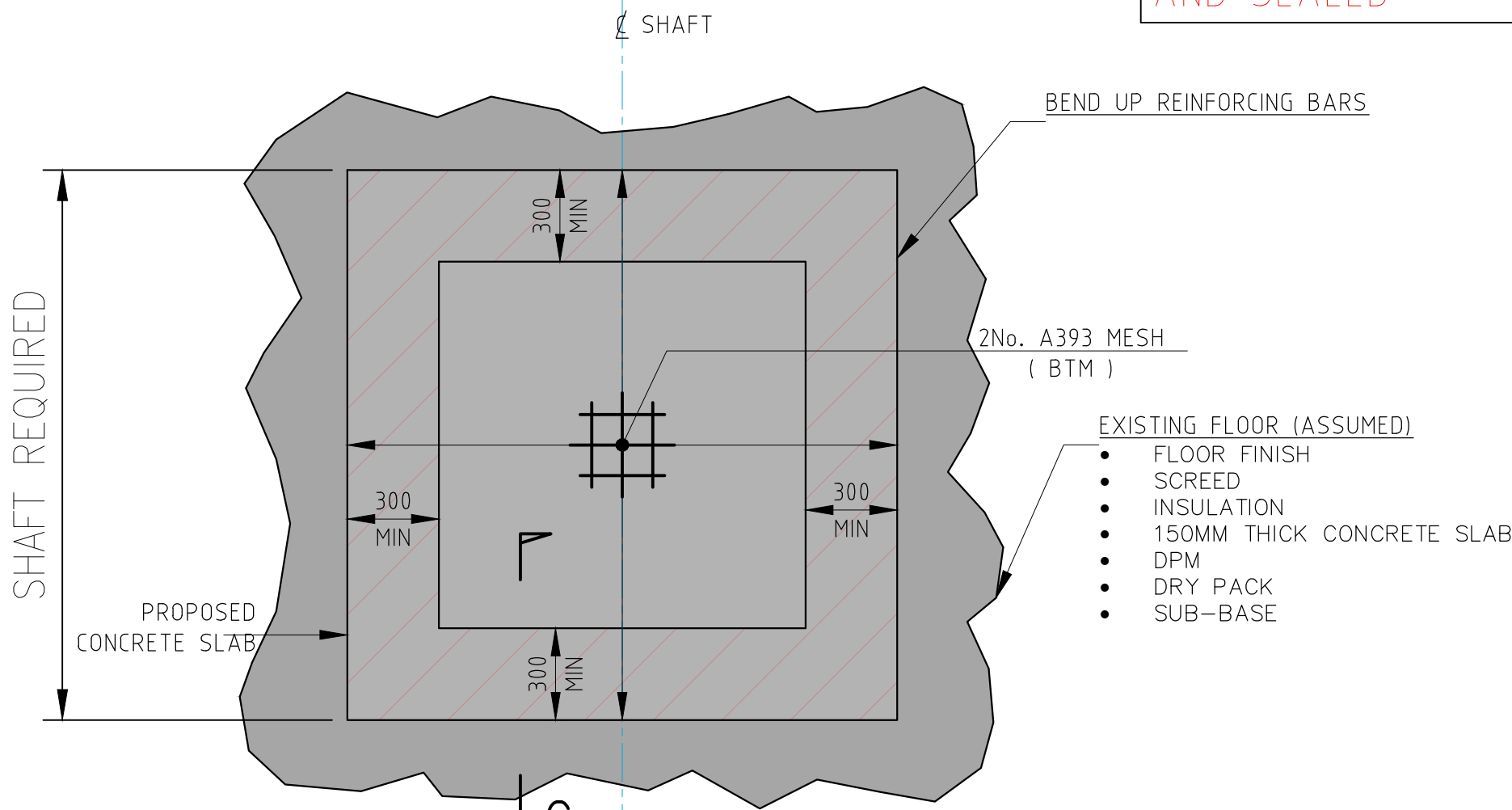

PROPOSED CONCRETE SLAB  
OPTION A

(CUTTING BACK EXISTING SLAB) [SCALE 1:20]

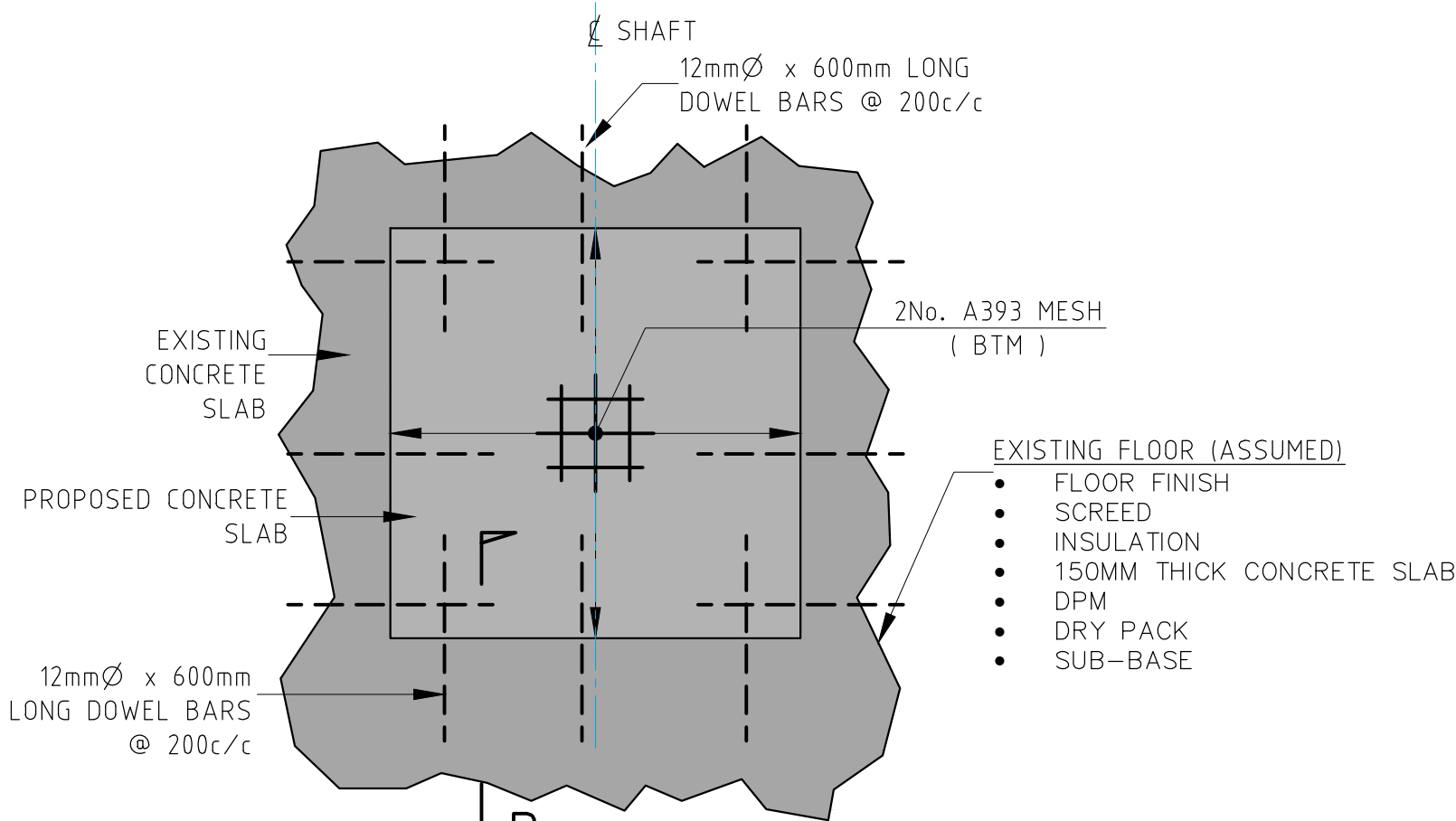

PROPOSED CONCRETE SLAB  
OPTION B

(DOWEL BARS OPTION) [SCALE 1:20]

TYPICAL JOINT EXISTING-PROPOSED  
CONCRETE SLAB

OPTION A (CUTTING BACK OPTION) [SCALE 1:20]

#### GENERAL NOTES

- ALL DIMENSIONS AND LEVELS ARE TO BE DETERMINED AND OR CHECKED BY THE CONTRACTOR ON SITE. SHOULD ANY DISCREPANCY BE IDENTIFIED BETWEEN THE DIMENSIONS, AND OR DETAILS DETERMINED ON SITE, AND THOSE SHOWN THOSE SHOWN ON THE RELEVANT DRAWINGS, THE ENGINEER SHALL BE NOTIFIED IMMEDIATELY, AND HIS INSTRUCTIONS OBTAINED PRIOR TO THE COMMENCEMENT OF THE WORK.
- THE CONTRACTOR SHALL BE RESPONSIBLE FOR THE DESIGN AND IMPLEMENTATION OF ALL TEMPORARY WORKS OTHER THAN THOSE DETAILED, AND THE SAFETY AND STABILITY OF THE NEW WORKS AND ADJACENT STRUCTURES DURING CONSTRUCTION.
- WHERE A PRODUCT IS SPECIFIED TO BE OBTAINED FROM A MANUFACTURER OR SUPPLIER, THE CONTRACTOR SHALL INSTALL THE PRODUCT IN ACCORDANCE WITH THE INSTRUCTIONS SUPPLIED BY THE MANUFACTURER. SHOULD THERE BE ANY VARIATION BETWEEN THE BETWEEN WORK SPECIFIED ON THE DRAWINGS AND THE MANUFACTURER'S INSTRUCTIONS, THE CONTRACTOR SHALL REFER THE MATTER TO THE ARCHITECT FOR INSTRUCTION BEFORE PROCEEDING.
- ALL DIMENSIONS ARE IN MILLIMETRES, UNLESS NOTED OTHERWISE.
- DRAWINGS ARE NOT TO BE SCALED.

#### GROUND MOVEMENT

TEMPORARY WORKS FOR THE SHORING OF EXCAVATIONS WILL ALWAYS RESULT IN SOME GROUND MOVEMENTS (BOTH LATERAL AND SETTLEMENT) BEHIND THE SHORING.

- ENSURE ALL VOIDS ARE COMPREHENSIVELY INFILLED CONTINUOUSLY AS THE SHAFT IS DRIVEN.

#### INSTALLATION

IT IS CLIENT'S RESPONSIBILITY TO DEVELOP A SAFE SYSTEM IF WORK FOR THE INSTALLATION AND USE OF THE EQUIPMENTS. DESIGN IS STANDARD BASED UPON TYPICAL DESIGN. ANY SITE-SPECIFIC HAZARDS IDENTIFIED BY THE CLIENT SHOULD FORM THE BASIS OF THEIR RISK ASSESSMENTS AND SAFE SYSTEM OF WORK THAT IS NECESSARY FOR SAFE EXECUTION OF THE WORKS.

- IF IN DOUBT REPORT IT TO DESIGNER FOR THEIR COMMENTS.

#### GROUT:-

IF REQUIRED PUMP CEMENTITIOUS GROUT TO FILL VOIDS BEHIND THE SHEETS (FOR SHAFTS)/BOARDS (FOR HEADING) TO PROVIDE STABILITY TO THE MADE GROUND/SAND/GRAVEL SOILS AS THE EXCAVATION PROGRESSES.

#### SITE SPECIFIC NOTES

- WATER LEVEL AS SHOWN; IF ANY FOUND
- ENSURE ALL HOLES/SHAFTS ARE PROTECTED FROM RAIN.
- ALL DIMENSIONS, LEVELS ETC TO BE VERIFIED/CONFIRMED BY CONTRACTOR. ANY DISCREPANCIES TO BE NOTIFIED TO THE ENGINEER.
- AVOID POSSIBLE RISK OF MOVEMENT TO EXISTING FOUNDATIONS BY KEEPING FRAMES TIGHT AGAINST THE OPENING WITH NO GAP, AND SHOULD NOT BE LEFT LOSE ANYTIME.
- CONTRACTOR TO TAKE SPECIAL CARE DURING EXCAVATION NOT TO DISTURB UNDERGROUND PIPES AND CABLES. EXTRA CARE TO BE TAKEN WHILE WORKING NEAR FOOTINGS.
- BACKFILL SHAFT USING LEAN MIX CONCRETE IN LINE WITH UTILITY COMPANY REQUIREMENTS FOR SERVICES FOUND. THIS TO LIMIT ANY MOVEMENT OF THE EXISTING BUILDING.
- CONTRACTOR TO MONITOR THE MOVEMENTS IN THE WALLS NEAR THE SHAFT/HEADING BEFORE AND DURING THE WORKS.
- CONDITION SURVEY TO BE CARRIED OUT BEFORE AND AFTER TO MONITOR MOVEMENTS/CRACKS IF ANY
- LEAVE SITE CLEAN AND TIDY.

#### SURVEYS & INVESTIGATIONS

- BEFORE COMMENCING WORK THE CONTRACTOR SHALL CARRY OUT AN EXTERNAL CONDITION SURVEY OF THE EXISTING BURIED STRUCTURES AND SERVICES INCLUDING RECORD PHOTOGRAPHS.
- THE CONTRACTOR SHALL EXCAVATE THE GROUND IN SELECTED LOCATIONS TO ESTABLISH THE EXISTING BURIED STRUCTURES AND SERVICES.

#### STEEL NOTES

- ALL STEEL TO BE GRADE S355.
- ALL BOLTS TO BE MIN GRADE 8.8.
- ALL WELDING TO BE SUITABLE FOR S355 STEEL.

C01	31/01/24	ISSUED FOR CONSTRUCTION	MAK	M.R
REV	DATE	DESCRIPTION	BY	APP

PROJECT:

5 HOLLY MOUNT, NW3 6SG

TITLE:

SLAB REMOVAL DETAIL

CLIENT:

J BROWNE CONSTRUCTION CO LTD

**MWP**

ENGINEERING AND ENVIRONMENTAL CONSULTANTS  
CORK | TRALEE | LONDON | LIMERICK  
mwalsh.co.uk

DRAWN: MAK	CHECKED: S.A	APPROVED: M.R
PROJECT NUMBER: 24483	DATE: 31/01/2024	SCALE @ A0: AS SHOWN
STATUS DESCRIPTION: FOR CONSTRUCTION		STATUS: A

DRAWING NUMBER: JBR - MWP - 00-XX-DR-C- 1003	REV: C01
--	----------