

PROPOSED ELEVATION A-A

PROPOSED ELEVATION D-D

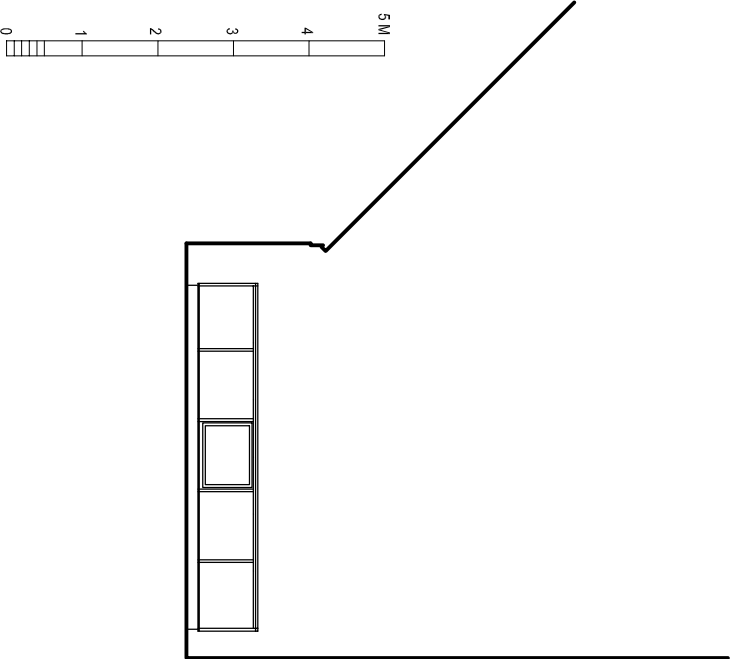
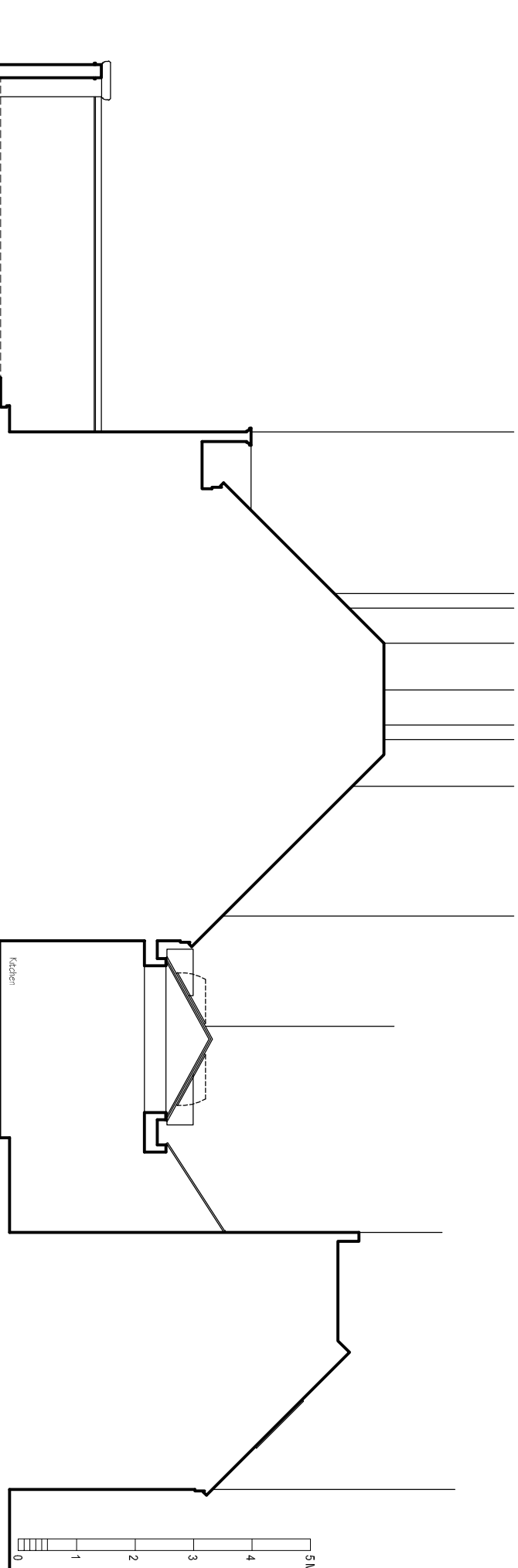

PROPOSED ELEVATION B-B

PROPOSED ELEVATION E-E

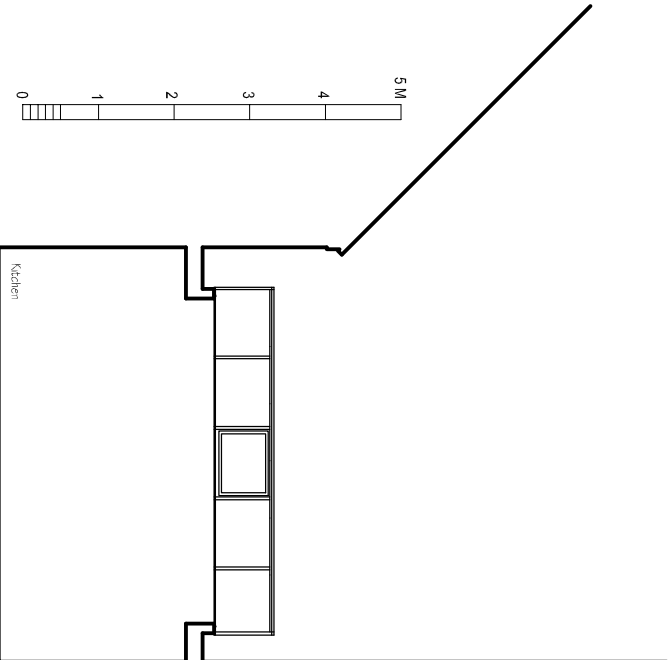
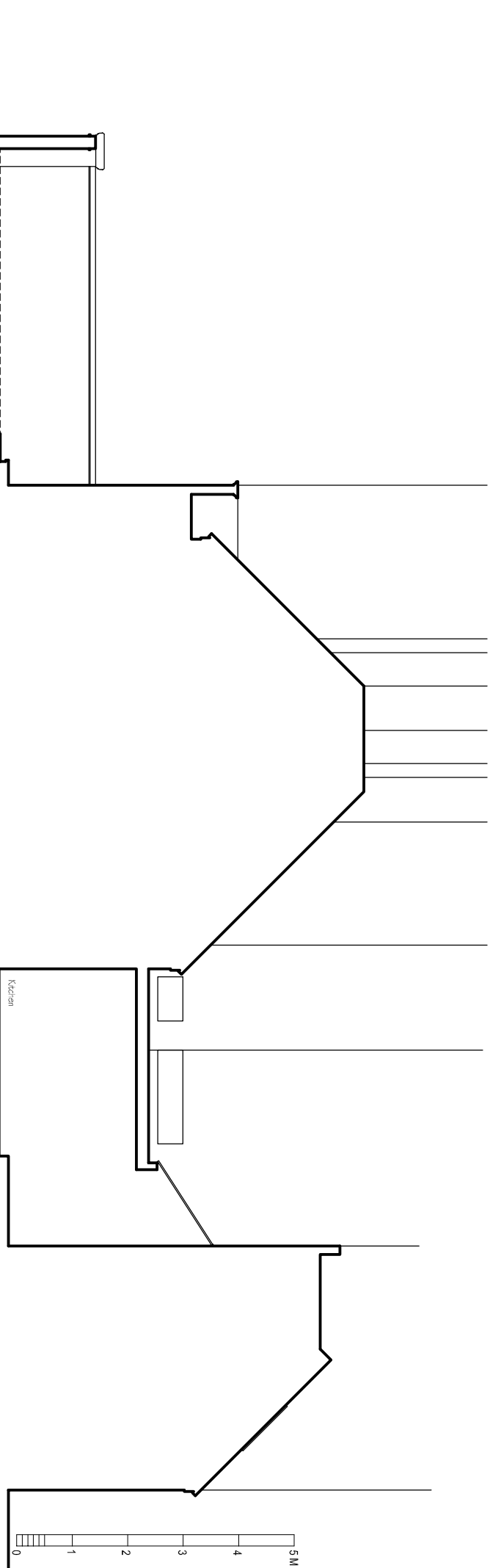

PROPOSED ELEVATION C-C

PROPOSED ELEVATION F-F

PLANNING

www.cadmonkies.co.uk
cadmonkies@btconnect.com
01280 - 70 44 44



Head Office : Studio 25, Westdown Court, BAUXITE, UNIT 25
London Office : 7th Floor, Studio 25, Westdown Road, Twickenham, LONDON, TW9 1AF
London Office : (South) Studio 25, South 25, Twickenham, LONDON, TW9 1AF
London Office : (East) Studio 25, East 25, Twickenham, LONDON, TW9 1AF

Planning and Building Regulations Design Consultants
Architectural Technologists
Local Authorities Planning Agent Group Member
Local Authorities Building Control Partner Member
Planning Portal Professional Status
Landmark and Promag Member
Planning Appeal Consultants

CLIENT:

Mr and Mrs C Kaila-Bishop

ADDRESS:

Flat 1, 33 Eaton Avenue
LONDON, NW33EL

CONTACT:

Mr C Kaila-Bishop

SITE:

Flat 1, 33 Eaton Avenue
LONDON
NW33EL

SCHEME:

Proposed Replacement Vaulted Atrium
and Lean to with Associated Internal
and External works.

DRAWING TITLE:

Proposed Plans

DATE:

June 2024

DRAWN:

david perous

SCALE:

1:100

REV:

2

DRAWING No:

P/24/134/007