

Existing Second Floor Plan

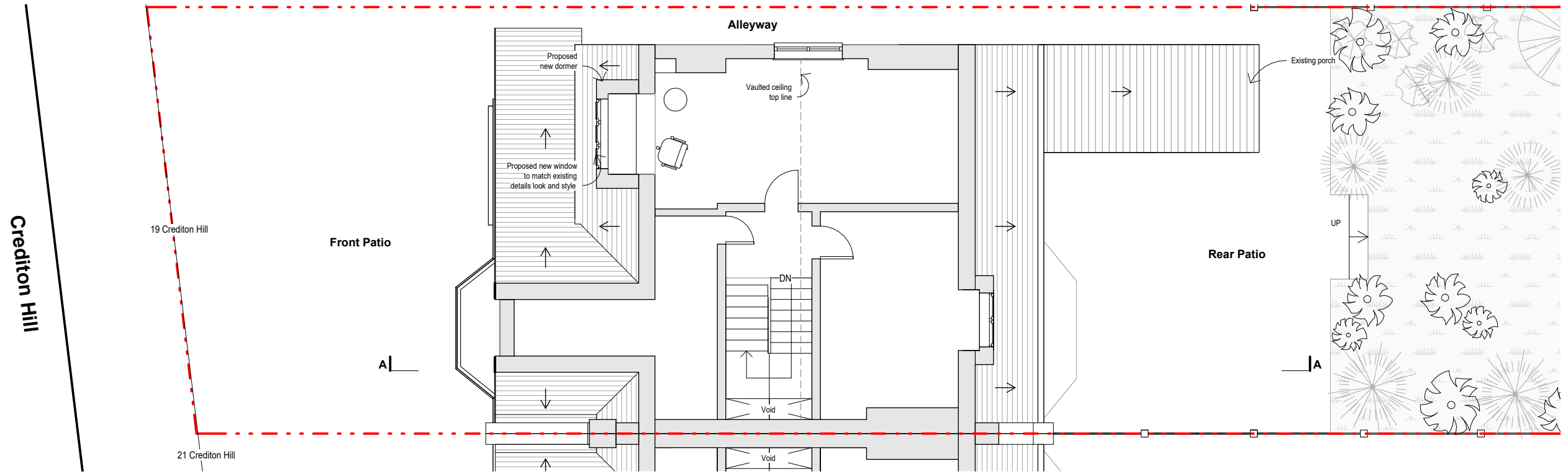

Proposed Second Floor Plan

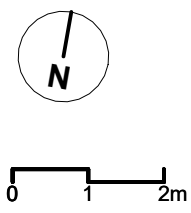

PROJECT
Crediton Hill

ADDRESS
19 Crediton Hill
London. NW6 1HS

DRAWING TITLE
Existing & Proposed SF Plans

SCAL	DATE	REV	DWG NO.
1 : 100	02/04/24		D107_

www.hampsteadarchitects.com 663 Finchley Road, Hampstead, NW2 2HN T - 02074356231

