

Picture 1 - Bottom of Door leaf (Living)
(1290mm = -1mm)



Picture 2 - Highest point of timber floor
(1339mm = -50mm)



Picture 2 - Bottom of Door leaf (Dining)
(1281mm = +8mm)

49mm

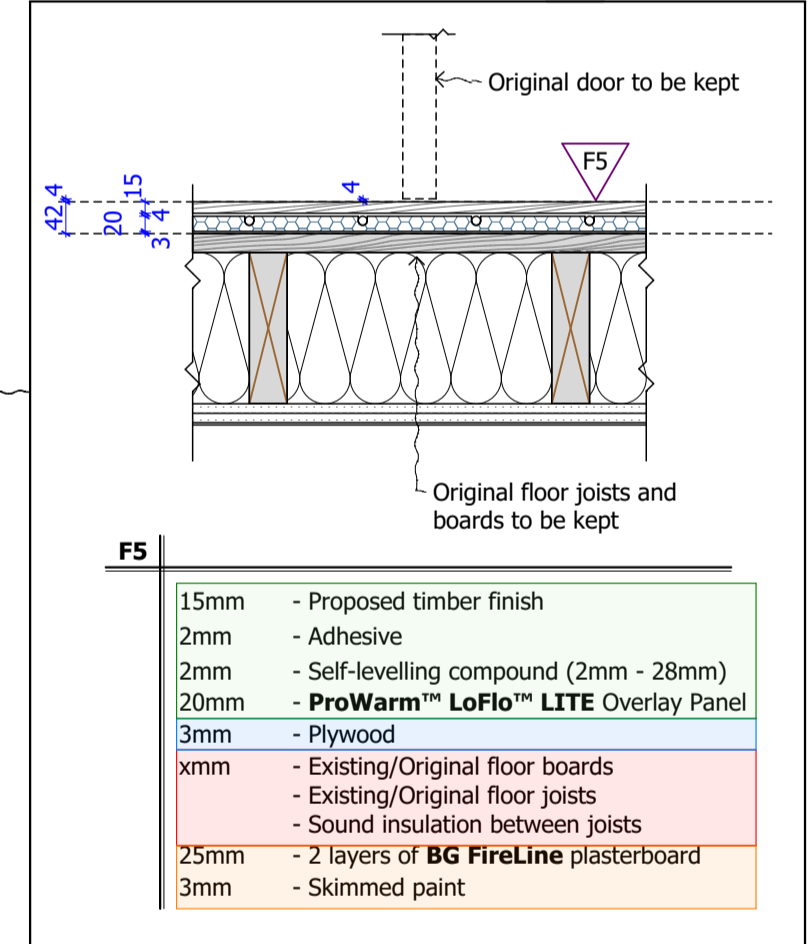
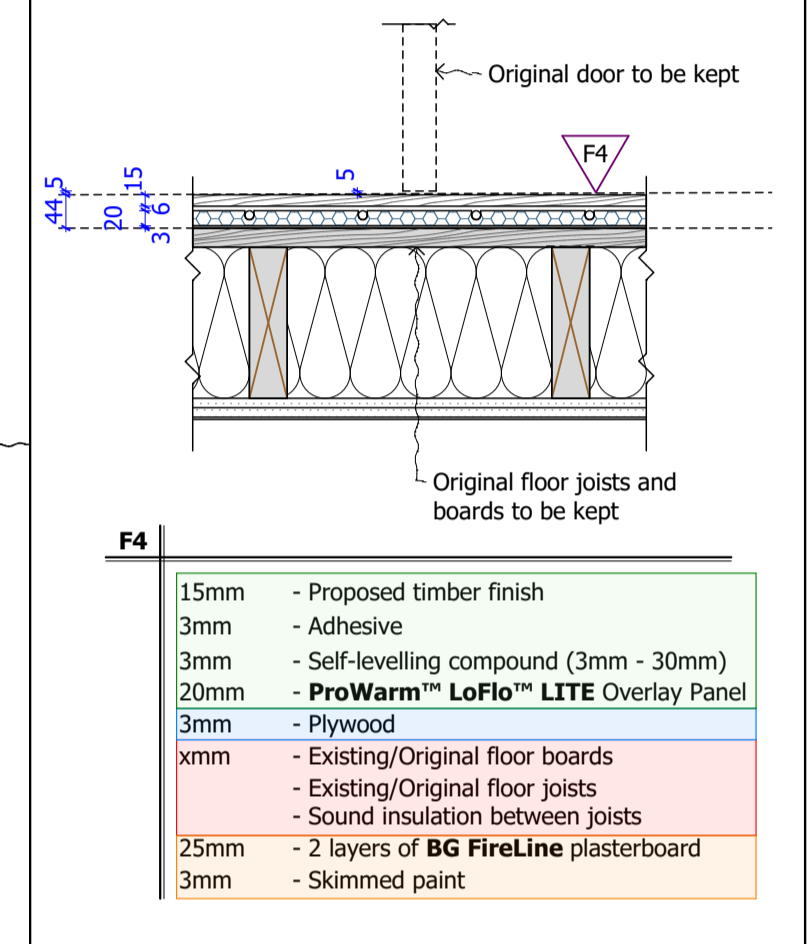

Original floor boards and proposed build up will be separated by a plywood board.



Picture 4 - Bottom of Door leaf
(1022mm = +/-0mm)



Picture 5 - Highest point of timber floor
(1068mm = -46mm)

46mm

This drawing is not to be scaled for construction purposes. All dimensions are to be checked on site before any work is put in hand.
If in doubt, ask.
Copyright © 4H Architecture Limited 2024
Registered in England & Wales.
Registered No. 12112149
4H is the trading name of 4H Architecture Limited

Legend

- Wet UFH
- Electric UFH

Lower Ground Floor:
Wet underfloor heating in new proposed screed
Electric underfloor heating in Bathrooms

Rev.	Date	Description
LBC01	18.05.2024	Listed Building Consent
project 131_9 Wedderburn Road		
site address 9 Wedderburn Road London NW3 5QS		
client Private Client		
drawing title Heating - Ground Floor Plan		
project number_drawing number_revision 131_407_LBC01		
date 18.05.2024.		
designed / drawn by 4H Architecture 0751572458 info@4harchitecture.co.uk		
scale 0 1 2.5m scale 1:50		