

FIGURE 1: LOCATION PLAN
SCALE 1:1250

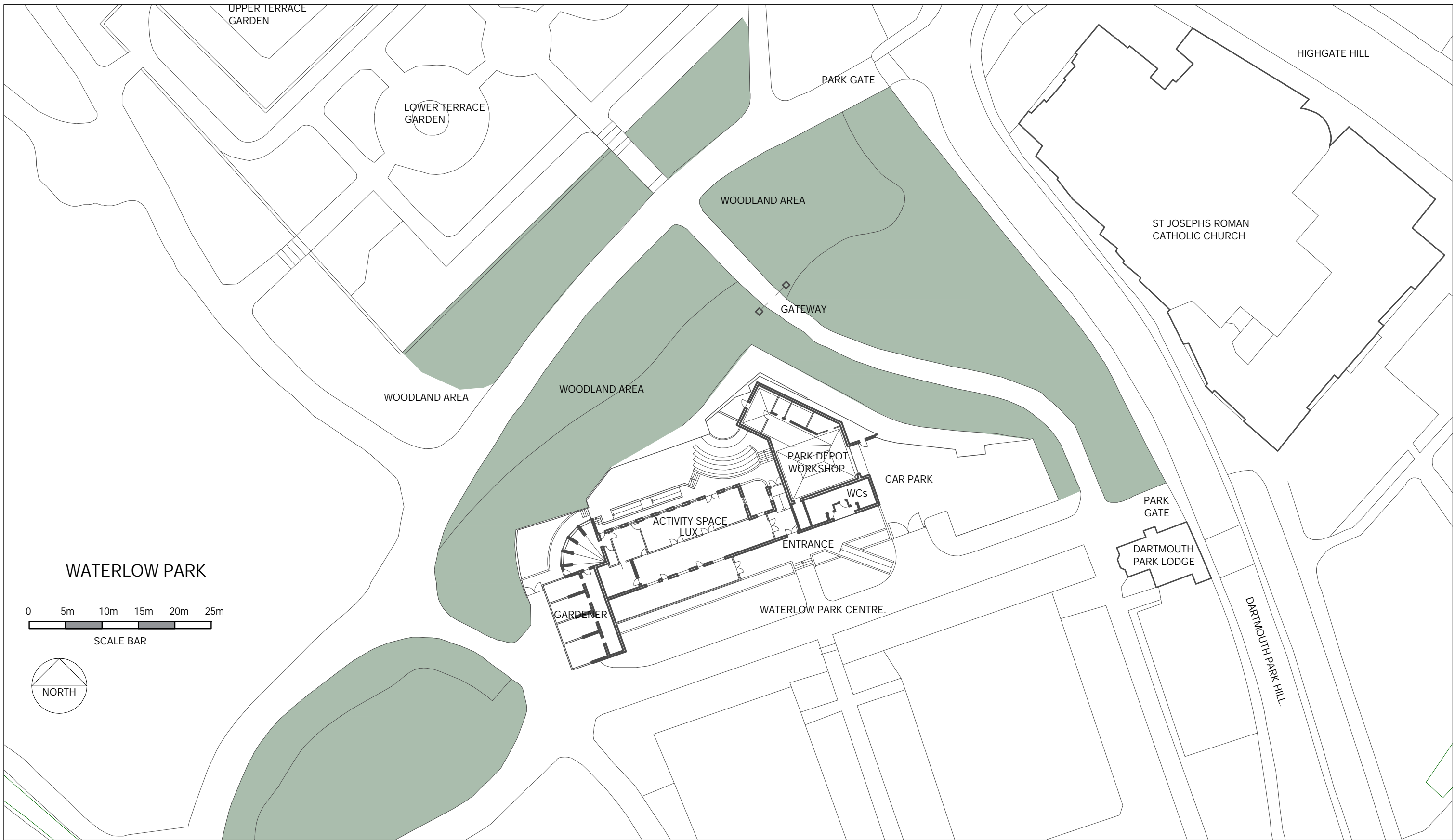

FIGURE 1: EXISTING
SITE PLAN
SCALE 1:500

- General Notes
1. Contractor to check all dimensions on site. Should any discrepancies be identified between the dimensions, and or details determined on site, and those shown on the relevant drawings, the architect shall be notified immediately, and his instructions obtained prior to the commencement of work.
 2. The Contractor shall be responsible for the design and implementation of all temporary works, and the safety and stability of new works and adjacent structures during construction.
 3. Where a product is specified to be obtained from a manufacturer supplier, the contractor shall install the product in accordance with the instructions supplied by the manufacturer.
 4. Should there be any variation between the work specified on the drawings and the manufacturers instructions, the contractor shall refer the matter to the architect before proceeding.

EN-PLAN
PLANNING & ARCHITECTURE

No.	Revision/Issue	Date

Firm Name and Address
en-plan
missenden
back lane
bomere heath
nr shrewsbury
shropshire
sy4 3ph
tel: 07931 541 804

Project Name and Address
WATERLOW PARK CENTRE,
DARTMOUTH PARK HILL,
N19 5JF

Project planning application	1
Date 20.05.2024	
Scale N/A	

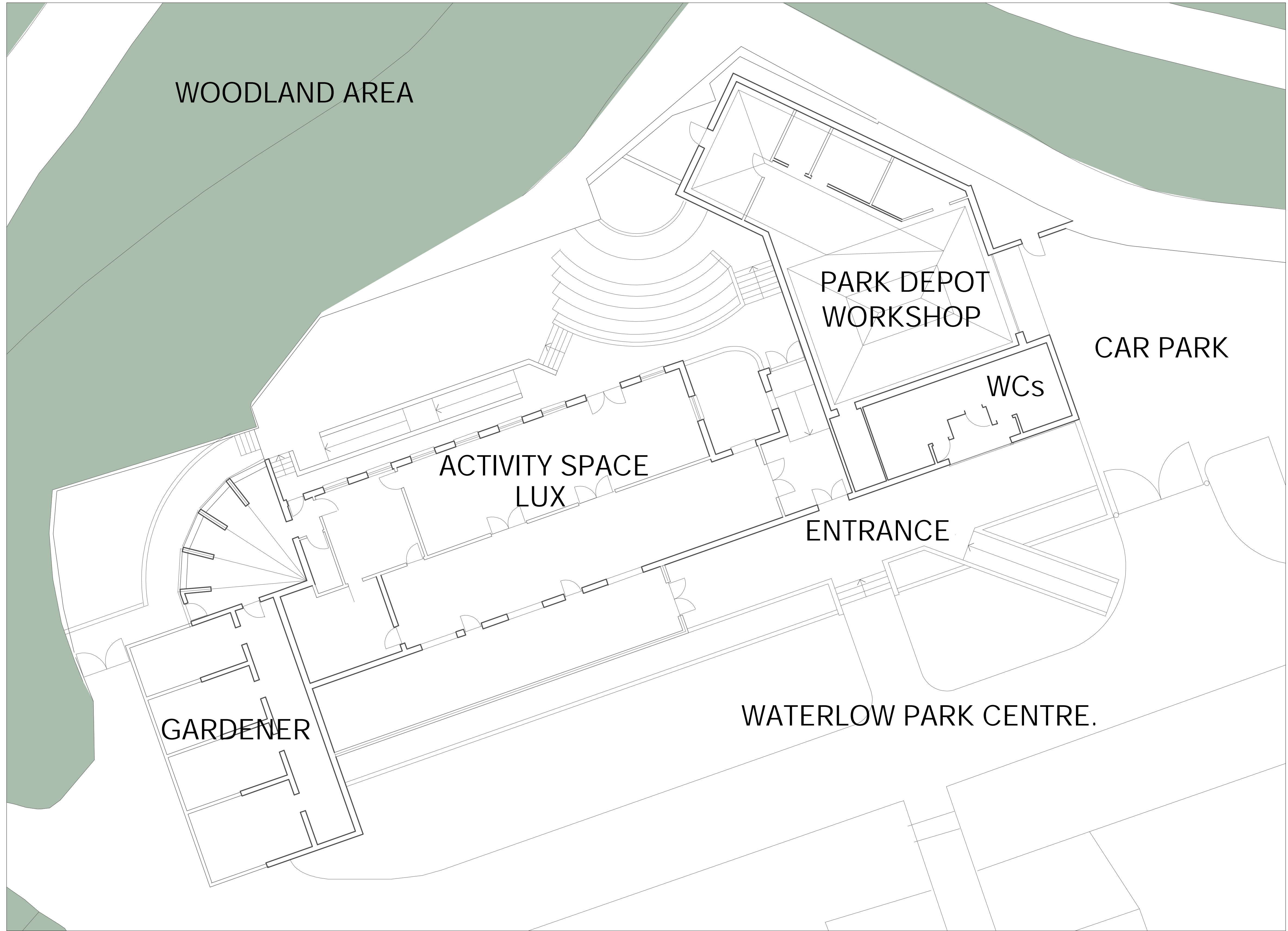

FIGURE 3: EXISTING LAYOUT
SCALE 1:100

General Notes

1. Contractor to check all dimensions on site. Should any discrepancies be identified between the dimensions, and or details determined on site, and those shown on the relevant drawings, the architect shall be notified immediately, and his instructions obtained prior to the commencement of work.
2. The Contractor shall be responsible for the design and implementation of all temporary works, and the safety and stability of new works and adjacent structures during construction.
3. Where a product is specified to be obtained from a manufacturer supplier, the contractor shall install the product in accordance with the instructions supplied by the manufacturer.
4. Should there be any variation between the work specified on the drawings and the manufacturers instructions, the contractor shall refer the matter to the architect before proceeding.

EN-PLAN

PLANNING & ARCHITECTURE

No.	Revision/Issue	Date

Firm Name and Address
en-plan
missenden
back lane
bomere heath
nr shrewsbury
shropshire
sy4 3ph
tel: 07931 541 804

Project Name and Address
WATERLOW PARK CENTRE,
DARTMOUTH PARK HILL,
N19 5JF

Project planning application
Date 20.05.2024
Scale N/A

2

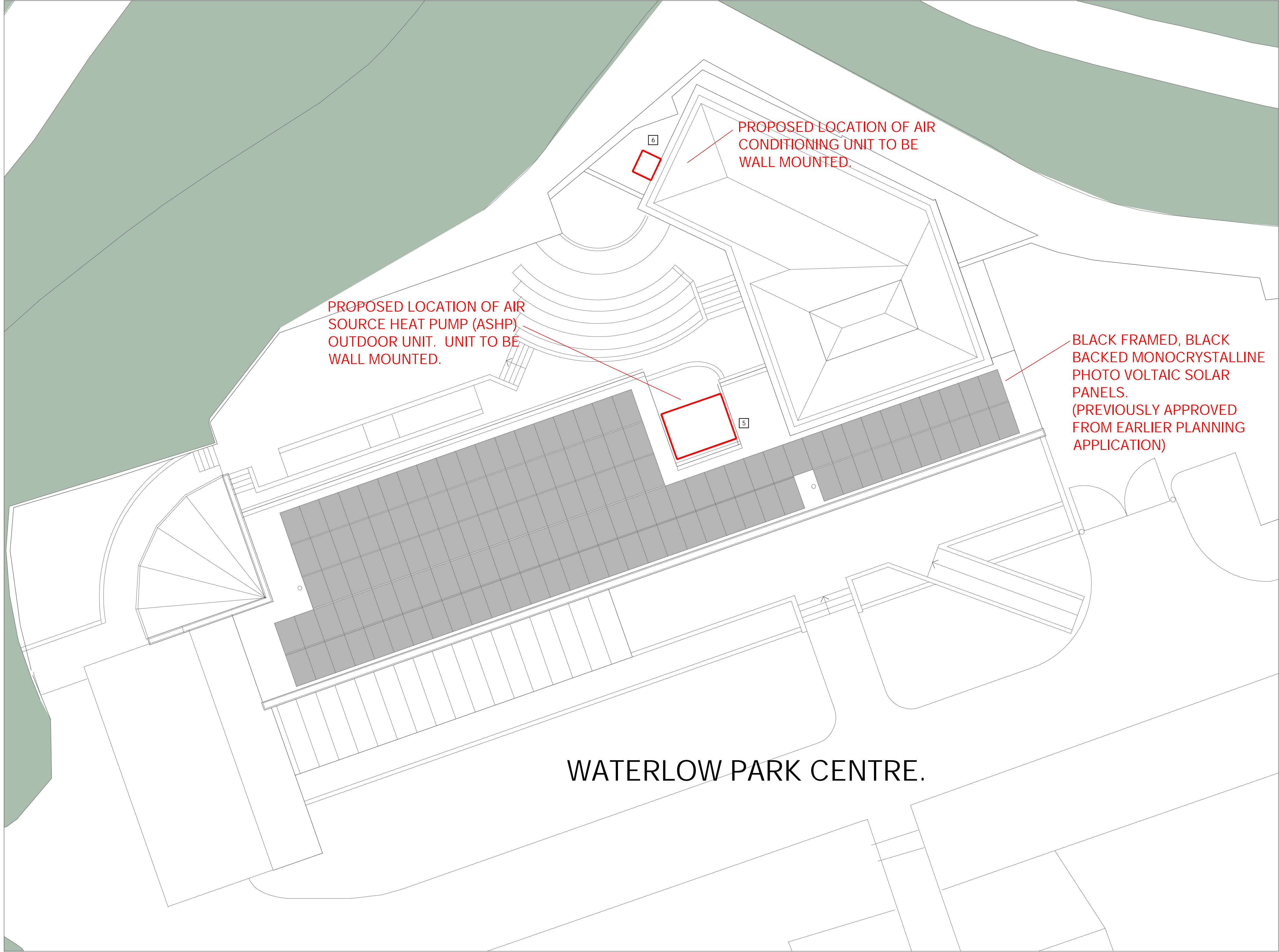

FIGURE 4: PROPOSED SITE PLAN
SCALE 1:100

General Notes

1. Contractor to check all dimensions on site. Should any discrepancies be identified between the dimensions, and or details determined on site, and those shown on the relevant drawings, the architect shall be notified immediately, and his instructions obtained prior to the commencement of work.
2. The Contractor shall be responsible for the design and implementation of all temporary works, and the safety and stability of new works and adjacent structures during construction.
3. Where a product is specified to be obtained from a manufacturer supplier, the contractor shall install the product in accordance with the instructions supplied by the manufacturer.
4. Should there be any variation between the work specified on the drawings and the manufacturers instructions, the contractor shall refer the matter to the architect before proceeding.

EN-PLAN

PLANNING & ARCHITECTURE

No.	Revision/Issue	Date

Firm Name and Address
en-plan
missenden
back lane
bomere heath
nr shrewsbury
shropshire
sy4 3ph
tel: 07931 541 804

Project Name and Address
WATERLOW PARK CENTRE,
DARTMOUTH PARK HILL,
N19 5JF

Project planning application
Date 20.05.2024
Scale N/A

3

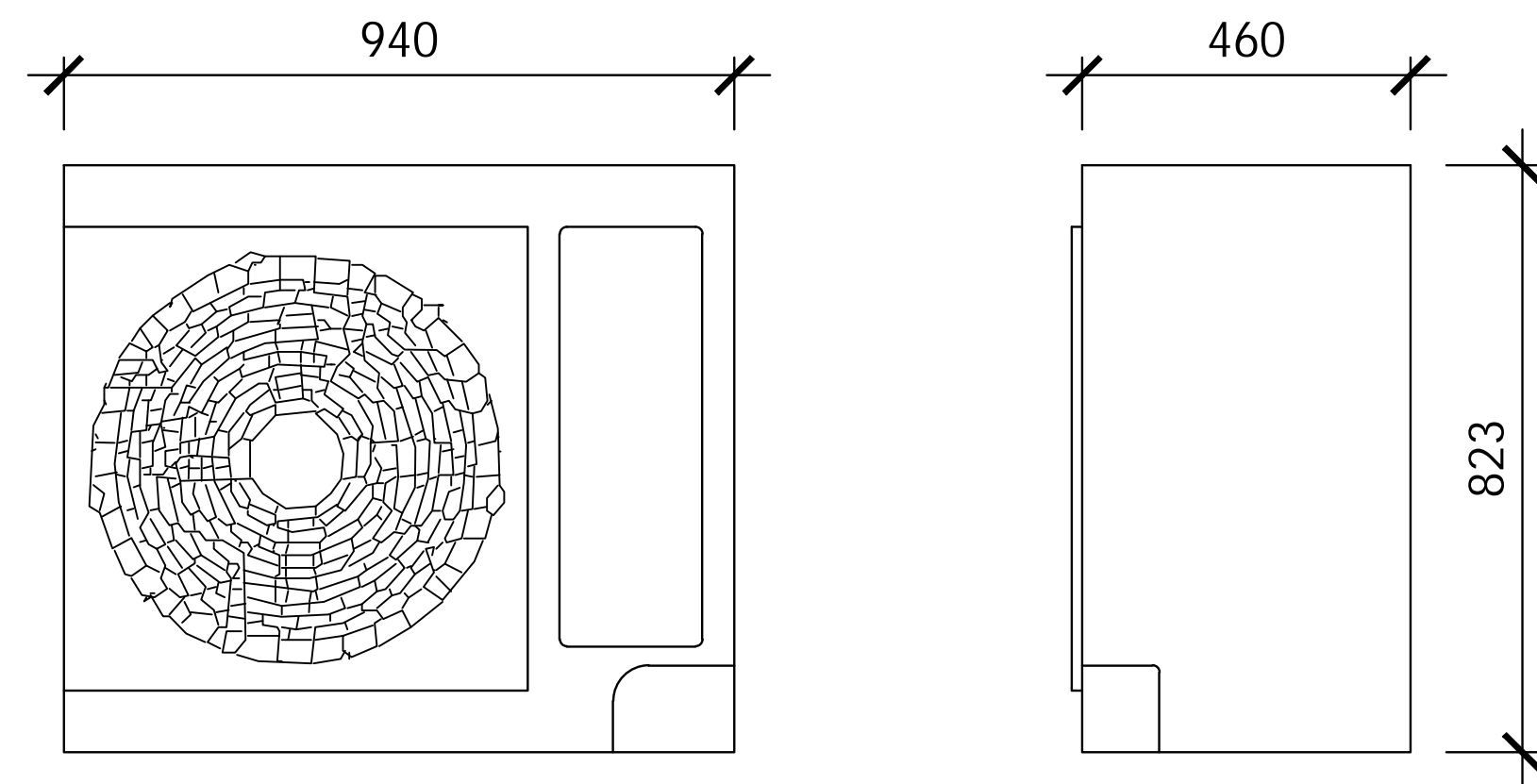

DAIKIN RXY SCQ-5TV1 AIR TO AIR ASHP.

FIGURE 5: AIR SOURCE HEAT PUMP (ASHP) SCALE 1:10

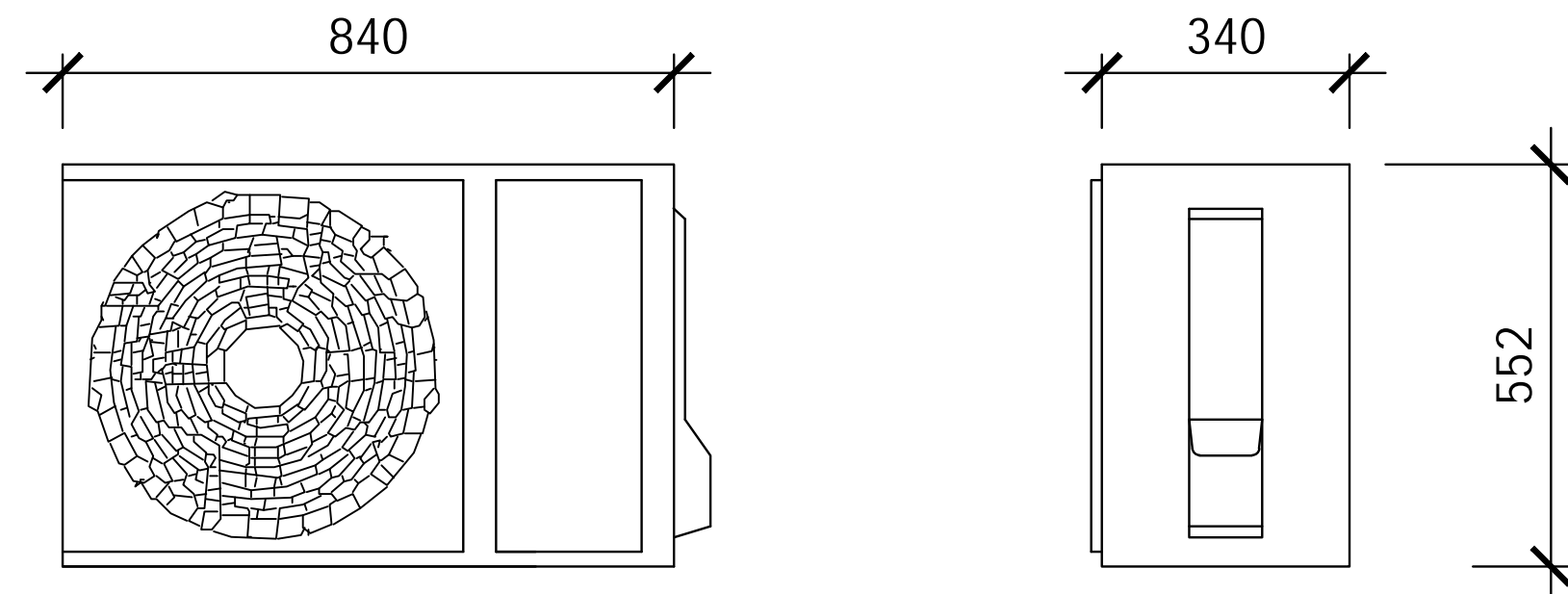

DAIKIN RXM 35R9 AIR CONDITIONING UNIT.

FIGURE 6: AIR CONDITIONING UNIT SCALE 1:10

- General Notes
- Contractor to check all dimensions on site. Should any discrepancies be identified between the dimensions, and or details determined on site, and those shown on the relevant drawings, the architect shall be notified immediately, and his instructions obtained prior to the commencement of work.
 - The Contractor shall be responsible for the design and implementation of all temporary works, and the safety and stability of new works and adjacent structures during construction.
 - Where a product is specified to be obtained from a manufacturer supplier, the contractor shall install the product in accordance with the instructions supplied by the manufacturer.
 - Should there be any variation between the work specified on the drawings and the manufacturers instructions, the contractor shall refer the matter to the architect before proceeding.

EN-PLAN

PLANNING & ARCHITECTURE

No.	Revision/Issue	Date

Firm Name and Address

en-plan
missenden
back lane
bomere heath
nr shrewsbury
shropshire
sy4 3ph
tel: 07931 541 804

Project Name and Address

WATERLOW PARK CENTRE,
DARTMOUTH PARK HILL,
N19 5JF

Project planning application	Sheet 4
Date 20.05.2024	
Scale N/A	