

53 SOUTH HILL PARK
 Drawing taken from
 2009/3830/P from Camden
 council website

55 SOUTH HILL PARK

57 SOUTH HILL PARK
 Drawing taken from
 2019/2662/P from Camden
 council website

NANCY GOULDSTONE ARCHITECTS

The Vineyards, 36 Gloucester Ave, Primrose Hill, NW1 7BB
 info@nancygouldstone.com
 0207 2670024 - 0745 3291906

Project:	55 South Hill Park - NW3 2SS
Drawing Title:	GENERAL - PROPOSED LOWER GROUND FLOOR
Rev:	
Scale:	1:100
Status:	PLANNING
Drawing Number:	134-PL1-GA00-00
Revision:	
Date:	16/05/2023

Revision Notes		
#	Date	Revision Note

Do not scale, use figured dimensions only. All dimensions must be checked on site. Inform the Architect of any discrepancies prior to construction.

Please cross reference this drawing with all related Architect's, Engineers drawings and other relevant information

Copyright
 (c) 2022 Nancy Gouldstone Architects. All rights reserved
 The design and drawings remain the property of Nancy Gouldstone Architects. The client for this project will be licensed to use this design and documents only upon full payment of architectural fees. This license is non-transferable. The design and drawings shall not be reproduced, up-loaded to the internet or traced without the permission of Nancy Gouldstone Architects

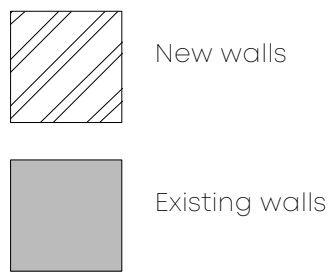

1:100

Creating infill extension into the existing lightwell area. All existing retaining walls left in place. New walls built inside the existing retaining walls to support the rear extension at raised ground floor level