

BEDFORD WAY

BEDF

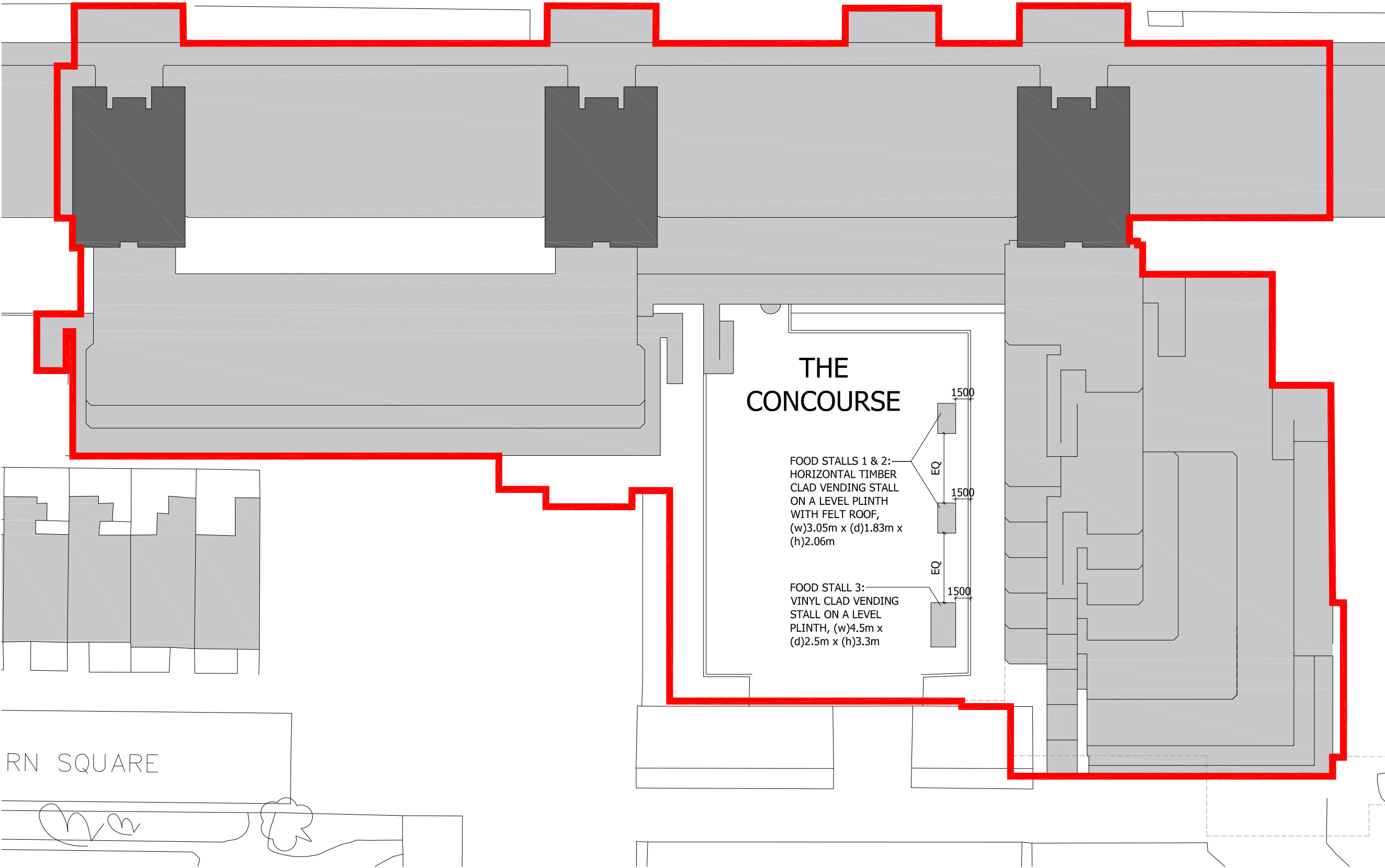

© Architon LLP 2014

This drawing is the property of Architon LLP and must not be divulged to anyone, copied or reproduced, or used for marketing, advertising or promotional purposes without the express written permission of Architon LLP.

All dimensions are to be checked on site and not scaled from this drawing. Contractors must verify all dimensions on site before setting out, commencing work or preparing shop drawings. Any discrepancies on this drawing with other contract documentation to be reported immediately for clarification.

Notes

— SITE BOUNDARY

■ PROPOSED LOCATION OF NEW FOOD STALLS ON CONCOURSE

EXISTING FREE-STANDING BENCHES TO BE RELOCATED TO SUIT LOCATION OF NEW STALLS.

PLANNING ISSUE

P2	MINOR UPDATE	20.05.24
P1	UPDATED AS MEETING 14.05.24	17.05.24
Rev	Description	Date

 Client

Job title

University College London
Institute of Education
20 Bedford Way, WC1H 0AL
Concourse Food Stalls

Drawing title

Proposed Block Plan

Scale	Date	Drawn
1:200 @ A1	March 24	MJR

ARCHITON LLP

CHARTERED ARCHITECTS · DESIGN ·
PLANNING CONSULTANTS · DEVELOPMENT ·
BUILDING COST MANAGEMENT

UPPER DECK TEL:01372 745600
17A WEST STREET
EPSOM KT18 7RL Email:info@architon.com

Drawing No	ARCHITON LLP certified to: BS EN ISO 9001 BS EN ISO 14001 IIP Accreditation
3406 - 003 P2	

RN SQUARE

