

X2
GRAPE STREET

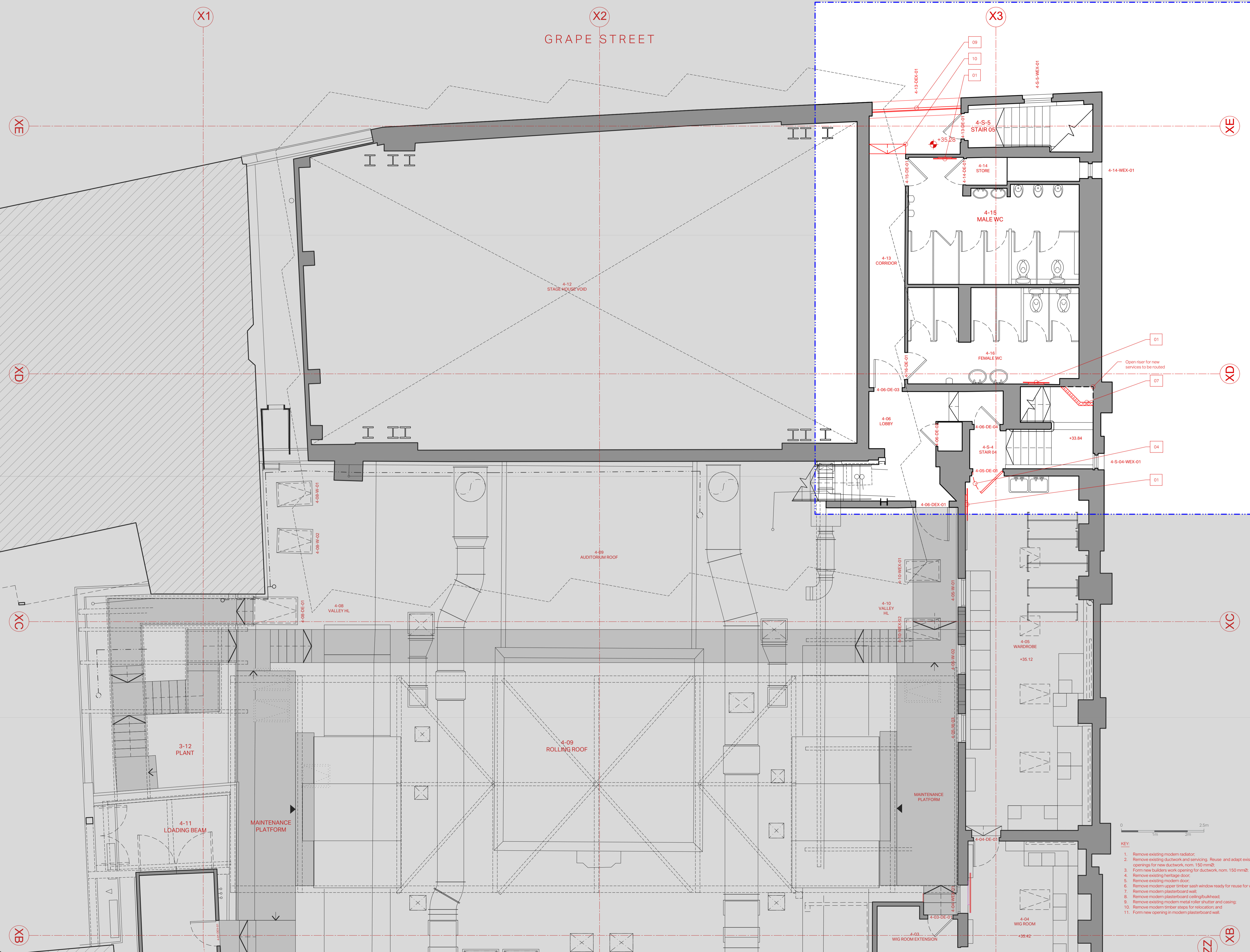

Designsplus Architects
4 Anchor Cottages, Maldon Road, Tiptree, Essex, CO5 0BW
Tel: +44 (0)20 3026 1809 | Web: <https://designs-plus.co.uk/>
E-mail: mail@designs-plus.co.uk
For Designsplus Architects electronic information disclaimer please visit:

HIGH HOLBORN

NOTES:
- DO NOT SCALE THIS DRAWING.
- Measurements are based on the metric system.
- Existing buildings to be measured on site and confirmed by the Contractor.
- All levels are in metres, measured to the Ordnance Datum Mean (1984) unless noted.
- The Contractor should verify all conditions, levels and dimensions on site, notifying the Contract Administrator of any variations before construction or fabrication commences.
- Any discrepancies should be reported to Designsplus Architects.
- Document to be printed in colour.
- The drawing contains architectural information only, please refer to other consultant documents for further information.
- The contents of this drawing are confidential and the copyright is the property of Designsplus Architects.
© Designsplus Architects 2024

KEY:
Existing fabric
Vertical demolition
Floor demolition
Ceiling demolition

KEY:
PO3 Re-issued for planning 220524
PO2 Issued for planning 220324
PO1 Issued for information 210324
Revisions: DD MM YY

Project: Shafesbury Theatre
Client: Theatre of Comedy Company
Drawing Name: Existing & Demolitions
Tile #1 of 2
Fourth Floor
Date: 22/05/24 **Drawn:** PB
Scale: 1:50 @ A1 **Rev/Status:** PO3 S4
Drawing No.: 2203-DP-12-04-01-A-0014

- 1. Remove existing modern radiator.
- 2. Remove existing ductwork and servicing. Reuse and adapt existing openings for new ductwork, nom. 150 mmØ.
- 3. Form new builders work opening for ductwork, nom. 150 mmØ.
- 4. Remove existing heritage door.
- 5. Remove existing modern door.
- 6. Remove modern upper timber sash window ready for reuse for vent.
- 7. Remove modern plasterboard wall.
- 8. Remove modern plasterboard ceiling/bulkhead.
- 9. Remove existing modern metal roller shutter and casing.
- 10. Remove modern timber strips for relocation and.
- 11. Form new opening in modern plasterboard wall.