

GRAPE STREET

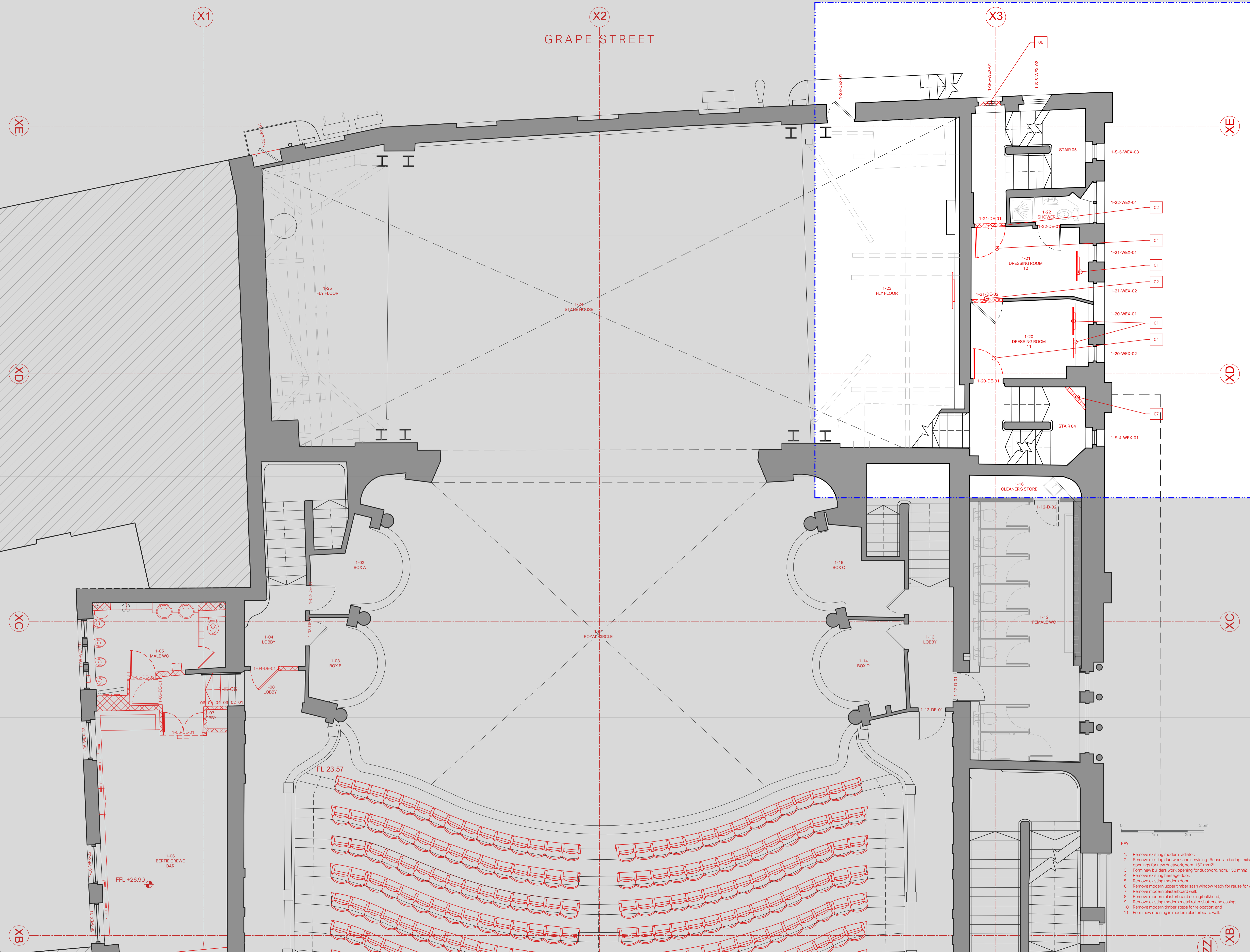

Designsplus Architects
4 Anchor Cottages, Maldon Road, Tiptree, Essex, CO5 0BW
Tel: +44 (0)20 3026 1809 | Web: <https://designs-plus.co.uk/>
E-mail: mail@designs-plus.co.uk
For Designsplus Architects electronic information disclaimer please visit:

NOTES:
- DO NOT SCALE THIS DRAWING.
- Measurements are based on the metric system.
- Existing buildings to be measured on site and confirmed by the Contractor.
- All levels are in metres, measured to the Ordnance Datum (Newlyn) (ODN) unless stated.
- The Contractor should verify all conditions, levels and dimensions on site, notifying the Contract Administrator of any variations before construction or fabrication commences.
- Any discrepancies should be reported to Designsplus Architects.
- Document to be printed in colour.
- The drawing contains architectural information only, please refer to other consultant documents for further information.
- The contents of this drawing are confidential and the copyright is the property of Designsplus Architects.
© Designsplus Architects 2024

KEY:
Existing fabric
Vertical demolition
Floor demolition
Ceiling demolition

- KEY:**
1. Remove existing modern radiator.
 2. Remove existing ductwork and servicing. Reuse and adapt existing openings for new ductwork, nom. 150 mmØ.
 3. Form new builders work opening for ductwork, nom. 150 mmØ.
 4. Remove existing heritage door.
 5. Remove existing modern door.
 6. Remove modern upper timber sash window ready for reuse for vent.
 7. Remove modern plasterboard wall.
 8. Remove modern plasterboard ceiling/bulkhead.
 9. Remove existing modern metal roller shutter and casing.
 10. Remove modern timber strips for relocation and.
 11. Form new opening in modern plasterboard wall.

Project: Shafesbury Theatre
Client: Theatre of Comedy Company
Drawing Name: Existing & Demolitions
First Floor
Tile #1 of 2
Date: 29/03/24 **Drawn:** PB
Scale: 1:50 @ A1 **Rev/Status:** P02 S4
Drawing No.: 2203-DP-12-01-DT-A-0011

HIGH HOLBORN