

STATUTORY DECLARATION

I Sara Rosalind Mark
do solemnly and sincerely declare as follows:-

1. I have lived at Flat 9 The Pryors NW31BS since 12.01.76. During this period of time The Pryors has been my permanent residence. I was a Company Director (retired 2009)
2. I attach a copy of an Existing Car Park Layout Plan prepared by TDC-ARCH DESIGN 02.11.2023 (marked 'A') which I believe to be correct.
3. The flat came with the benefit of a long term right to park a vehicle in the Car Park at The Pryors ('the Car Park') which is situated within the grounds of The Pryors.
4. My flat does not overlook the Car Park.
5. I use the Car Park almost on a weekly basis.
6. I can state to the best of my knowledge and belief that for at least the last 10 years to the present date:-

- A. The perimeter of the Car Park has not been altered.
- B. The surface of the Car Park has not been renewed or altered.
- C. The car space markings within the Car Park have not been altered.
- D. The Car Park has been continuously available for use at The Pryors with 60 car parking spaces.
- E The use of those spaces has been for vehicles of occupiers and users of The Pryors.

and I make this solemn declaration conscientiously believing the same to be true, and by virtue of the provisions of the Statutory Declarations Act 1835

Declared by Sara Rosalind Mark
(insert signature) 

(insert date) 16 December 2023

Before me (insert name and signature)
(insert address) 

48 CHANCERY LANE LONDON WC2A 1JF

A Solicitor/ Commissioner for Oaths
date)

Date (insert

16 DECEMBER
2023

NOTES

1. See also other sheets in this set.
2. All dimensions are in feet and inches unless otherwise noted.
3. The architect shall be responsible for obtaining all necessary permits.
4. The architect shall be responsible for coordinating with all other professionals.
5. The architect shall be responsible for providing all necessary information to the contractor.
6. The architect shall be responsible for providing all necessary information to the owner.
7. The architect shall be responsible for providing all necessary information to the authority having jurisdiction.
8. The architect shall be responsible for providing all necessary information to the relevant regulatory agencies.
9. The architect shall be responsible for providing all necessary information to the relevant regulatory agencies.
10. The architect shall be responsible for providing all necessary information to the relevant regulatory agencies.

NO.	DATE	DESCRIPTION
1	10/10/11	ISSUED FOR PERMITS
2	10/10/11	ISSUED FOR PERMITS
3	10/10/11	ISSUED FOR PERMITS
4	10/10/11	ISSUED FOR PERMITS
5	10/10/11	ISSUED FOR PERMITS
6	10/10/11	ISSUED FOR PERMITS
7	10/10/11	ISSUED FOR PERMITS
8	10/10/11	ISSUED FOR PERMITS
9	10/10/11	ISSUED FOR PERMITS
10	10/10/11	ISSUED FOR PERMITS

www.tdc-arch-design.com
www.tdc-arch-design

TDG ARCH DESIGN
The design called by Architecture

CB Swilt
Building Consulting and Project Management
1110 10th Avenue
Seattle, WA 98108
Tel: 206 497 2182

ARCHITECT
1110 10th Avenue
Seattle, WA 98108
Tel: 206 497 2182

Client: CB Swilt
Project: [illegible]
Location: [illegible]
Scale: [illegible]
Date: [illegible]

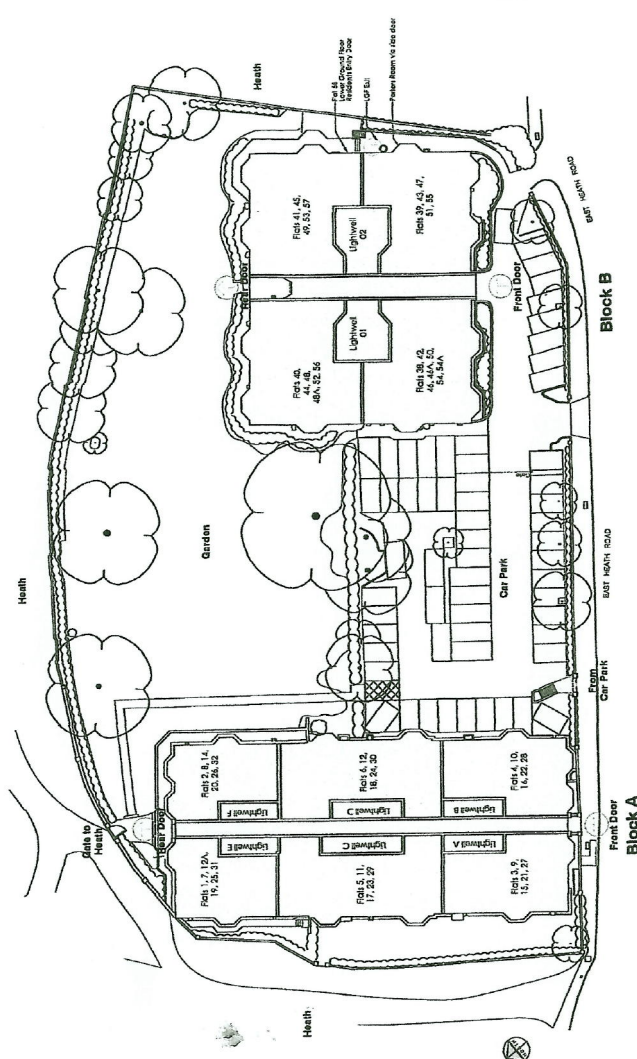

A
Swp
B1A