

**STATUTORY DECLARATION**

I Brian Cooke  
do solemnly and sincerely declare as follows:-

1. I have lived at Flat 12 The Pryors NW31BS since 1991. During this period of time The Pryors has been my permanent residence. I am a retired Civil Servant.
2. I attach a copy of an Existing Car Park Layout Plan prepared by TDC-ARCH DESIGN 02.11.2023 (marked 'A') which I believe to be correct.
3. The flat came with the benefit to park a vehicle in the Car Park at The Pryors ('the Car Park') which is situated within the grounds of The Pryors.
4. My flat overlooks the Car Park.
5. I use the Car Park almost on a daily basis.
6. I can state to the best of my knowledge and belief that for at least the last 10 years to the present date:-
  - A. The perimeter of the Car Park has not been altered.
  - B. The surface of the Car Park has not been renewed or altered.
  - C. The car space markings within the Car Park have not been altered.
  - D. The Car Park has been continuously available for use at The Pryors with 60 car parking spaces.
  - E The use of those spaces has been for vehicles of occupiers and users of The Pryors.

and I make this solemn declaration conscientiously believing the same to be true, and by virtue of the provisions of the Statutory Declarations Act 1835

Declared by Brian Cooke  
(insert signature)

(insert date) 12.12.23

Before me (insert name and signature)  
(insert address)

RACHEL KAPILA  
CLOTH FAIR CHAMBERS  
39-40 CLOTH FAIR  
EC1A 7NT

A Solicitor/ Commissioner for Oaths  
(date)

Date (insert

12.12.23

12.12.23.

1:1000

NO.	DESCRIPTION	DATE	BY	CHECKED
1	PRELIMINARY LAYOUT	10/01/03	AS	AS
2	REVISIONS	10/01/03	AS	AS
3	REVISIONS	10/01/03	AS	AS
4	REVISIONS	10/01/03	AS	AS
5	REVISIONS	10/01/03	AS	AS
6	REVISIONS	10/01/03	AS	AS
7	REVISIONS	10/01/03	AS	AS
8	REVISIONS	10/01/03	AS	AS
9	REVISIONS	10/01/03	AS	AS
10	REVISIONS	10/01/03	AS	AS
11	REVISIONS	10/01/03	AS	AS
12	REVISIONS	10/01/03	AS	AS
13	REVISIONS	10/01/03	AS	AS
14	REVISIONS	10/01/03	AS	AS
15	REVISIONS	10/01/03	AS	AS
16	REVISIONS	10/01/03	AS	AS
17	REVISIONS	10/01/03	AS	AS
18	REVISIONS	10/01/03	AS	AS
19	REVISIONS	10/01/03	AS	AS
20	REVISIONS	10/01/03	AS	AS

**CB Swift**  
 Planning and Design  
 100, 102, 104, 106, 108, 110, 112, 114, 116, 118, 120, 122, 124, 126, 128, 130, 132, 134, 136, 138, 140, 142, 144, 146, 148, 150, 152, 154, 156, 158, 160, 162, 164, 166, 168, 170, 172, 174, 176, 178, 180, 182, 184, 186, 188, 190, 192, 194, 196, 198, 200, 202, 204, 206, 208, 210, 212, 214, 216, 218, 220, 222, 224, 226, 228, 230, 232, 234, 236, 238, 240, 242, 244, 246, 248, 250, 252, 254, 256, 258, 260, 262, 264, 266, 268, 270, 272, 274, 276, 278, 280, 282, 284, 286, 288, 290, 292, 294, 296, 298, 300, 302, 304, 306, 308, 310, 312, 314, 316, 318, 320, 322, 324, 326, 328, 330, 332, 334, 336, 338, 340, 342, 344, 346, 348, 350, 352, 354, 356, 358, 360, 362, 364, 366, 368, 370, 372, 374, 376, 378, 380, 382, 384, 386, 388, 390, 392, 394, 396, 398, 400, 402, 404, 406, 408, 410, 412, 414, 416, 418, 420, 422, 424, 426, 428, 430, 432, 434, 436, 438, 440, 442, 444, 446, 448, 450, 452, 454, 456, 458, 460, 462, 464, 466, 468, 470, 472, 474, 476, 478, 480, 482, 484, 486, 488, 490, 492, 494, 496, 498, 500, 502, 504, 506, 508, 510, 512, 514, 516, 518, 520, 522, 524, 526, 528, 530, 532, 534, 536, 538, 540, 542, 544, 546, 548, 550, 552, 554, 556, 558, 560, 562, 564, 566, 568, 570, 572, 574, 576, 578, 580, 582, 584, 586, 588, 590, 592, 594, 596, 598, 600, 602, 604, 606, 608, 610, 612, 614, 616, 618, 620, 622, 624, 626, 628, 630, 632, 634, 636, 638, 640, 642, 644, 646, 648, 650, 652, 654, 656, 658, 660, 662, 664, 666, 668, 670, 672, 674, 676, 678, 680, 682, 684, 686, 688, 690, 692, 694, 696, 698, 700, 702, 704, 706, 708, 710, 712, 714, 716, 718, 720, 722, 724, 726, 728, 730, 732, 734, 736, 738, 740, 742, 744, 746, 748, 750, 752, 754, 756, 758, 760, 762, 764, 766, 768, 770, 772, 774, 776, 778, 780, 782, 784, 786, 788, 790, 792, 794, 796, 798, 800, 802, 804, 806, 808, 810, 812, 814, 816, 818, 820, 822, 824, 826, 828, 830, 832, 834, 836, 838, 840, 842, 844, 846, 848, 850, 852, 854, 856, 858, 860, 862, 864, 866, 868, 870, 872, 874, 876, 878, 880, 882, 884, 886, 888, 890, 892, 894, 896, 898, 900, 902, 904, 906, 908, 910, 912, 914, 916, 918, 920, 922, 924, 926, 928, 930, 932, 934, 936, 938, 940, 942, 944, 946, 948, 950, 952, 954, 956, 958, 960, 962, 964, 966, 968, 970, 972, 974, 976, 978, 980, 982, 984, 986, 988, 990, 992, 994, 996, 998, 1000

**TDC ARCH DESIGN**  
 110 South Colindale Avenue, London NW9 1PR

www.tdc-arch.design

Client: CB Swift  
 Project: 110 South Colindale Road, London NW9 1PR  
 Drawing No: 01/01/03  
 Drawing Title: Planning and Design  
 Scale: 1:1000  
 Date: 10/01/03  
 Drawn by: AS  
 Checked by: AS  
 Job No: 01/01/03  
 Rev: G

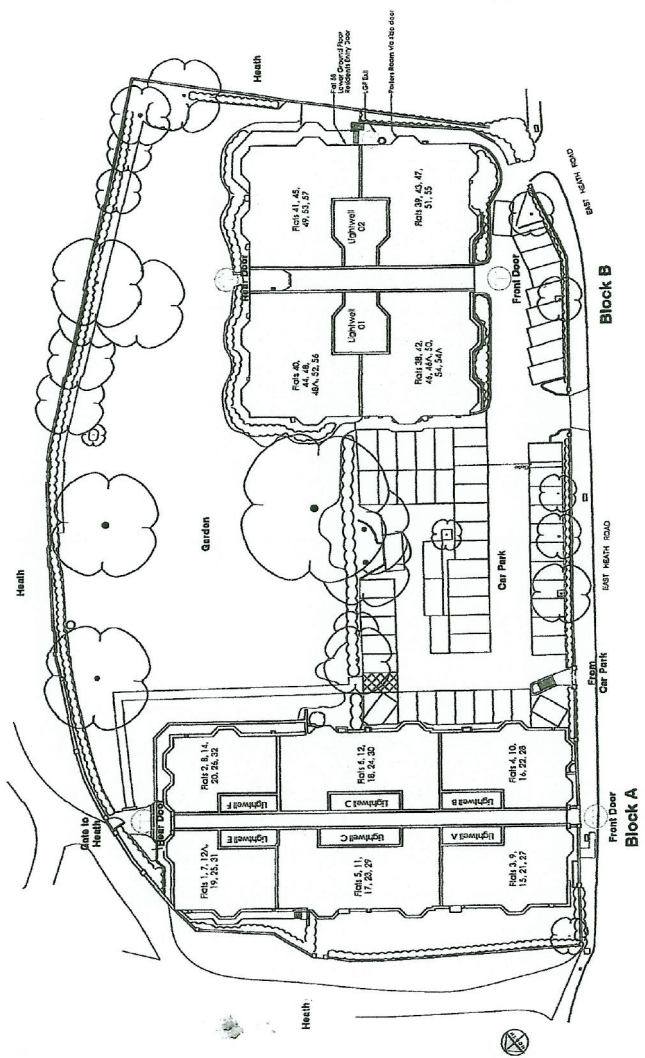

3/

RR.

A