

STATUTORY DECLARATION

I Gilbert Charles Pant
do solemnly and sincerely declare as follows:-

1. I have lived at Flat 19 The Pryors NW3 1BS since June 1997 During this period of time The Pryors has been my permanent residence. I am a Company Director.
2. I attach a copy of an Existing Car Park Layout Plan prepared by TDC-ARCH DESIGN 02.11.2023 (marked 'A') which I believe to be correct.
3. The flat came with the benefit of a long term right to park a vehicle in the Car Park at The Pryors ('the Car Park') which is situated within the grounds of The Pryors.
4. My flat does not overlook the Car Park.
5. I see/use the Car Park almost on a daily basis.
6. I can state to the best of my knowledge and belief that for at least the last 10 years to the present date:-

- A. The perimeter of the Car Park has not been altered.
- B. The surface of the Car Park has not been renewed or altered.
- C. The car space markings within the Car Park have not been altered.
- D. The Car Park has been continuously available for use at The Pryors with 60 car parking spaces.
- E The use of those spaces has been for vehicles of occupiers and users of The Pryors.

and I make this solemn declaration conscientiously believing the same to be true, and by virtue of the provisions of the Statutory Declarations Act 1835

Declared by
(insert signature)



(insert date)

16 December 2023

Before me (insert name and signature)
(Insert address)

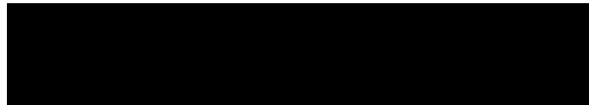

45 CHANCELT LANE London WC2A 1SF

A Solicitor/ Commissioner for Oaths
date)

Date (insert

16 DECEMBER
2023

Notes:

1. All dimensions are in millimetres.
2. All dimensions are to the centre of the wall unless otherwise stated.
3. All dimensions are to the face of the wall unless otherwise stated.
4. All dimensions are to the face of the wall unless otherwise stated.
5. All dimensions are to the face of the wall unless otherwise stated.
6. All dimensions are to the face of the wall unless otherwise stated.
7. All dimensions are to the face of the wall unless otherwise stated.
8. All dimensions are to the face of the wall unless otherwise stated.
9. All dimensions are to the face of the wall unless otherwise stated.
10. All dimensions are to the face of the wall unless otherwise stated.

Room No.	Room Name	Area (sqm)	Volume (cu m)
1	Reception	10.5	10.5
2	Waiting Area	15.0	15.0
3	Office	12.0	12.0
4	Office	12.0	12.0
5	Office	12.0	12.0
6	Office	12.0	12.0
7	Office	12.0	12.0
8	Office	12.0	12.0
9	Office	12.0	12.0
10	Office	12.0	12.0
11	Office	12.0	12.0
12	Office	12.0	12.0
13	Office	12.0	12.0
14	Office	12.0	12.0
15	Office	12.0	12.0
16	Office	12.0	12.0
17	Office	12.0	12.0
18	Office	12.0	12.0
19	Office	12.0	12.0
20	Office	12.0	12.0
21	Office	12.0	12.0
22	Office	12.0	12.0
23	Office	12.0	12.0
24	Office	12.0	12.0
25	Office	12.0	12.0
26	Office	12.0	12.0
27	Office	12.0	12.0
28	Office	12.0	12.0
29	Office	12.0	12.0
30	Office	12.0	12.0
31	Office	12.0	12.0
32	Office	12.0	12.0
33	Office	12.0	12.0
34	Office	12.0	12.0
35	Office	12.0	12.0
36	Office	12.0	12.0
37	Office	12.0	12.0
38	Office	12.0	12.0
39	Office	12.0	12.0
40	Office	12.0	12.0
41	Office	12.0	12.0
42	Office	12.0	12.0
43	Office	12.0	12.0
44	Office	12.0	12.0
45	Office	12.0	12.0
46	Office	12.0	12.0
47	Office	12.0	12.0
48	Office	12.0	12.0
49	Office	12.0	12.0
50	Office	12.0	12.0
51	Office	12.0	12.0
52	Office	12.0	12.0
53	Office	12.0	12.0
54	Office	12.0	12.0
55	Office	12.0	12.0
56	Office	12.0	12.0
57	Office	12.0	12.0
58	Office	12.0	12.0
59	Office	12.0	12.0
60	Office	12.0	12.0
61	Office	12.0	12.0
62	Office	12.0	12.0
63	Office	12.0	12.0
64	Office	12.0	12.0
65	Office	12.0	12.0
66	Office	12.0	12.0
67	Office	12.0	12.0
68	Office	12.0	12.0
69	Office	12.0	12.0
70	Office	12.0	12.0
71	Office	12.0	12.0
72	Office	12.0	12.0
73	Office	12.0	12.0
74	Office	12.0	12.0
75	Office	12.0	12.0
76	Office	12.0	12.0
77	Office	12.0	12.0
78	Office	12.0	12.0
79	Office	12.0	12.0
80	Office	12.0	12.0
81	Office	12.0	12.0
82	Office	12.0	12.0
83	Office	12.0	12.0
84	Office	12.0	12.0
85	Office	12.0	12.0
86	Office	12.0	12.0
87	Office	12.0	12.0
88	Office	12.0	12.0
89	Office	12.0	12.0
90	Office	12.0	12.0
91	Office	12.0	12.0
92	Office	12.0	12.0
93	Office	12.0	12.0
94	Office	12.0	12.0
95	Office	12.0	12.0
96	Office	12.0	12.0
97	Office	12.0	12.0
98	Office	12.0	12.0
99	Office	12.0	12.0
100	Office	12.0	12.0

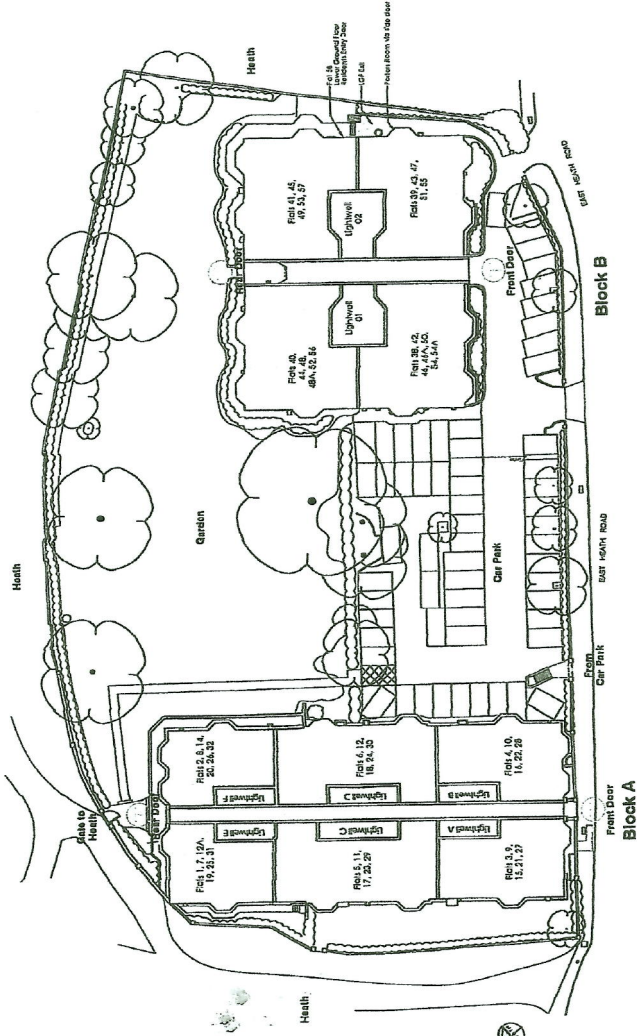

CH Swift
 111, 105, 117, 222, 213
 111, 105, 117, 222, 213
 111, 105, 117, 222, 213



www.dc-archdesign

Client: CB Swift
 Project: Heath, Carl Heath base,
 London, NW3 3BB
 Drawing No: 2/10
 Drawing Title: Building Site Plans Layout
 Date: 20/10/01
 Scale: 1:500
 Drawing No: 2/10
 Date: 20/10/01

Handwritten: Dan A
 B 1 A