

NVB
15/12

STATUTORY DECLARATION

I Nicole Vérat-Pant
do solemnly and sincerely declare as follows:-

1. I have lived at Flat 19 The Pryors NW3 1BS since June 1997 During this period of time The Pryors has been my permanent residence. I am a retired university lecturer.
2. I attach a copy of an Existing Car Park Layout Plan prepared by TDC-ARCH DESIGN 02.11.2023 (marked 'A') which I believe to be correct.
3. The flat came with the benefit of a long term right to park a vehicle in the Car Park at The Pryors ('the Car Park') which is situated within the grounds of The Pryors.
4. My flat does not overlook the Car Park.
5. I see/use the Car Park almost on a daily basis.
6. I can state to the best of my knowledge and belief that for at least the last 10 years to the present date:-

- A. The perimeter of the Car Park has not been altered.
- B. The surface of the Car Park has not been renewed or altered.
- C. The car space markings within the Car Park have not been altered.
- D. The Car Park has been continuously available for use at The Pryors with 60 car parking spaces.
- E The use of those spaces has been for vehicles of occupiers and users of The Pryors.

and I make this solemn declaration conscientiously believing the same to be true, and by virtue of the provisions of the Statutory Declarations Act 1835

Declared by
(insert signature)



16/12/2023

(insert date)

Before me (insert name and signature)
(Insert address)



48 CHANCERY LANE LONDON WC2A 1SR

A Solicitor/ Commissioner for Oaths
date)

Date (Insert

16 DECEMBER

2023

2007 © 2008 LDC ARCH DESIGN, INC.

THIS PLAN IS THE PROPERTY OF LDC ARCH DESIGN, INC. AND IS NOT TO BE REPRODUCED OR TRANSMITTED IN ANY FORM OR BY ANY MEANS, ELECTRONIC OR MECHANICAL, INCLUDING PHOTOCOPYING, RECORDING, OR BY ANY INFORMATION STORAGE AND RETRIEVAL SYSTEM, WITHOUT THE WRITTEN PERMISSION OF LDC ARCH DESIGN, INC.

NO.	DATE	DESCRIPTION	BY	CHKD.
1	10/10/07	CONCEPT PLAN	MD	MD
2	10/10/07	CONCEPT PLAN	MD	MD
3	10/10/07	CONCEPT PLAN	MD	MD
4	10/10/07	CONCEPT PLAN	MD	MD
5	10/10/07	CONCEPT PLAN	MD	MD
6	10/10/07	CONCEPT PLAN	MD	MD
7	10/10/07	CONCEPT PLAN	MD	MD
8	10/10/07	CONCEPT PLAN	MD	MD
9	10/10/07	CONCEPT PLAN	MD	MD
10	10/10/07	CONCEPT PLAN	MD	MD
11	10/10/07	CONCEPT PLAN	MD	MD
12	10/10/07	CONCEPT PLAN	MD	MD
13	10/10/07	CONCEPT PLAN	MD	MD
14	10/10/07	CONCEPT PLAN	MD	MD
15	10/10/07	CONCEPT PLAN	MD	MD
16	10/10/07	CONCEPT PLAN	MD	MD
17	10/10/07	CONCEPT PLAN	MD	MD
18	10/10/07	CONCEPT PLAN	MD	MD
19	10/10/07	CONCEPT PLAN	MD	MD
20	10/10/07	CONCEPT PLAN	MD	MD
21	10/10/07	CONCEPT PLAN	MD	MD
22	10/10/07	CONCEPT PLAN	MD	MD
23	10/10/07	CONCEPT PLAN	MD	MD
24	10/10/07	CONCEPT PLAN	MD	MD
25	10/10/07	CONCEPT PLAN	MD	MD
26	10/10/07	CONCEPT PLAN	MD	MD
27	10/10/07	CONCEPT PLAN	MD	MD
28	10/10/07	CONCEPT PLAN	MD	MD
29	10/10/07	CONCEPT PLAN	MD	MD
30	10/10/07	CONCEPT PLAN	MD	MD
31	10/10/07	CONCEPT PLAN	MD	MD
32	10/10/07	CONCEPT PLAN	MD	MD
33	10/10/07	CONCEPT PLAN	MD	MD
34	10/10/07	CONCEPT PLAN	MD	MD
35	10/10/07	CONCEPT PLAN	MD	MD
36	10/10/07	CONCEPT PLAN	MD	MD
37	10/10/07	CONCEPT PLAN	MD	MD
38	10/10/07	CONCEPT PLAN	MD	MD
39	10/10/07	CONCEPT PLAN	MD	MD
40	10/10/07	CONCEPT PLAN	MD	MD
41	10/10/07	CONCEPT PLAN	MD	MD
42	10/10/07	CONCEPT PLAN	MD	MD
43	10/10/07	CONCEPT PLAN	MD	MD
44	10/10/07	CONCEPT PLAN	MD	MD
45	10/10/07	CONCEPT PLAN	MD	MD
46	10/10/07	CONCEPT PLAN	MD	MD
47	10/10/07	CONCEPT PLAN	MD	MD
48	10/10/07	CONCEPT PLAN	MD	MD
49	10/10/07	CONCEPT PLAN	MD	MD
50	10/10/07	CONCEPT PLAN	MD	MD
51	10/10/07	CONCEPT PLAN	MD	MD
52	10/10/07	CONCEPT PLAN	MD	MD
53	10/10/07	CONCEPT PLAN	MD	MD
54	10/10/07	CONCEPT PLAN	MD	MD
55	10/10/07	CONCEPT PLAN	MD	MD
56	10/10/07	CONCEPT PLAN	MD	MD
57	10/10/07	CONCEPT PLAN	MD	MD
58	10/10/07	CONCEPT PLAN	MD	MD
59	10/10/07	CONCEPT PLAN	MD	MD
60	10/10/07	CONCEPT PLAN	MD	MD
61	10/10/07	CONCEPT PLAN	MD	MD
62	10/10/07	CONCEPT PLAN	MD	MD
63	10/10/07	CONCEPT PLAN	MD	MD
64	10/10/07	CONCEPT PLAN	MD	MD
65	10/10/07	CONCEPT PLAN	MD	MD
66	10/10/07	CONCEPT PLAN	MD	MD
67	10/10/07	CONCEPT PLAN	MD	MD
68	10/10/07	CONCEPT PLAN	MD	MD
69	10/10/07	CONCEPT PLAN	MD	MD
70	10/10/07	CONCEPT PLAN	MD	MD
71	10/10/07	CONCEPT PLAN	MD	MD
72	10/10/07	CONCEPT PLAN	MD	MD
73	10/10/07	CONCEPT PLAN	MD	MD
74	10/10/07	CONCEPT PLAN	MD	MD
75	10/10/07	CONCEPT PLAN	MD	MD
76	10/10/07	CONCEPT PLAN	MD	MD
77	10/10/07	CONCEPT PLAN	MD	MD
78	10/10/07	CONCEPT PLAN	MD	MD
79	10/10/07	CONCEPT PLAN	MD	MD
80	10/10/07	CONCEPT PLAN	MD	MD
81	10/10/07	CONCEPT PLAN	MD	MD
82	10/10/07	CONCEPT PLAN	MD	MD
83	10/10/07	CONCEPT PLAN	MD	MD
84	10/10/07	CONCEPT PLAN	MD	MD
85	10/10/07	CONCEPT PLAN	MD	MD
86	10/10/07	CONCEPT PLAN	MD	MD
87	10/10/07	CONCEPT PLAN	MD	MD
88	10/10/07	CONCEPT PLAN	MD	MD
89	10/10/07	CONCEPT PLAN	MD	MD
90	10/10/07	CONCEPT PLAN	MD	MD
91	10/10/07	CONCEPT PLAN	MD	MD
92	10/10/07	CONCEPT PLAN	MD	MD
93	10/10/07	CONCEPT PLAN	MD	MD
94	10/10/07	CONCEPT PLAN	MD	MD
95	10/10/07	CONCEPT PLAN	MD	MD
96	10/10/07	CONCEPT PLAN	MD	MD
97	10/10/07	CONCEPT PLAN	MD	MD
98	10/10/07	CONCEPT PLAN	MD	MD
99	10/10/07	CONCEPT PLAN	MD	MD
100	10/10/07	CONCEPT PLAN	MD	MD

CB Swift
 ARCHITECTS AND INTERIORS
 100 WEST 25TH ST
 NEW YORK, NY 10011
 TEL: 212 693 2218
 FAX: 212 693 2218

LDC ARCH DESIGN
 THE STYLING ARCHITECTURE FIRM
 www ldc arch design

Client: C3 Hill
 Project: East Heath Road, London, NY 100
 Drawing No: 20080101
 Drawing Title: Building Car Park Layout
 Scale: 1/8" = 1'-0"
 Date: 10/10/07
 Drawn by: MD
 Checked by: MD
 Project No: 20080101
 Drawing No: 20080101 G

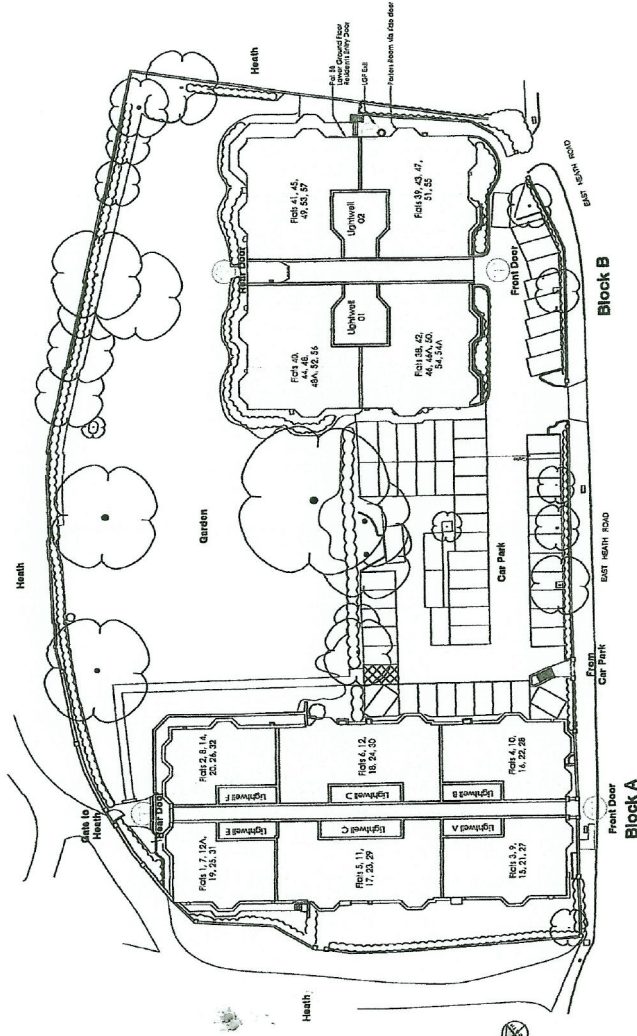

MD
 BIA
 A