

**STATUTORY DECLARATION**

I Joan Margaret Noble  
do solemnly and sincerely declare as follows:-

1. I have lived at Flat 20 The Pryors NW31BS since December 1993 During this period of time The Pryors has been my permanent residence. I am a retired medical researcher.I retired in 2008.
2. I attach a copy of an Existing Car Park Layout Plan prepared by TDC-ARCH DESIGN 02.11.2023 (marked 'A') which I believe to be correct.
3. The flat did not come with the benefit to park a vehicle in the Car Park at The Pryors ('the Car Park') which is situated within the grounds of The Pryors. However my husband subsequently purchased a long term licence to park a vehicle in the Car Park on the 10.05.95.
4. My flat overlooks the Car Park.
5. I see/use the Car Park almost on a daily basis.
6. I can state to the best of my knowledge and belief that for at least the last 10 years to the present date:-

- A. The perimeter of the Car Park has not been altered.
- B. The surface of the Car Park has not been renewed or altered.
- C. The car space markings within the Car Park have not been altered.
- D. The Car Park has been continuously available for use at The Pryors with 60 car parking spaces.
- E The use of those spaces has been for vehicles of occupiers and users of The Pryors.

and I make this solemn declaration conscientiously believing the same to be true, and by virtue of the provisions of the Statutory Declarations Act 1835

Declared by Joan Margaret Noble  
(insert signature)

[Redacted Signature]

(insert date)

12/12/23

Before me (insert name and signature)  
(Insert address)

[Redacted Name]

RACHEL KAPILA  
CLOTH FAIR CHAMBERS  
39-40 CLOTH FAIR Date (Insert  
EC1A 7NT

A Solicitor/ Commissioner for Oaths  
(date)

12.12.23 .

NOTE: 1. All dimensions are in millimeters unless otherwise stated.  
 2. All dimensions are to the centerline of the wall unless otherwise stated.  
 3. All dimensions are to the finished floor level unless otherwise stated.  
 4. All dimensions are to the finished ground level unless otherwise stated.  
 5. All dimensions are to the finished ceiling level unless otherwise stated.  
 6. All dimensions are to the finished floor level unless otherwise stated.

NO.	DESCRIPTION	UNIT	QTY
1	CEILING	SQ. METERS	100.00
2	FLOOR	SQ. METERS	100.00
3	WALL	SQ. METERS	100.00
4	DOOR	NO.	10
5	WINDOW	NO.	10
6	STAIR	SQ. METERS	10.00
7	ROOF	SQ. METERS	10.00
8	GLASS	SQ. METERS	10.00
9	PAINT	SQ. METERS	10.00
10	PLASTER	SQ. METERS	10.00
11	CONCRETE	SQ. METERS	10.00
12	BRICK	SQ. METERS	10.00
13	TILE	SQ. METERS	10.00
14	IRON	SQ. METERS	10.00
15	STEEL	SQ. METERS	10.00
16	WOOD	SQ. METERS	10.00
17	GLASS	SQ. METERS	10.00
18	PAINT	SQ. METERS	10.00
19	PLASTER	SQ. METERS	10.00
20	CONCRETE	SQ. METERS	10.00
21	BRICK	SQ. METERS	10.00
22	TILE	SQ. METERS	10.00
23	IRON	SQ. METERS	10.00
24	STEEL	SQ. METERS	10.00
25	WOOD	SQ. METERS	10.00
26	GLASS	SQ. METERS	10.00
27	PAINT	SQ. METERS	10.00
28	PLASTER	SQ. METERS	10.00
29	CONCRETE	SQ. METERS	10.00
30	BRICK	SQ. METERS	10.00
31	TILE	SQ. METERS	10.00
32	IRON	SQ. METERS	10.00
33	STEEL	SQ. METERS	10.00
34	WOOD	SQ. METERS	10.00
35	GLASS	SQ. METERS	10.00
36	PAINT	SQ. METERS	10.00
37	PLASTER	SQ. METERS	10.00
38	CONCRETE	SQ. METERS	10.00
39	BRICK	SQ. METERS	10.00
40	TILE	SQ. METERS	10.00
41	IRON	SQ. METERS	10.00
42	STEEL	SQ. METERS	10.00
43	WOOD	SQ. METERS	10.00
44	GLASS	SQ. METERS	10.00
45	PAINT	SQ. METERS	10.00
46	PLASTER	SQ. METERS	10.00
47	CONCRETE	SQ. METERS	10.00
48	BRICK	SQ. METERS	10.00
49	TILE	SQ. METERS	10.00
50	IRON	SQ. METERS	10.00

www.1dc-arch-design  
 1DC ARCH DESIGN  
 THE SINGLE SOURCE FOR ARCHITECTURAL DESIGN

CB Switt  
 Project Manager  
 Tel: 0208 877 2218

Architect  
 1DC ARCH DESIGN  
 1001 25000000  
 1001 25000000

Client: CB Switt  
 Project: 1DC Arch Design with head.  
 Location: 1001 25000000  
 Building: Existing Car Park/Landfill  
 All Recorded  
 Scale: 1:500  
 Drawing: 01  
 Date: 20/11/2023  
 Drawn by: 1DC  
 Checked by: 1DC  
 No: S211037 A(1995) 1 G

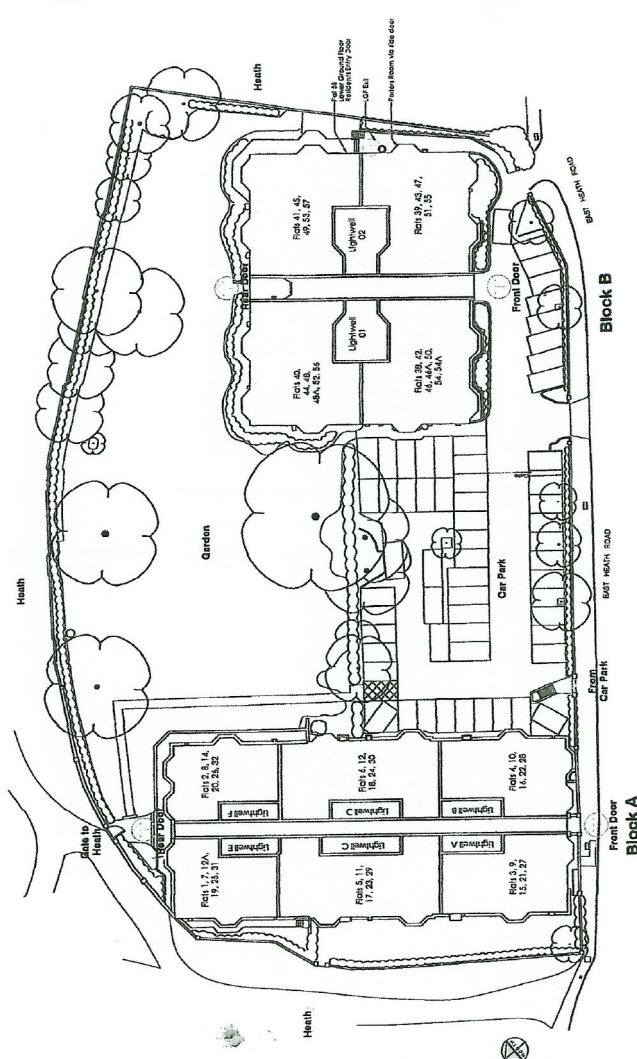

Handwritten initials: 'JR' and 'RR'.

Handwritten symbol: a stylized 'A' with a diagonal line through it.