

STATUTORY DECLARATION

I John Watson
do solemnly and sincerely declare as follows:-

1. I have lived at Flat 28 The Pryors NW31BS since 1995. During this period of time The Pryors has been my permanent residence. I am a retired investment banker
2. I attach a copy of an Existing Car Park Layout Plan prepared by TDC-ARCH DESIGN 02.11.2023 (marked 'A') which I believe to be correct.
3. The flat came with the benefit to park a vehicle in the Car Park at The Pryors ('the Car Park') which is situated within the grounds of The Pryors.
4. My flat overlooks the Car Park.
5. I use the Car Park almost on a daily basis.
6. I can state to the best of my knowledge and belief that for at least the last 10 years to the present date:-
 - A. The perimeter of the Car Park has not been altered.
 - B. The surface of the Car Park has not been renewed or altered.
 - C. The car space markings within the Car Park have not been altered.
 - D. The Car Park has been continuously available for use at The Pryors with 60 car parking spaces.
 - E The use of those spaces has been for vehicles of occupiers and users of The Pryors.

and I make this solemn declaration conscientiously believing the same to be true, and by virtue of the provisions of the Statutory Declarations Act 1835

Declared by John Watson
(insert signature)

(insert date)

Before me (insert name and signature)

(Insert address) CAROLINE ALEXANDRA PRINGLE
58 MORRISON STREET
EDINBURGH EH3 8BP

A Solicitor/ Commissioner for Oaths
date)

Date (insert

4 January 2024

Room No.	Description	Area (sq. m)	Area (sq. ft)
1	RECEPTION	18	194
2	OFFICE	15	161
3	OFFICE	15	161
4	OFFICE	15	161
5	OFFICE	15	161
6	OFFICE	15	161
7	OFFICE	15	161
8	OFFICE	15	161
9	OFFICE	15	161
10	OFFICE	15	161
11	OFFICE	15	161
12	OFFICE	15	161
13	OFFICE	15	161
14	OFFICE	15	161
15	OFFICE	15	161
16	OFFICE	15	161
17	OFFICE	15	161
18	OFFICE	15	161
19	OFFICE	15	161
20	OFFICE	15	161
21	OFFICE	15	161
22	OFFICE	15	161
23	OFFICE	15	161
24	OFFICE	15	161
25	OFFICE	15	161
26	OFFICE	15	161
27	OFFICE	15	161
28	OFFICE	15	161
29	OFFICE	15	161
30	OFFICE	15	161
31	OFFICE	15	161
32	OFFICE	15	161
33	OFFICE	15	161
34	OFFICE	15	161
35	OFFICE	15	161
36	OFFICE	15	161
37	OFFICE	15	161
38	OFFICE	15	161
39	OFFICE	15	161
40	OFFICE	15	161
41	OFFICE	15	161
42	OFFICE	15	161
43	OFFICE	15	161
44	OFFICE	15	161
45	OFFICE	15	161
46	OFFICE	15	161
47	OFFICE	15	161
48	OFFICE	15	161
49	OFFICE	15	161
50	OFFICE	15	161

South House
 200 Wood Lane
 London, W9 3HS
 020 8996 1234
 www.cb-smiff.com

CB Smiff
 Project Management
 The Old Mill, Wood Lane
 London, W9 3HS
 Tel: 020 8996 1234

IPC ARCH DESIGN
 THE DESIGN ARCHITECTS

www.ipc-arch.design

Client
 CB Smiff

Project
 Reception, Care Health Road,
 London, W9 3HS

Drawing No.
 B1/02 - Car Park Layout

Issue No.
 2/01

Issue Description
 Issue 2/01 - Final

Date
 22/01/05

Scale
 1:500

Sheet No.
 32/1037

Scale
 A1/1750

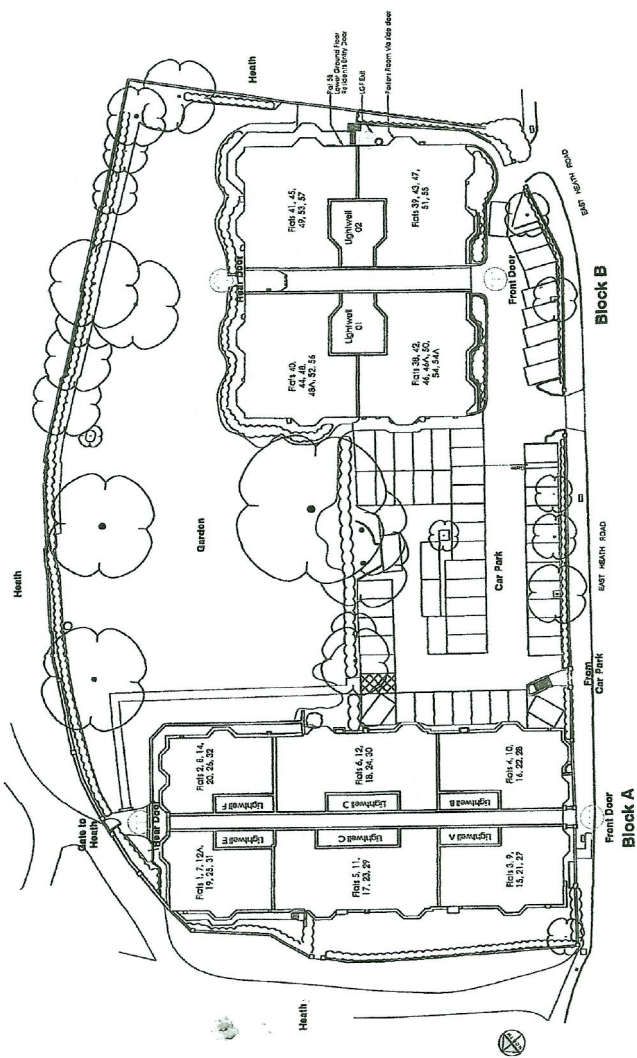

A1

CP