

STATUTORY DECLARATION

I Kristof Neys
do solemnly and sincerely declare as follows:-

1. I have lived at Flat 46A The Pryors NW31BP since 2004. During this period of time The Pryors has been my permanent residence. I am a Director- Graph Data Science
2. I attach a copy of an Existing Car Park Layout Plan prepared by TDC-ARCH DESIGN 02.11.2023 (marked 'A') which I believe to be correct.
3. The flat came with the benefit of a long term right to park a vehicle in the Car Park at The Pryors ('the Car Park') which is situated within the grounds of The Pryors.
4. My flat overlooks the Car Park.
5. I see the Car Park almost on a daily basis.
6. I can state to the best of my knowledge and belief that for at least the last 10 years to the present date:-

- A. The perimeter of the Car Park has not been altered.
- B. The surface of the Car Park has not been renewed or altered.
- C. The car space markings within the Car Park have not been altered.
- D. The Car Park has been continuously available for use at The Pryors with 60 car parking spaces.
- E. The use of those spaces has been for vehicles of occupiers and users of The Pryors.

and I make this solemn declaration conscientiously believing the same to be true, and by virtue of the provisions of the Statutory Declarations Act 1835

Declared by Kristof Neys
(insert signature)

(insert date) 21/12/2023

Before me (insert name and signature)
(insert address)

A Solicitor/ Commissioner for Oaths
(date)

Date (insert

21 Dec 2023

B. M. H. Shaw - Solicitor
Solomon Taylor & Shaw
3 Coach House Yard
Hampstead High Street
London NW3 1QF
Tel: [redacted]

3.000

NO.	DESCRIPTION	DATE	BY
1	ISSUED FOR PERMITTING	11/14/12	WJ
2	ISSUED FOR PERMITTING	11/14/12	WJ
3	ISSUED FOR PERMITTING	11/14/12	WJ
4	ISSUED FOR PERMITTING	11/14/12	WJ
5	ISSUED FOR PERMITTING	11/14/12	WJ
6	ISSUED FOR PERMITTING	11/14/12	WJ
7	ISSUED FOR PERMITTING	11/14/12	WJ
8	ISSUED FOR PERMITTING	11/14/12	WJ
9	ISSUED FOR PERMITTING	11/14/12	WJ
10	ISSUED FOR PERMITTING	11/14/12	WJ
11	ISSUED FOR PERMITTING	11/14/12	WJ
12	ISSUED FOR PERMITTING	11/14/12	WJ
13	ISSUED FOR PERMITTING	11/14/12	WJ
14	ISSUED FOR PERMITTING	11/14/12	WJ
15	ISSUED FOR PERMITTING	11/14/12	WJ
16	ISSUED FOR PERMITTING	11/14/12	WJ
17	ISSUED FOR PERMITTING	11/14/12	WJ
18	ISSUED FOR PERMITTING	11/14/12	WJ
19	ISSUED FOR PERMITTING	11/14/12	WJ
20	ISSUED FOR PERMITTING	11/14/12	WJ
21	ISSUED FOR PERMITTING	11/14/12	WJ
22	ISSUED FOR PERMITTING	11/14/12	WJ
23	ISSUED FOR PERMITTING	11/14/12	WJ
24	ISSUED FOR PERMITTING	11/14/12	WJ
25	ISSUED FOR PERMITTING	11/14/12	WJ
26	ISSUED FOR PERMITTING	11/14/12	WJ
27	ISSUED FOR PERMITTING	11/14/12	WJ
28	ISSUED FOR PERMITTING	11/14/12	WJ
29	ISSUED FOR PERMITTING	11/14/12	WJ
30	ISSUED FOR PERMITTING	11/14/12	WJ

WWW:dc-archdesign

Client: CB Swill

Project: The North, Condo in Hotel

Location: 1100 N. 1st St., Suite 1100, Washington, DC 20002

Design: CB Swill

Architect: TDC ARCH DESIGN

The design consists of 771 sq ft

WWW:dc-archdesign

Client: CB Swill

Project: The North, Condo in Hotel

Location: 1100 N. 1st St., Suite 1100, Washington, DC 20002

Design: CB Swill

Architect: TDC ARCH DESIGN

The design consists of 771 sq ft

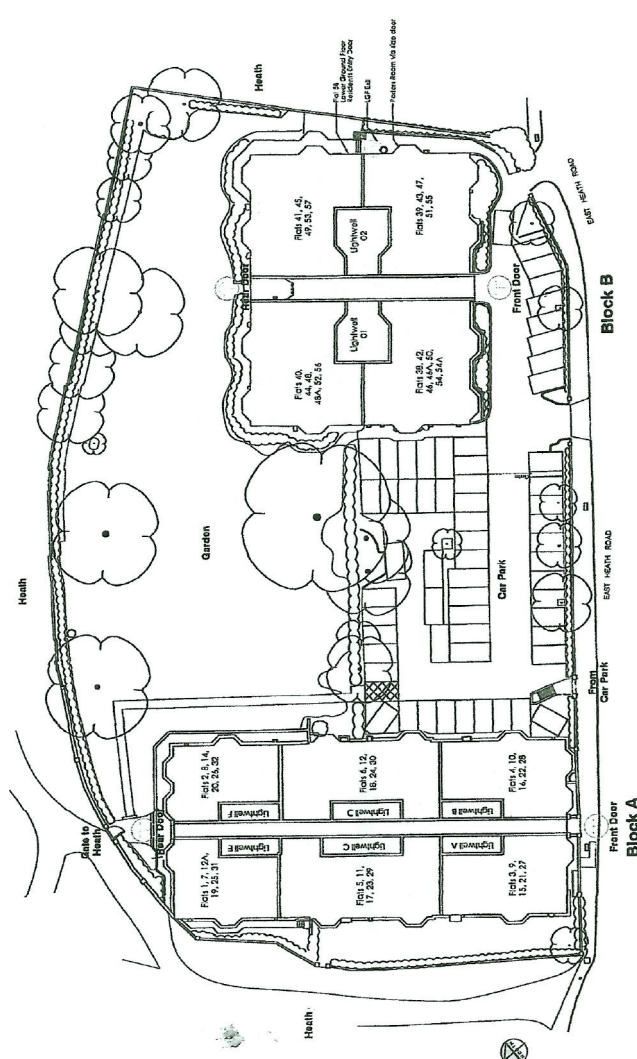

[Handwritten signature]

BANK RO
 BANSHAD
 21/12/2013

[Handwritten mark]