

**STATUTORY DECLARATION**

I Mr Anthony Julian Cole  
do solemnly and sincerely declare as follows:-

- 1. I purchased Flat 54A The Pryors NW31BP in August 1986. Since then The Pryors has been the London home of me and my wife. I am a retired banker.
- 2. I attach a copy of an Existing Car Park Layout Plan prepared by TDC-ARCH DESIGN 02.11.2023 (marked 'A') which I believe to be correct.
- 3. In June 1991, I purchased a long term right to park a vehicle in the Car Park at The Pryors ('the Car Park') which is situated within the grounds of The Pryors.
- 4. My flat overlooks the Car Park.
- 5. I have seen and used the Car Park on a regular and repeated basis since 1986.
- 6. I can state to the best of my knowledge and belief that for at least the last 10 years to the present date:-

- A. The perimeter of the Car Park has not been altered.
- B. The surface of the Car Park has not been renewed or altered.
- C. The car space markings within the Car Park have not been altered.
- D. The Car Park has been continuously available for use at The Pryors with 60 car parking spaces.
- E The use of those spaces has been for vehicles of occupiers and users of The Pryors.

and I make this solemn declaration conscientiously believing the same to be true, and by virtue of the provisions of the Statutory Declarations Act 1835

Declared by Anthony Julian Cole

*(insert signature)*



*(insert date)*

12/12/2023

Before me *(insert name and signature)*

*(Insert address)*



RACHEL KAPILA  
CLOTH FAIR CHAMBERS  
39-40 CLOTH FAIR, EC1A 7NT  
Date *(insert*

A Solicitor/ Commissioner for Oaths  
*date)*

12.12.23.

200

201

202

203

204

205

206

207

208

209

210

211

212

213

214

215

216

217

218

219

220

221

222

223

224

225

226

227

228

229

230

231

232

233

234

235

236

237

238

239

240

241

242

243

244

245

246

247

248

249

250

251

252

253

254

255

256

257

258

259

260

261

262

263

264

265

266

267

268

269

270

271

272

273

274

275

276

277

278

279

280

281

282

283

284

285

286

287

288

289

290

291

292

293

294

295

296

297

298

299

300

pk.

A

200

201

202

203

204

205

206

207

208

209

210

211

212

213

214

215

216

217

218

219

220

221

222

223

224

225

226

227

228

229

230

231

232

233

234

235

236

237

238

239

240

241

242

243

244

245

246

247

248

249

250

251

252

253

254

255

256

257

258

259

260

261

262

263

264

265

266

267

268

269

270

271

272

273

274

275

276

277

278

279

280

281

282

283

284

285

286

287

288

289

290

291

292

293

294

295

296

297

298

299

300

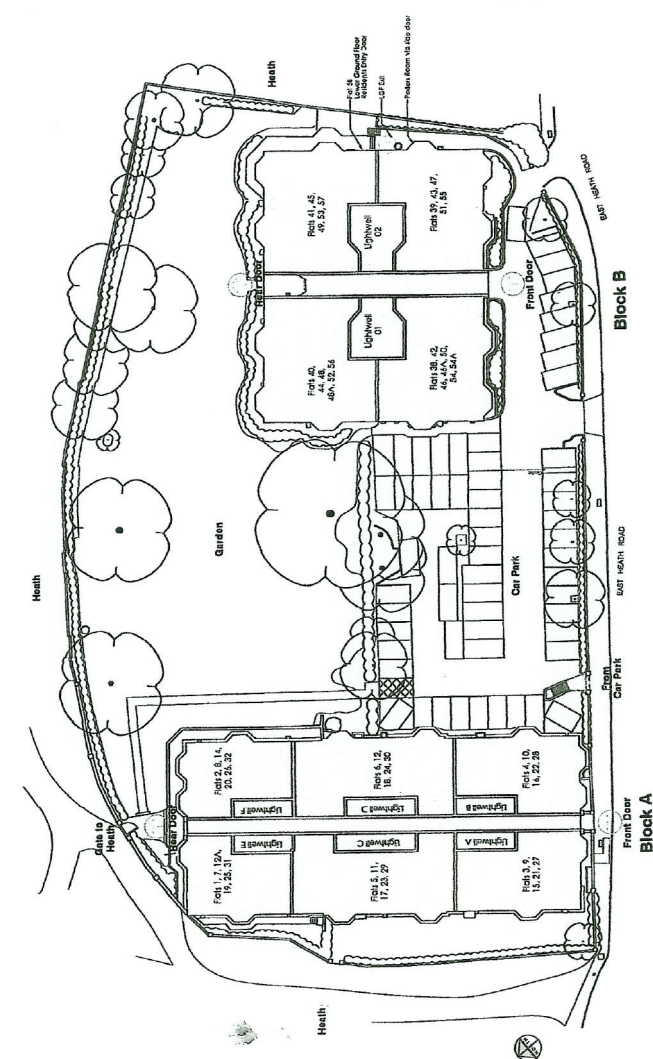

200

201

202

203

204

205

206

207

208

209

210

211

212

213

214

215

216

217

218

219

220

221

222

223

224

225

226

227

228

229

230

231

232

233

234

235

236

237

238

239

240

241

242

243

244

245

246

247

248

249

250

251

252

253

254

255

256

257

258

259

260

261

262

263

264

265

266

267

268

269

270

271

272

273

274

275

276

277

278

279

280

281

282

283

284

285

286

287

288

289

290

291

292

293

294

295

296

297

298

299

300



www.tdc-arch.design

Client: CB Swift

Project: New Health Road, London, W3 1BS

Site No: 201/202

Building Code: Part L2000

Energy Standard: Part L2000

Drawn by: [Name]

Job No: 201/202

Rev: A1/1990 G

200

201

202

203

204

205

206

207

208

209

210

211

212

213

214

215

216

217

218

219

220

221

222

223

224

225

226

227

228

229

230

231

232

233

234

235

236

237

238

239

240

241

242

243

244

245

246

247

248

249

250

251

252

253

254

255

256

257

258

259

260

261

262

263

264

265

266

267

268

269

270

271

272

273

274

275

276

277

278

279

280

281

282

283

284

285

286

287

288

289

290

291

292

293

294

295

296

297

298

299

300