

STATUTORY DECLARATION

I George Anthony Browning
do solemnly and sincerely declare as follows:-

1. I have lived at Flat 50 The Pryors NW31BP since about 1988. During this period of time The Pryors has been my permanent residence. I am a retired solicitor of the Supreme Court.
2. I attach a copy of an Existing Car Park Layout Plan prepared by TDC-ARCH DESIGN 02.11.2023 (marked 'A') which I believe to be correct.
3. The flat came with the benefit to park a vehicle in the Car Park at The Pryors ('the Car Park') which is situated within the grounds of The Pryors.
4. My flat overlooks the Car Park.
5. I see/use the Car Park almost on a daily basis.
6. I can state to the best of my knowledge and belief that for at least the last 10 years to the present date:-

- A. The perimeter of the Car Park has not been altered.
- B. The surface of the Car Park has not been renewed or altered.
- C. The car space markings within the Car Park have not been altered.
- D. The Car Park has been continuously available for use at The Pryors with 60 car parking spaces.
- E The use of those spaces has been for vehicles of occupiers and users of The Pryors.

and I make this solemn declaration conscientiously believing the same to be true, and by virtue of the provisions of the Statutory Declarations Act 1835

Declared by George Anthony Browning
(insert signature)

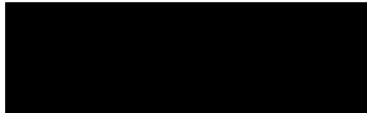

(insert date)

12th Dec 2023

Before me (insert name and signature)
(Insert address)



RACHEL KAPILA
CLOTH FAIR CHAMBERS
39-40 CLOTH FAIR Date (insert
ECIA TNT

A Solicitor/ Commissioner for Oaths
date)

12.12.23

1. To be used in conjunction with the...
 2. To be used in conjunction with the...
 3. To be used in conjunction with the...
 4. To be used in conjunction with the...
 5. To be used in conjunction with the...
 6. To be used in conjunction with the...
 7. To be used in conjunction with the...
 8. To be used in conjunction with the...
 9. To be used in conjunction with the...
 10. To be used in conjunction with the...

| Room No. | Room Name | Area (sqm) | Volume (cu m) |
|----------|-----------|------------|---------------|
| 1 | ... | ... | ... |
| 2 | ... | ... | ... |
| 3 | ... | ... | ... |
| 4 | ... | ... | ... |
| 5 | ... | ... | ... |
| 6 | ... | ... | ... |
| 7 | ... | ... | ... |
| 8 | ... | ... | ... |
| 9 | ... | ... | ... |
| 10 | ... | ... | ... |

11. To be used in conjunction with the...
 12. To be used in conjunction with the...
 13. To be used in conjunction with the...
 14. To be used in conjunction with the...
 15. To be used in conjunction with the...
 16. To be used in conjunction with the...
 17. To be used in conjunction with the...
 18. To be used in conjunction with the...
 19. To be used in conjunction with the...
 20. To be used in conjunction with the...

CB Swift
 Project Management
 100, 102, 104, 106, 108, 110, 112, 114, 116, 118, 120, 122, 124, 126, 128, 130, 132, 134, 136, 138, 140, 142, 144, 146, 148, 150, 152, 154, 156, 158, 160, 162, 164, 166, 168, 170, 172, 174, 176, 178, 180, 182, 184, 186, 188, 190, 192, 194, 196, 198, 200, 202, 204, 206, 208, 210, 212, 214, 216, 218, 220, 222, 224, 226, 228, 230, 232, 234, 236, 238, 240, 242, 244, 246, 248, 250, 252, 254, 256, 258, 260, 262, 264, 266, 268, 270, 272, 274, 276, 278, 280, 282, 284, 286, 288, 290, 292, 294, 296, 298, 300, 302, 304, 306, 308, 310, 312, 314, 316, 318, 320, 322, 324, 326, 328, 330, 332, 334, 336, 338, 340, 342, 344, 346, 348, 350, 352, 354, 356, 358, 360, 362, 364, 366, 368, 370, 372, 374, 376, 378, 380, 382, 384, 386, 388, 390, 392, 394, 396, 398, 400, 402, 404, 406, 408, 410, 412, 414, 416, 418, 420, 422, 424, 426, 428, 430, 432, 434, 436, 438, 440, 442, 444, 446, 448, 450, 452, 454, 456, 458, 460, 462, 464, 466, 468, 470, 472, 474, 476, 478, 480, 482, 484, 486, 488, 490, 492, 494, 496, 498, 500, 502, 504, 506, 508, 510, 512, 514, 516, 518, 520, 522, 524, 526, 528, 530, 532, 534, 536, 538, 540, 542, 544, 546, 548, 550, 552, 554, 556, 558, 560, 562, 564, 566, 568, 570, 572, 574, 576, 578, 580, 582, 584, 586, 588, 590, 592, 594, 596, 598, 600, 602, 604, 606, 608, 610, 612, 614, 616, 618, 620, 622, 624, 626, 628, 630, 632, 634, 636, 638, 640, 642, 644, 646, 648, 650, 652, 654, 656, 658, 660, 662, 664, 666, 668, 670, 672, 674, 676, 678, 680, 682, 684, 686, 688, 690, 692, 694, 696, 698, 700, 702, 704, 706, 708, 710, 712, 714, 716, 718, 720, 722, 724, 726, 728, 730, 732, 734, 736, 738, 740, 742, 744, 746, 748, 750, 752, 754, 756, 758, 760, 762, 764, 766, 768, 770, 772, 774, 776, 778, 780, 782, 784, 786, 788, 790, 792, 794, 796, 798, 800, 802, 804, 806, 808, 810, 812, 814, 816, 818, 820, 822, 824, 826, 828, 830, 832, 834, 836, 838, 840, 842, 844, 846, 848, 850, 852, 854, 856, 858, 860, 862, 864, 866, 868, 870, 872, 874, 876, 878, 880, 882, 884, 886, 888, 890, 892, 894, 896, 898, 900, 902, 904, 906, 908, 910, 912, 914, 916, 918, 920, 922, 924, 926, 928, 930, 932, 934, 936, 938, 940, 942, 944, 946, 948, 950, 952, 954, 956, 958, 960, 962, 964, 966, 968, 970, 972, 974, 976, 978, 980, 982, 984, 986, 988, 990, 992, 994, 996, 998, 1000.

21. To be used in conjunction with the...
 22. To be used in conjunction with the...
 23. To be used in conjunction with the...
 24. To be used in conjunction with the...
 25. To be used in conjunction with the...
 26. To be used in conjunction with the...
 27. To be used in conjunction with the...
 28. To be used in conjunction with the...
 29. To be used in conjunction with the...
 30. To be used in conjunction with the...



www.wide-arch.design

Client: CB Swift
 Project: Project, Carl (Health Wood)
 Location: Weymouth, Dorset, DT98 3LH
 Drawing Title: Building C-Cor Floor Layout
 Drawing No: A1 (Revised)
 Scale: 1:500
 Date: 20/10/2014
 Drawn By: [Name]
 Checked By: [Name]
 Job No: 5211037
 Ref: ALP9501
 Rev: G

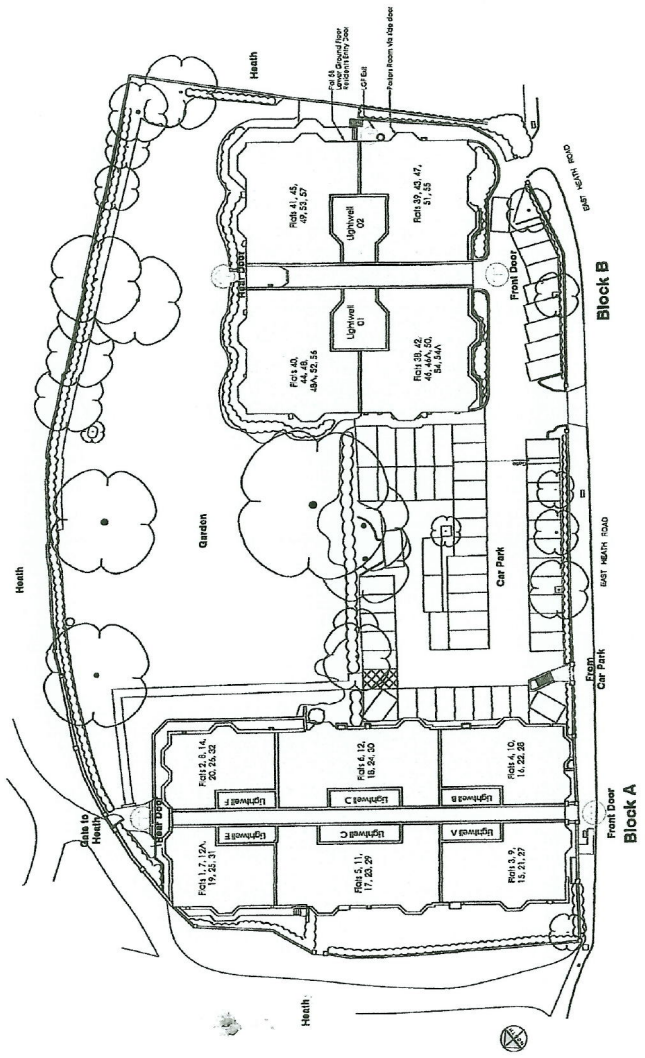

[Handwritten signature]
 RR

[Handwritten mark resembling the number 4]