

1 Ground Floor Plan-Existing & Demolition
1:100

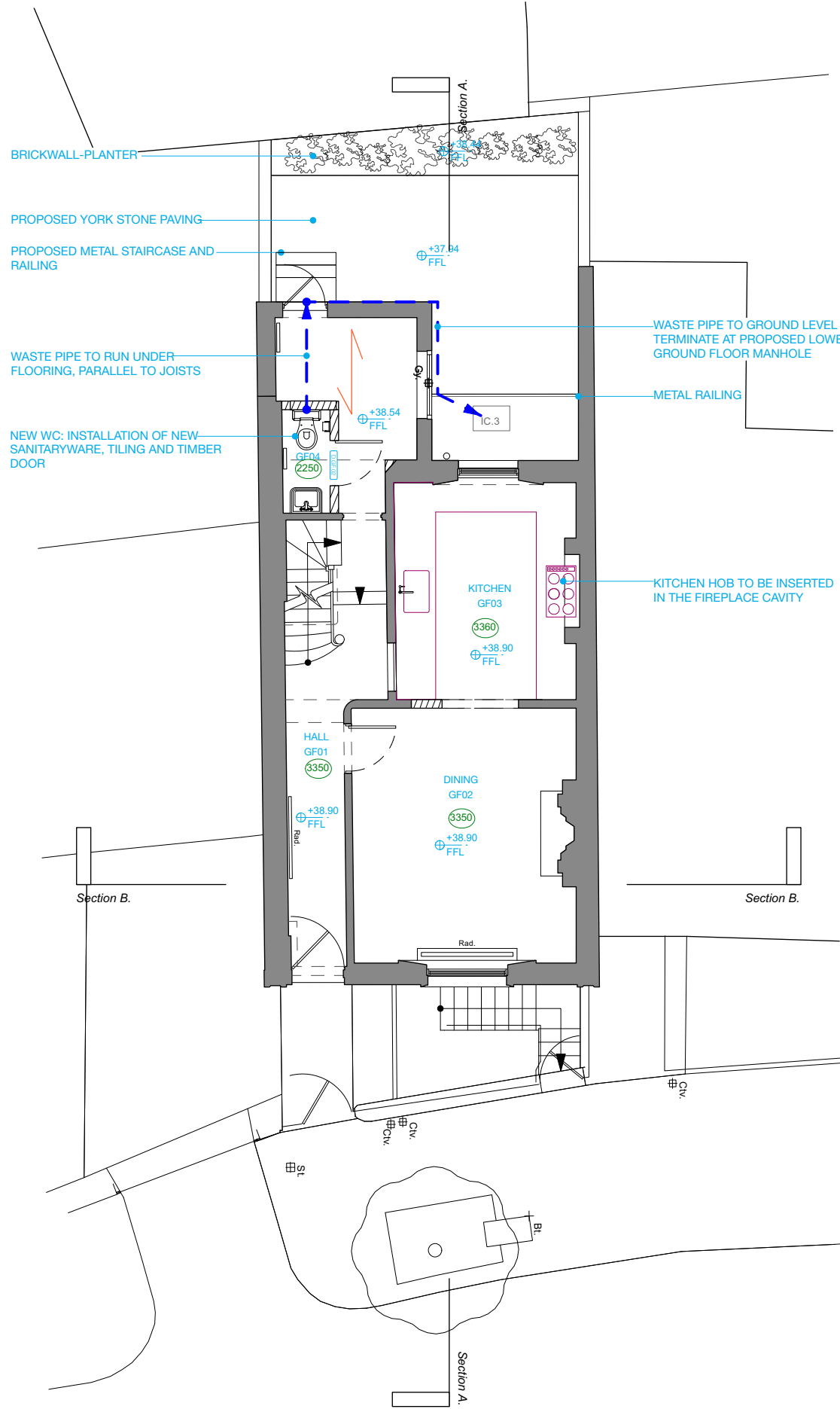

2 Ground Floor Plan-Proposed
1:100

© This drawing is the property of Miltiadou Cook Mitzman architects. No disclosure or copy of it may be made without the written permission of Miltiadou Cook Mitzman architects.

For construction purposes:

- Do not scale this drawing.
- All dimensions and levels to be checked on site.
- Discrepancies to be reported to Miltiadou Cook Mitzman architects before proceeding.
- If in any doubt about information on this drawing contact Miltiadou Cook Mitzman architects.

REVISION	NUMBER	DATE	BY	NOTES
	P1	02/02/2024	OS	Issued for planning
	P2	15/05/2024	OS	Issued revisions for planning

	PROPOSED BUILD UP
	EXISTING BUILD UP
	DEMOLITION
	WASTE PIPE DIRECTION
	JOISTS DIRECTION



MILTIADOU COOK MITZMAN architects llp

020 7722 8525
office@mcma.design
www.mcma.design

10-12 Emerald Mews
London
WC1N 3QA

CLIENT
Ian & Susan Ferguson

PROJECT
7 Sharpleshall Street, NW1 8YL

SHEET TITLE
Ground Floor Plan-Existing, Demolition and Proposed

SCALE
AS NOTED@A3

DATE CREATED **FILE REFERENCE**

DRAWING NUMBER	REVISION
408-DWG-002	P2