

[01] Existing Second Floor Plan

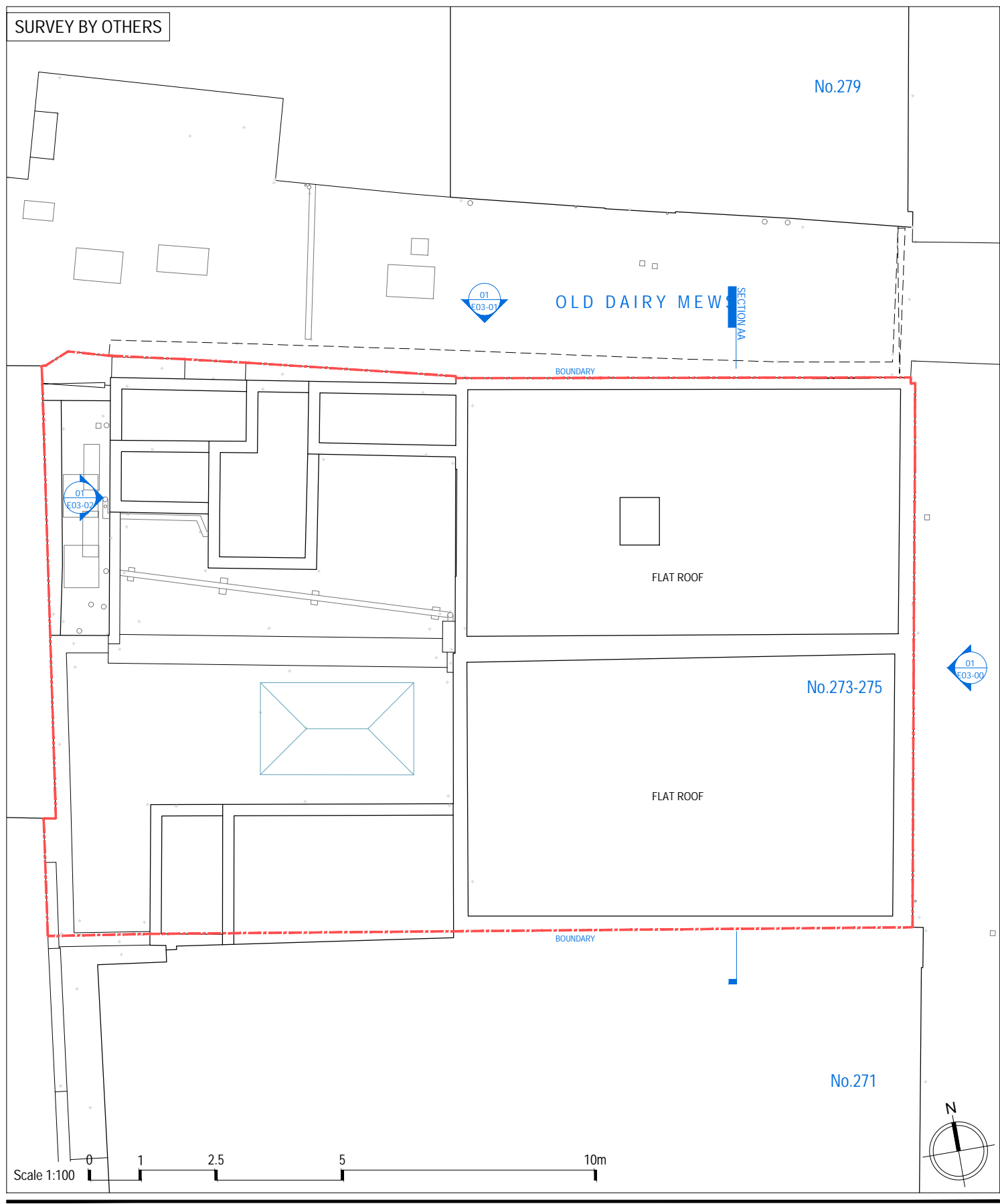

[02] Existing Roof Plan

NOTE:
DO NOT SCALE FROM DRAWINGS - EXCEPT FOR PLANNING PURPOSES.
ALL DISCREPANCIES TO BE REPORTED TO ARCHITECT IMMEDIATELY.
ALL DIMENSIONS TO BE VERIFIED BY CONTRACTOR ON SITE PRIOR TO THE COMMENCEMENT OF ANY WORKS.

P1 23/05/24 Issued For Planning

VIVENDI ARCHITECTS LTD
Unit E3U, Bounds Green Industrial Estate, Ringway, London N11 2UD
Tel/Fax +44 (0)20 3232 4000 - email: info@vivendiarchitects.com
© VIVENDI ARCHITECTS LTD 2009
All rights reserved, including but not limited to The Copyright, Designs and Patents Act 1988

CLIENT:
AMAK Property Investments Ltd

DRAWN: SM	STATUS: PLA
CHECKED: PK	SCALE AT A3: 1:100
ISSUED BY: PK	REVISION: P1
JOB AND DRAWING NO: 1963-E02-02	

PROJECT TITLE:
273-275 Kentish Town Road, London, NW5 2LP

DRAWING TITLE:
Existing Second Floor & Roof Plans