

Key - Plan

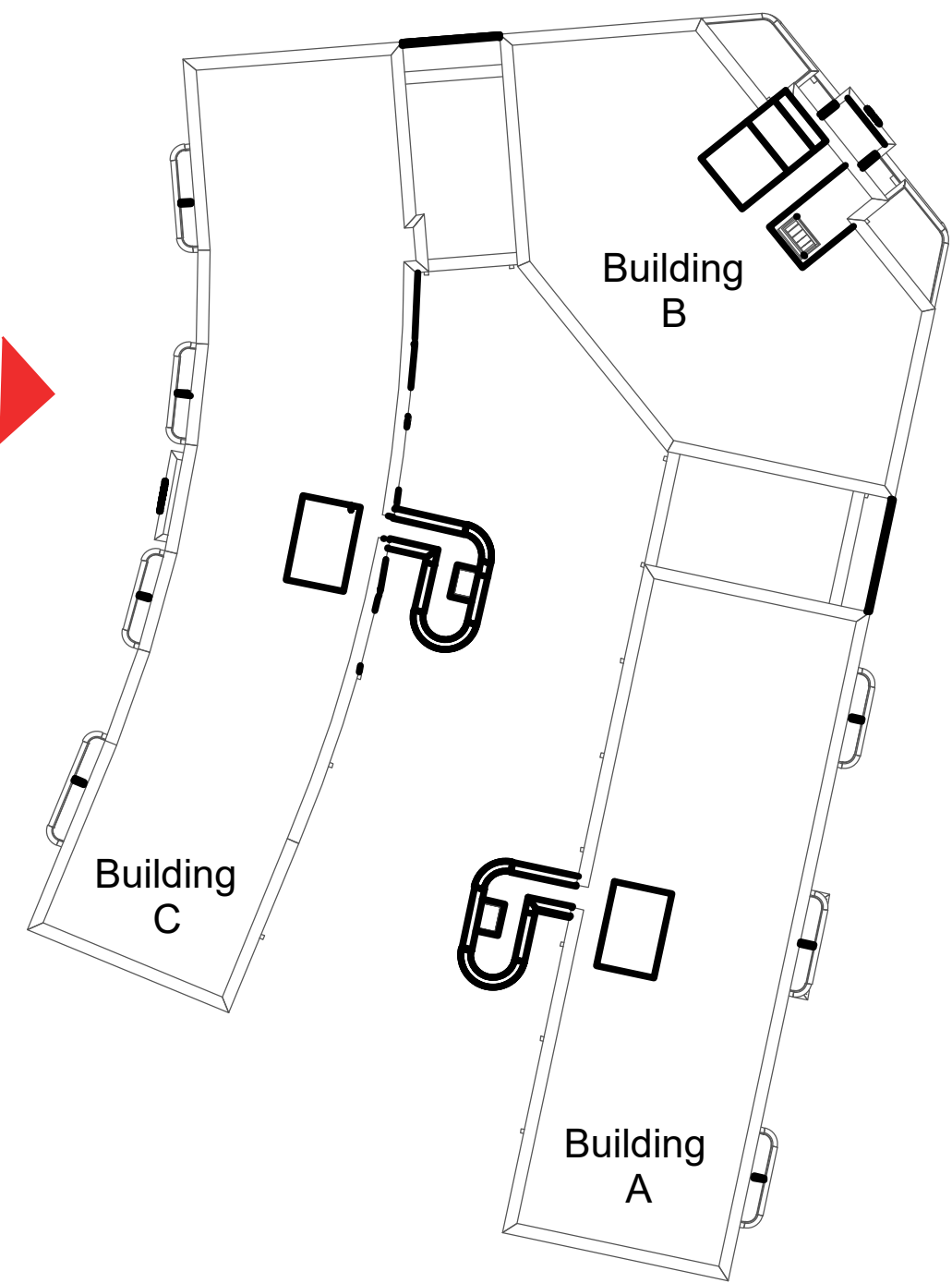

CDM 2015 Health & Safety Information

This information relates only to 'Significant Hazards' identified on this drawing and is to be read in conjunction with the Designer's Hazard Register.



Note:
Existing elevation drawings including within this planning submission are the same elevation drawings submitted and approved as part of the NMA Approved proposals drawings reference 2022/4524/P.

Approved Elevations:
Original Application Ref: 2022/4524/P.
Original Drawing number: LD504-ECE-ZZ-ZZ-PL-A-1401-P02

Client's Name



Job Title

Belmont Street, Camden

Drawing Title

Existing Elevation 3
(Building C - West)

Scale

1:100 @ A1 / 1:200 @ A3

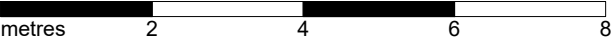

Drawn

PS

Checked

DU

Date

09.05.2024

Job No

LD504-ECE-ZZ-ZZ-PL-A-2004-P01

Drawing No

Rev

Status

For Approval

P01 09.05.2024 Planning Submission

PS PA

Rev	Date	Revision Details	Dr	Ch
-----	------	------------------	----	----



London: 76 Great Suffolk Street
London, SE1 0BL
T 0207 928 2773 E london@ecearchitecture.com
Sussex:

Bristol:

ECE Architecture
www.ecearchitecture.com