

Lift threshold & lift door to be lowered +/- 120mm down to slab level & plasterboard opening to be made good.

Adjustments to WC's fixed furniture joinery and sanitary items to accommodate new entrance location

Existing plantroom to be retained

Alterations to central core adjusting fixed furniture and joinery to form unit entrances. Refer to drawings 21593-0391 for typical detail.

Proposed exposed ductwork double skin decorative ducts serving ceiling services voids on levels 1 - 7. Atrium glazing to be removed in local surrounding ducts and replaced with glazing accommodating service penetrations at high level.

Proposed Atrium ductwork concealed with plasterboard enclosure.

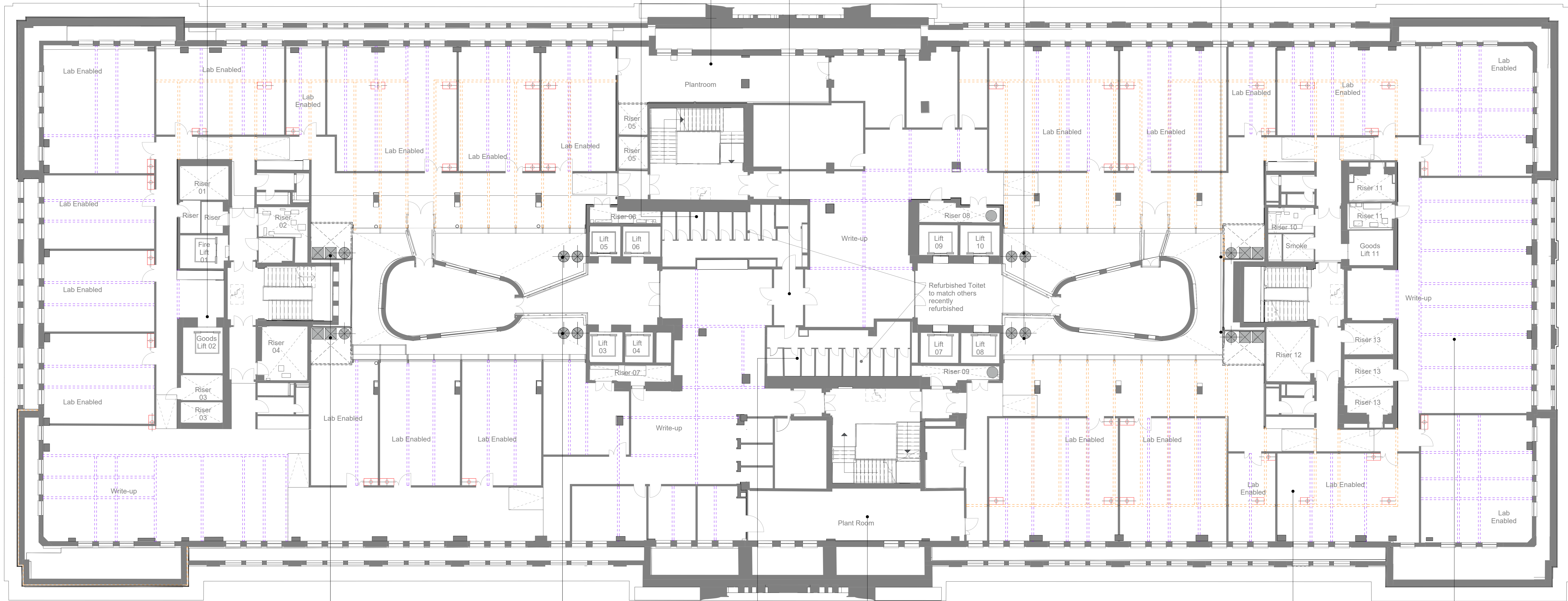

Proposed Atrium ductwork concealed with plasterboard enclosure.

Proposed exposed ductwork double skin decorative ducts serving ceiling services voids on levels 1 - 7. Atrium glazing to be removed in local surrounding ducts and replaced with glazing accommodating service penetrations at high level.

Adjustments to WC's fixed furniture joinery and sanitary items to accommodate new entrance location

Existing plantroom to be retained

Removal of Raised Access Floors in Lab Enabled Areas

Removal / Retainment of Raised Access Floors in Write-up spaces dependent on local condition.

1 Fifth Floor - Proposed  
1:100

- Proposed Partition Locations
- Proposed laboratory flex partition locations. (Minimum laboratory width = 3 meters)
- Proposed laboratory flex partition locations only for option where circulation corridor reverts to the outside perimeter
- Drainage Positions - Proposed drainage penetrations in slab
- Ramps - Proposed 'illustrative' location of transition in level from slab to raised access floor. Location dependent on final tenant fit out.

**Note**  
For all items being removed, please refer to demolition drawings 21595-0340 - 0356  
Existing services in modernised areas to be altered, refer to services consultant drawings and reports for details.

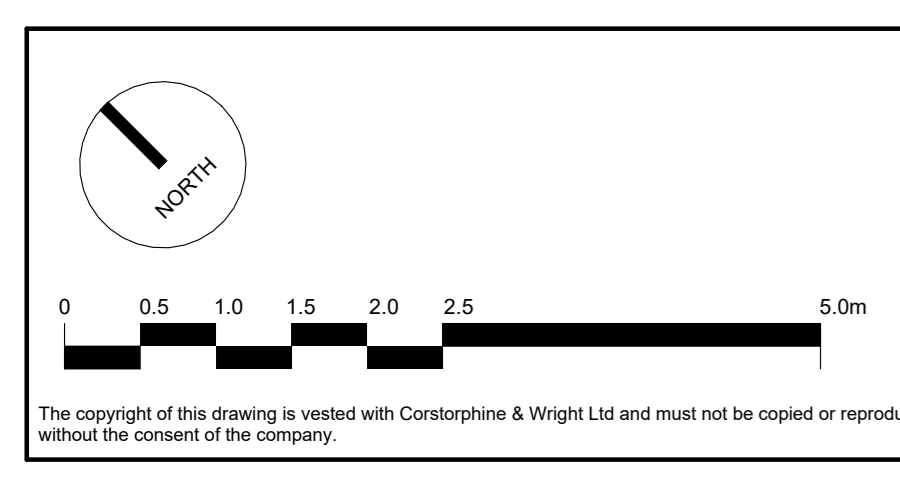

Rev	Description	Date	Drawn	Checked
01	FOR PLANNING	28/09/2022	RS	RS
02	FOR PLANNING	01/07/2022	RS	ATJ

Client: Oxford Victoria House Ltd.		<b>Corstorphine &amp; Wright</b>	
Project: 21593 - Victoria House		London Studio One Market Street, London, W1T 3JA 020 7463 0200	
Drawing Title: Proposed - Fifth Floor Plan		Drawing No: 21593-CWA-VH-05-DR-A-0331	
Drawn: ATJ	Checked: RS	Paper Size: A0	Scale: 1:100
Drawing Status: PLANNING		Date: 01/07/2022	Revision: P-01