

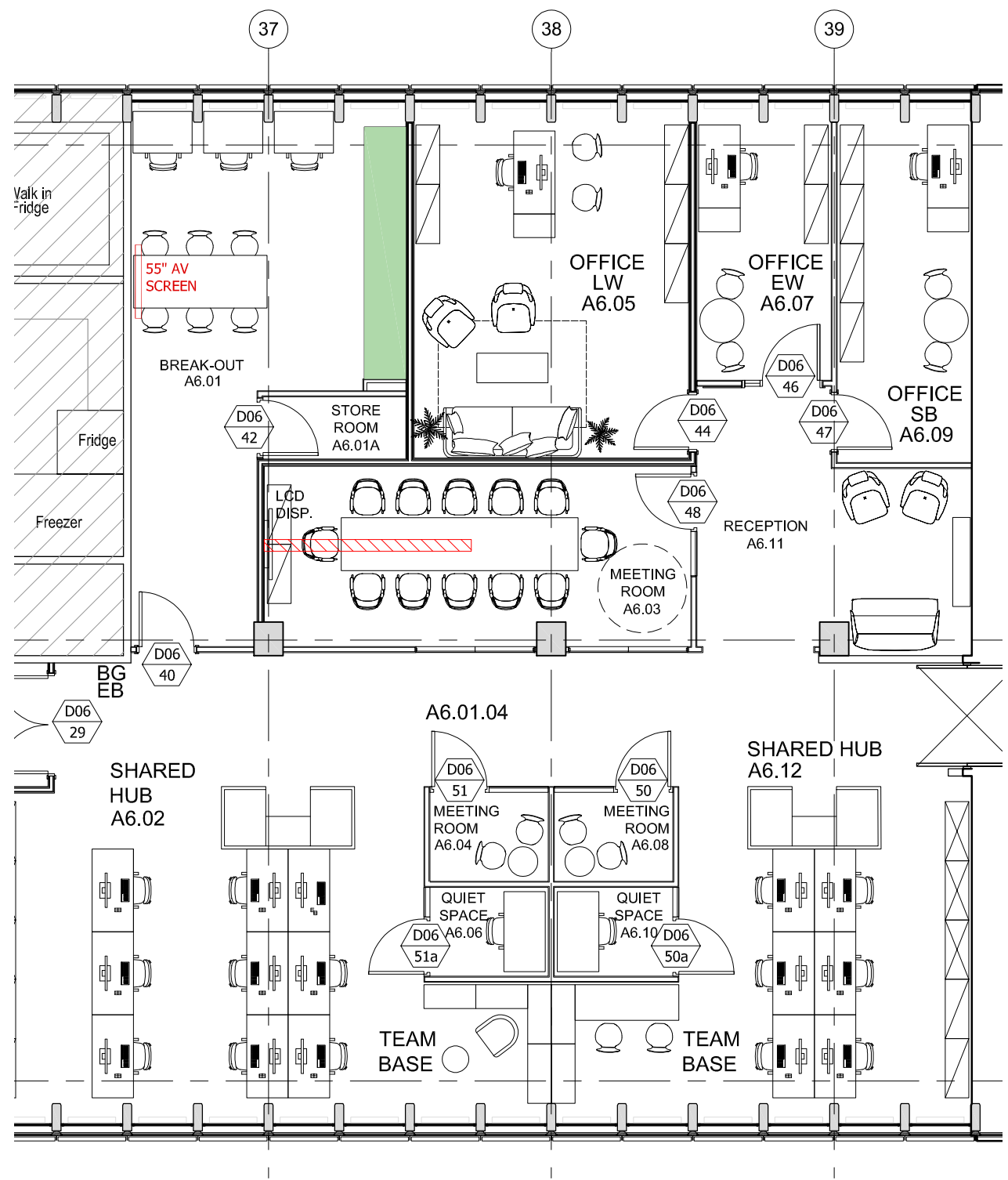

© Architon LLP 2014

This drawing is the property of Architon LLP and must not be divulged to anyone, copied or reproduced, or used for marketing, advertising or promotional purposes without the express written permission of Architon LLP.

All dimensions are to be checked on site and not scaled from this drawing. Contractors must verify all dimensions on site before setting out, commencing work or preparing shop drawings. Any discrepancies on this drawing with other contract documentation to be reported immediately for clarification.

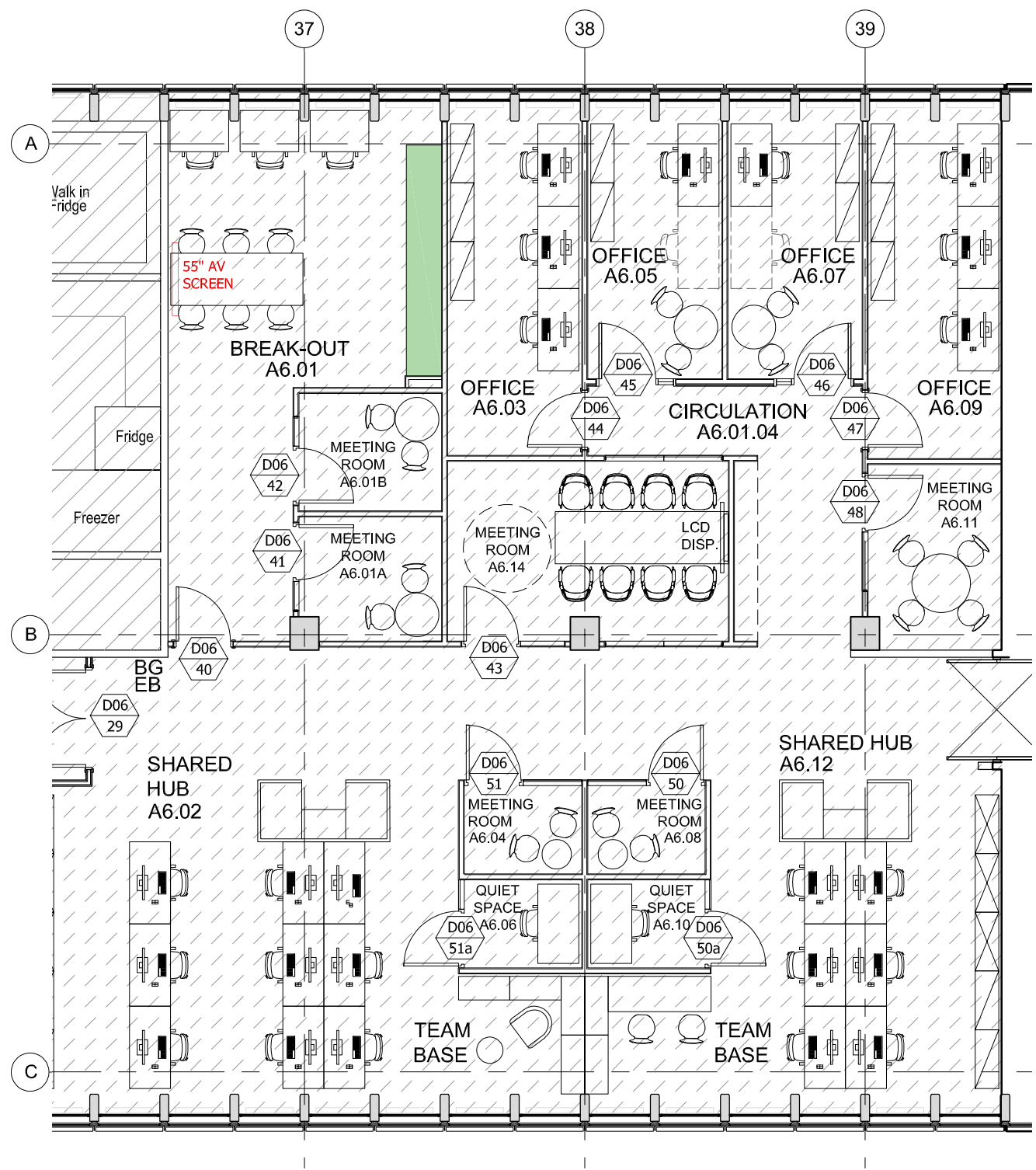

- LEGEND**
- INTERNAL AREAS OUTSIDE OF SCOPE
 - WORKS IN THIS AREA SUBJECT TO SEPARATE APPLICATIONS FOR FULL PLANNING PERMISSION & LISTED BUILDING CONSENT
 - CHASE OUT SCREED - EXTENT / DEPTH TO PROVIDE NEW ROUTE FOR ELECTRICAL SERVICES & ASSOCIATED CONTAINMENT
 - EXISTING CONCRETE WALL / COLUMN.
 - NEW DOOR
 - NEW TEAPOINT
 - CR CARD READER
 - EB/BG EXIT BUTTON / BREAK GLASS

1 LEVEL 6 - NIB A PLAN
AS EXISTING / APPROVED 1:50

2 LEVEL 6 - NIB A PLAN
AS PROPOSED 1:50

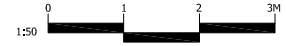

P2	PLANNING ISSUE	03.01.2024
P1	PLANNING ISSUE	24.11.2023
Rev	Description	Date

overbury Client

Job title
University College London
Institute of Education
Phase 2
20 Bedford Way, WC1H 0AL

Drawing title
Level 6 Nib A Plan
As Approved & As Proposed
Updated Layout
Planning Application 2G

Scale	Date	Drawn
1:50 @ A1	Oct 23	MJR

ARCHITON LLP

CHARTERED ARCHITECTS · DESIGN · PLANNING CONSULTANTS · DEVELOPMENT · BUILDING COST MANAGEMENT

UPPER DECK
17A WEST STREET
EPSOM KT18 7RL
Email: info@architon.com

TEL: 01372 745600

Drawing No	ARCHITON LLP certified to: BS EN ISO 9001 BS EN ISO 14001 IIP Accreditation
3147-P7-2615 - P2	

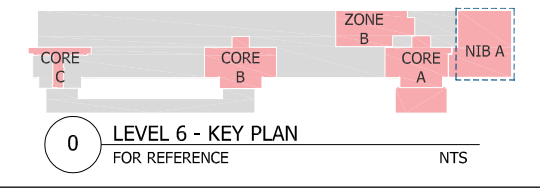

0 LEVEL 6 - KEY PLAN
FOR REFERENCE NTS