

© Architon LLP 2014

This drawing is the property of Architon LLP and must not be divulged to anyone, copied or reproduced, or used for marketing, advertising or promotional purposes without the express written permission of Architon LLP.

All dimensions are to be checked on site and not scaled from this drawing. Contractors must verify all dimensions on site before setting out, commencing work or preparing shop drawings. Any discrepancies on this drawing with other contract documentation to be reported immediately for clarification.

LEGEND

INTERNAL AREAS OUTSIDE OF SCOPE

WORKS IN THIS AREA SUBJECT TO SEPARATE APPLICATIONS FOR FULL PLANNING PERMISSION & LISTED BUILDING CONSENT

PROPOSED WORKS

REFER TO SERVICES CONSULTANT DOCUMENTATION FOR DETAILS OF ALL NEW SERVICE INSTALLATIONS. ALL SURFACES FOLLOWING STRIP-OUT ARE TO BE MADE GOOD, AS APPROPRIATE.

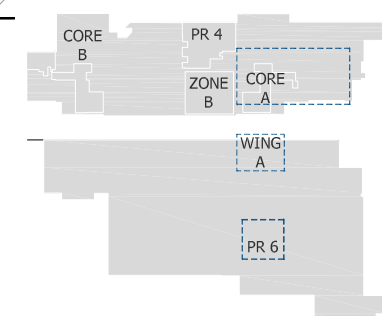

1 LEVEL 2 KEY PLAN FOR REFERENCE NTS

P3	PLANNING ISSUE	12.04.2024
P2	PLANNING ISSUE	24.11.2023
Rev	Description	Date

overbury Client

Job title
University College London
Institute of Education
Phase 2
20 Bedford Way, WC1H 0AL

Drawing title
Level 2 Plan
Works Proposed
Planning Application 2G

Scale	Date	Drawn
1:50 @ A1	Sept 23	MJR

ARCHITON LLP

CHARTERED ARCHITECTS · DESIGN · PLANNING CONSULTANTS · DEVELOPMENT · BUILDING COST MANAGEMENT

UPPER DECK 17A WEST STREET EPSOM KT18 7RL
TEL: 01372 745600 FAX: 01372 745016 Email: info@architon.com

Drawing No	ARCHITON LLP certified to: BS EN ISO 9001 BS EN ISO 14001 IIP Accreditation
3147-P7-2205 P3	

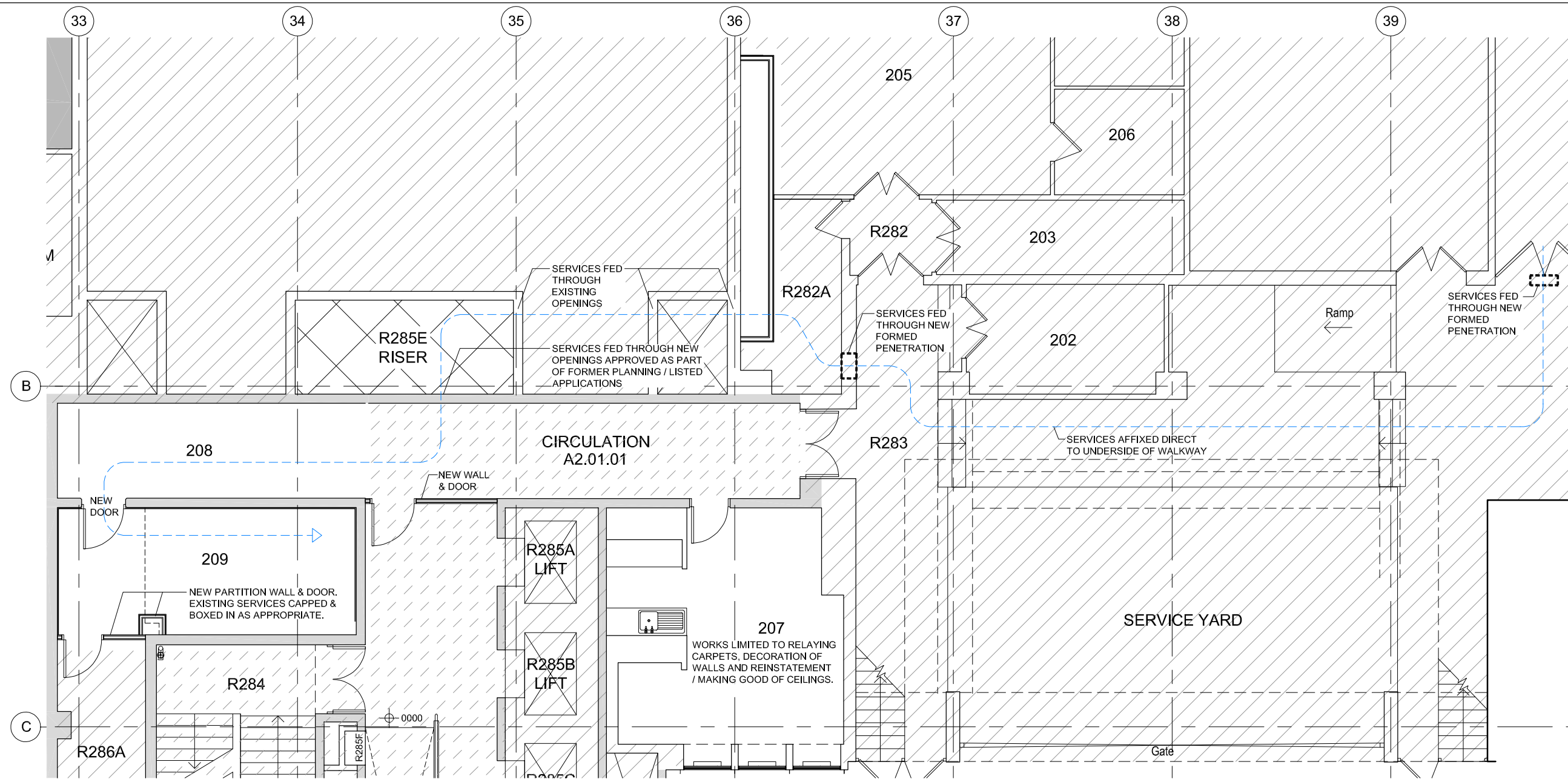

1 LEVEL 2 - CORE A AS PROPOSED 1:50

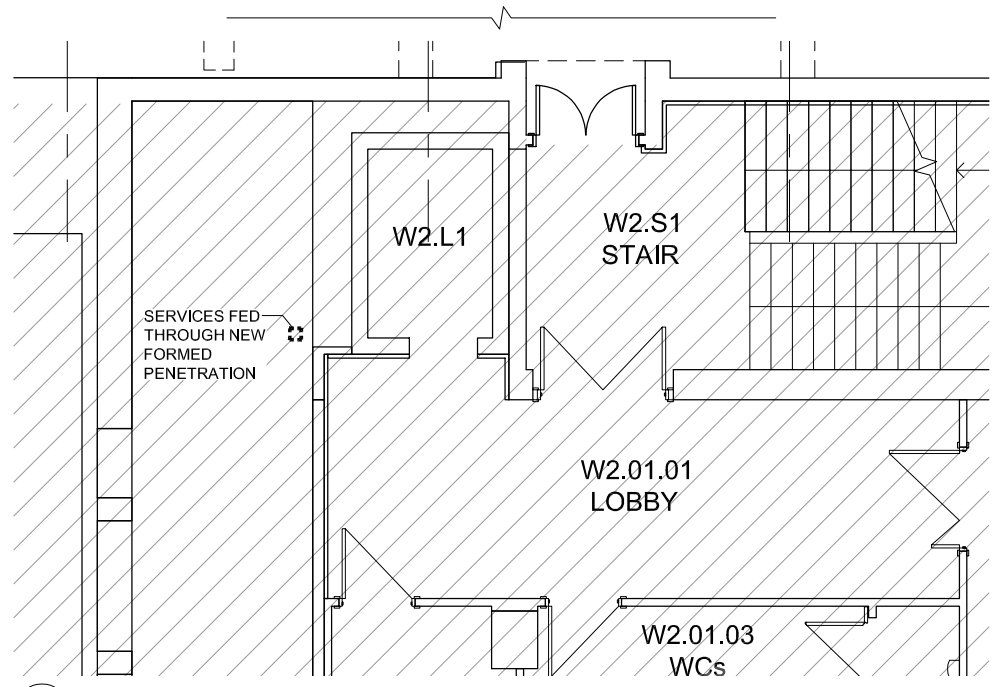

2 LEVEL 2 - WING A AS PROPOSED 1:50

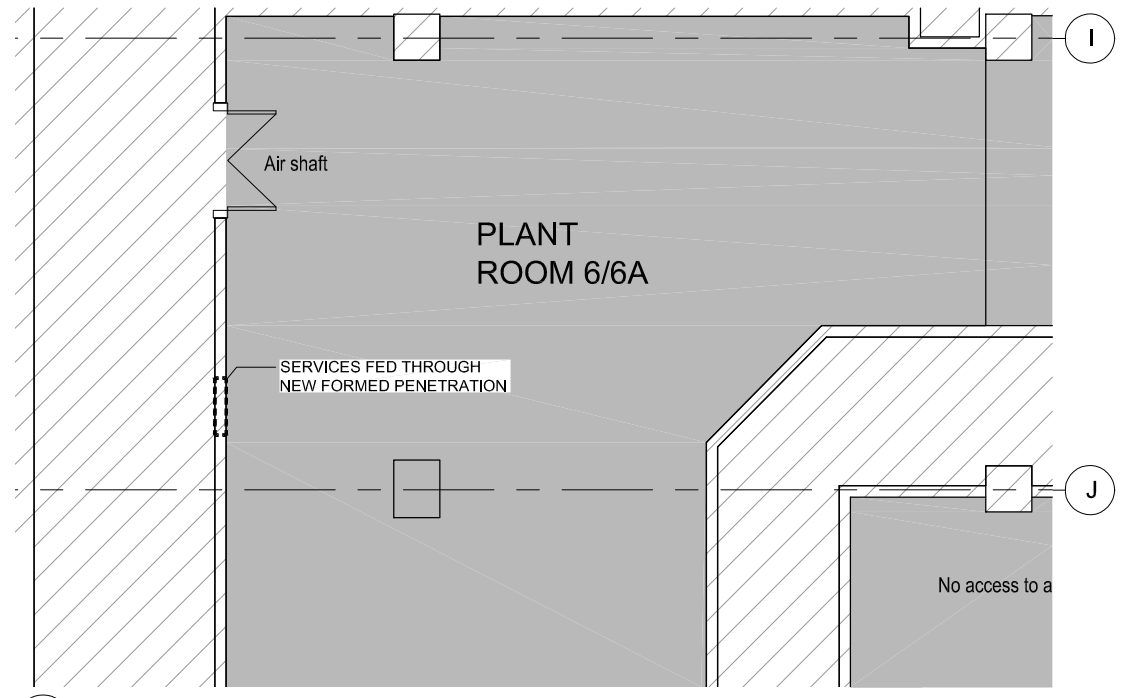

3 LEVEL 2 - PLANT ROOM 6/6A AS PROPOSED 1:50

