

BEDFORD WAY

BEDF



© Architon LLP 2014

This drawing is the property of Architon LLP and must not be divulged to anyone, copied or reproduced, or used for marketing, advertising or promotional purposes without the express written permission of Architon LLP.

All dimensions are to be checked on site and not scaled from this drawing. Contractors must verify all dimensions on site before setting out, commencing work or preparing shop drawings. Any discrepancies on this drawing with other contract documentation to be reported immediately for clarification.

Notes

- SITE BOUNDARY
- AREA OF WORKS AT LEVEL 9 SUBJECT TO APPLICATION FOR PLANNING & LISTED CONSENT
- AREA OF WORKS AT LEVEL 2 SUBJECT TO APPLICATION FOR PLANNING & LISTED CONSENT
- AREA OF WORKS AT LEVEL 5 / 6 / 7 SUBJECT TO APPLICATION FOR PLANNING & LISTED CONSENT
- AREA OF WORKS AT CORE A ROOF SUBJECT TO APPLICATION FOR PLANNING & LISTED CONSENT
- AREA OF WORKS AT LEVEL 6 NIB SUBJECT TO APPLICATION FOR PLANNING & LISTED CONSENT
- AREA OF WORKS AT LEVEL 4 CORE C SUBJECT TO APPLICATION FOR PLANNING & LISTED CONSENT
- AREA OF WORKS AT LEVEL 4 ZONE B SUBJECT TO APPLICATION FOR PLANNING & LISTED CONSENT

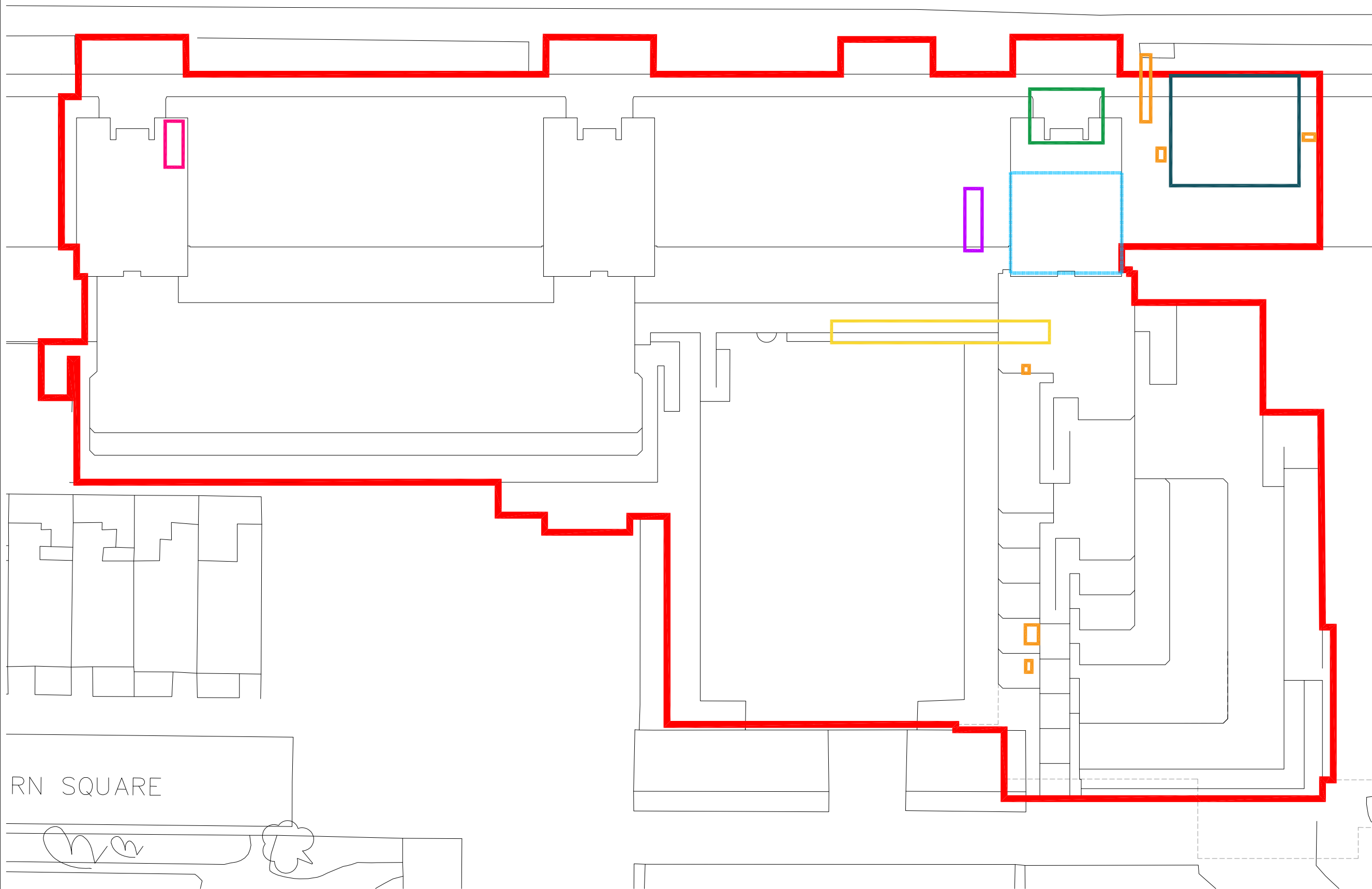

RN SQUARE

PLANNING ISSUE

P3	PLANNING ISSUE	05.02.2024
P2	PLANNING ISSUE	24.11.2023
P1	PLANNING ISSUE	26.09.2023

Rev	Description	Date
-----	-------------	------



Job title
 University College London
 Institute of Education
 Phase 2
 20 Bedford Way, WC1H 0AL

Drawing title
 Site Plan
 Planning Application 2G

Scale	Date	Drawn
1:200 @A1	Sept 2023	MJR

ARCHITON LLP
 CHARTERED ARCHITECTS · DESIGN ·
 PLANNING CONSULTANTS · DEVELOPMENT ·
 BUILDING COST MANAGEMENT

UPPER DECK TEL: 01372 745600
 17A WEST STREET FAX: 01372 745016
 EPSOM KT18 7RL Email: info@architon.com

Drawing No
 3147-P7-2002 P3

ARCHITON LLP
 certified to:
 BS EN ISO 9001
 BS EN ISO 14001
 IP Accreditation

1 Site Plan
 1:200 @ A1

