

NOTES

1 The Contractor must check and confirm all dimensions

2 All discrepancies must be reported and resolved by the Architect before works commence

3 All work and materials to be in accordance with current applicable Statutory Legislation and to comply with all relevant Codes of Practice and British Standards

Fire Strategy Legend

- 60min Fire Curtain
- 30min 30 Minutes Fire Rating
- 60min 60 Minutes Fire Rating  
50 Rw (dB) Acoustic Rating
- 120min 120 Minutes Fire Rating  
50 Rw (dB) Acoustic Rating
- Wall Mounted Fire Extinguisher Cabinet
- Wall Mounted Water Fire Extinguisher Cabinet (For wood, paper, textile and solid material fires)
- Wall Mounted Powder Fire Extinguisher Cabinet (For Liquid and Electrical Fires)
- Wall Mounted Foam Fire Extinguisher Cabinet (For Use on Liquid Fires)
- Wall Mounted Fire Carbon Dioxide Extinguisher Cabinet (For Liquid and electrical fires)
- Heat detector fixed to ceiling
- Fire / Carbon Monoxide detector fixed to ceiling
- Extent of Premises Boundary Line
- Travel Distance
- Evacuation Distance
- Evacuation Assembly Point
- REQUIRED DOOR RATING

GUIDANCE
- FD60S

60 Minute Fire door with smoke seals and self closers
- FD30S

30 Minute Fire door with smoke seals and self closers
- FE

Final escape
- Illuminated emergency sign  
Exit above escape doors

P01 Issued For Planning 19.04.24

Rev Date



Architecture & Interiors

10 Fitzroy Square, Fitzrovia, London, W1T 5HP

T020 8014 8130

www.aga-associates.com

Client

Ernesto Palanco

Project

Flat 3, 9 Wilmot Place, Camden,  
London, NW1 9JP

Drawing

Fire Safety Plans  
Level 00 Proposed

RJ Ref	Scale (A1)	Status	Revision
1072	1 : 50	Planning	P01

Drawing Number

1072-AGA-AZ-ZZ-DR-A-26100

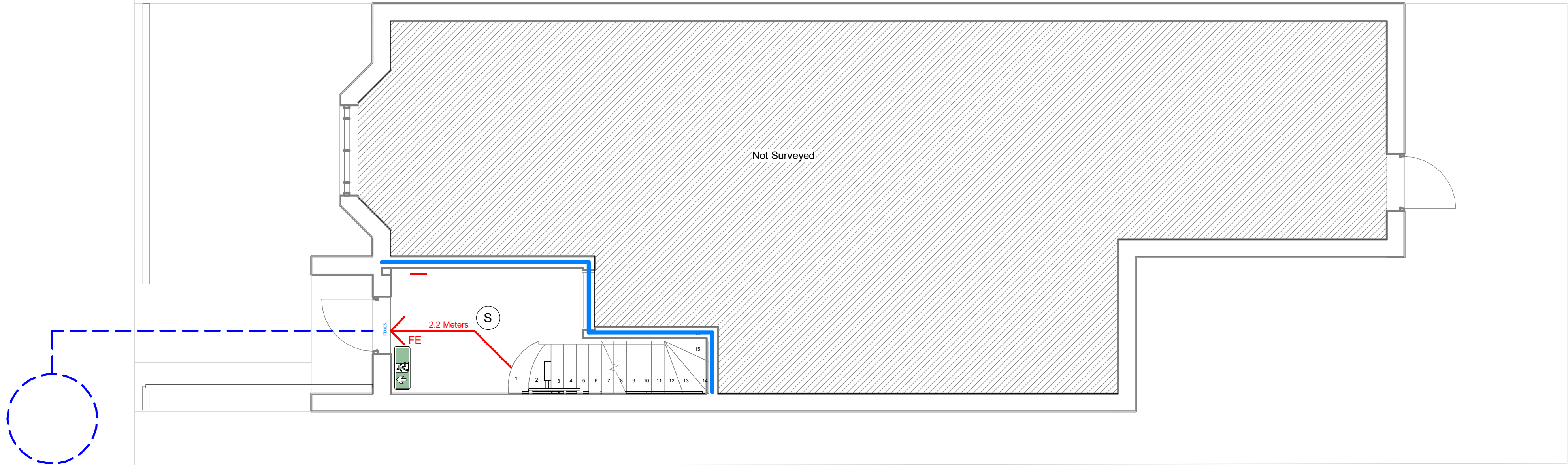

1 26100-Level 00 Fire Plan

SCALE: 1 : 50