

© Brookes Architects Limited (BAL), all rights reserved.

This drawing has been prepared for the use of BAL 's client specifically for the site titled below. It may not be used, modified, reproduced or relied upon by third parties.

Do not scale from this drawing. All areas are approximate. All dimensions are to be verified on site prior to construction. Responsibility for the reproduction of this drawing lies with the recipient to check that all information has been replicated in full when compared with the original.

This drawing must be read in conjunction with all other relevant consultants' information.

All works are to be carried out in accordance with current British Standards, Building Regulations and relevant Codes of Practice.

Refer to the Construction (Design and Management) documentation where applicable. It is assumed that all works will be carried out by a competent contractor working, where necessary, to an approved method statement.

This drawing is based on model information provided by AHMM solely for the purposes of preparing this application on behalf of BAL's client and in accordance with AHMM's General Disclaimer.

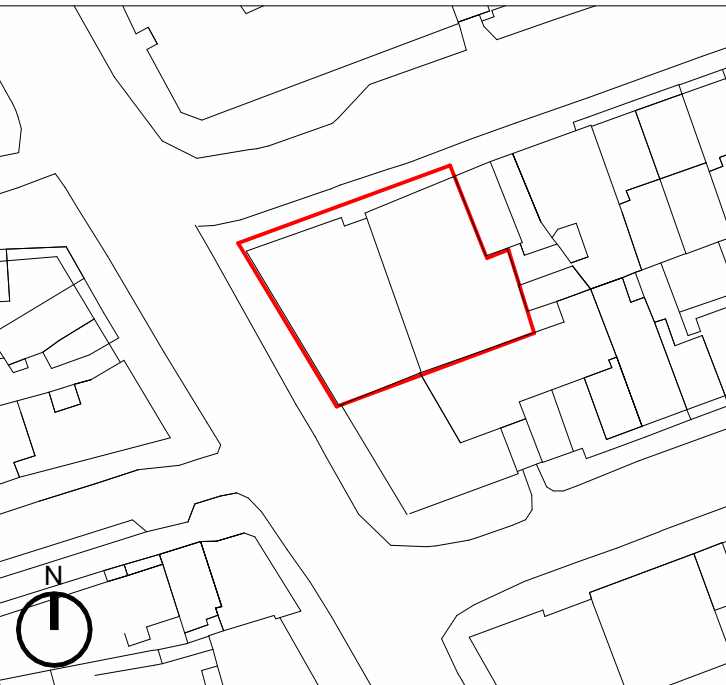

Site Location Plan

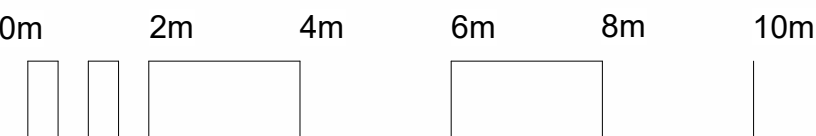

Visual Scale 1:100

PLANNING

[illegible]

Myco

Project No.

5361

Project

Acorn House

Gray's Inn Road

London, WC1X 8DP

Drawing

Proposed Elevations Greys Inn Road (SW)

Scale	Date	Drawn	Checked
1 : 100@A1	Mar '24	TL	TL

Brookes Architects

Unit 1 - 56 Glenthams Road
London SW13 9JJ

T 020 8487 1223

www.brookesarc

5361-BAL-XX-XX-DR-A-07-0121 | Revision P1
PI
Status