

NOTE:
 These drawings have been prepared using topographic information from Greenhatch, Lane & Frankham CAD files LF1025 of the existing Acorn House building & OS map data & Z map data. All topographical and building dimensions are to be confirmed with a measured survey

REV	DATE
P2	05/11/20 Post Submission Changes
P1	19/08/20 Planning Submission

CONSULTANTS	NAME
CLIENT:	ACCESS STORAGE
STRUCTURAL ENGINEER:	AKT II
MECHANICAL ENGINEER:	ATELIER TEN
COST CONSULTANT:	CAST CONSULTANCY
PROJECT MANAGER:	RPM
ACOUSTIC CONSULTANT:	SANDY BROWN
FIRE & APPROVED INSPECTOR:	BUREAU VERITAS

NOTE
 When this drawing is issued in uncontrolled CAD format it will be accompanied by a PDF version and is issued to enable the recipient to prepare their own documents / models / drawings for which they are solely responsible. The recipient should report all drawing errors, omissions and discrepancies to the architect. All dimensions should be checked on site by the contractor and such dimensions shall be the contractor's responsibility.

Allford Hall Monaghan Morris Limited accepts no responsibility or liability for:-
 - any use of this drawing by parties other than the party for whom it was prepared or for purposes other than those for which it was prepared
 - any alterations or additions to or discrepancies arising out of changes to the background information on which the drawings are based that was current at the time of issue, and which occur to that information after it has been issued by AHMM
 - any loss or degradation of the information held in this drawing resulting from the translation from the original file format to any other file format or from the recipient's reading of it in any other programme or any version of the programme other than that which was used to prepare it
 - the accuracy of survey information provided by others or for any costs, claims, proceedings and expenses arising out of reliance on such information
 - any scaling from this drawing other than by the local planning authority solely for the purposes of the planning application to which it relates

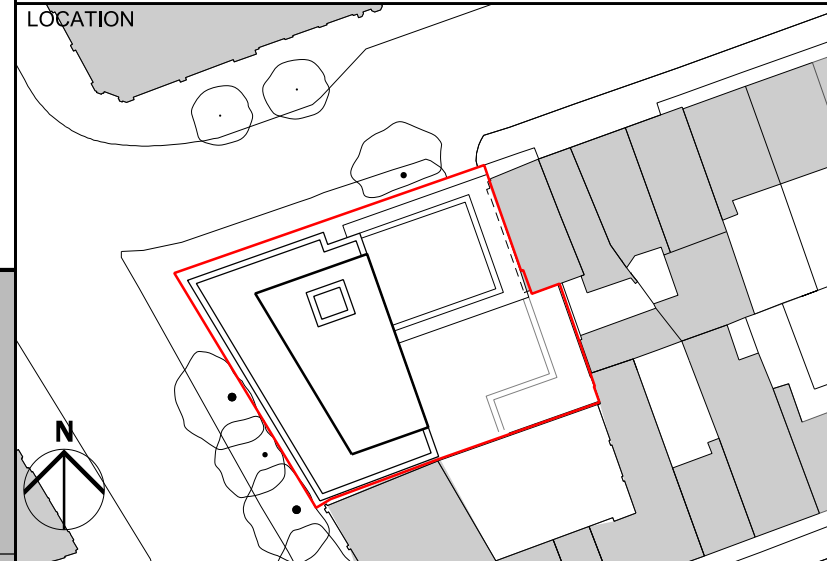

ALLFORD HALL MONAGHAN MORRIS
 ARCHITECTS Ltd
 MORELANDS, 5-23 OLD STREET LONDON EC1V 9HL
 TEL 020 7251 5281 FAX 020 7251 5123 WEB WWW.AHMM.CO.UK

job title		ACORN HOUSE	
drawing title / location		ELEVATION 02 SWINTON STREET (NW FACING)	
drawn by	checked	scale	status
MC	SS	1:100@A1; 1:200@A3	PLANNING
project	zone	source	classification drawing no. revision
18102		A	(00)_202 P2