

DISCLAIMER:
 DO NOT SCALE FROM THESE DRAWINGS. FOR ACCURACY ALL DIMENSIONS AND SPECIFICATIONS MUST BE CONFIRMED AT THE SITE AND WITH RELEVANT TECHNICAL DRAWINGS.
 TO BE READ IN CONJUNCTION WITH STRUCTURAL ENGINEER'S DRAWINGS AND SPECIFICATIONS.
 TO BE READ IN CONJUNCTION WITH ALL CONSULTANT DRAWINGS AND SPECIFICATIONS.
 ANY DISCREPANCY BETWEEN DRAWINGS AND DIMENSION ON SITE ARE TO BE BROUGHT TO THE ATTENTION OF THE ARCHITECT PRIOR TO CONSTRUCTION.

2023 © CHARLES TASHIMA ARCHITECTURE. ALL RIGHTS RESERVED.
 NO REPRODUCTION OR SECONDARY CONTENTS WITHIN THIS DOCUMENT SHOULD BE COPIED OR REPRODUCED WITHOUT THE CONSENT OF CHARLES TASHIMA ARCHITECTURE.

- KEY**
- 1. SEDUM BLANKET / GREEN ROOF
 - 2. ROOFLIGHT

PROPOSED NEW METAL STAIR TO MATCH BALCONY RAILINGS

PROPOSED NEW DOORS - TRADITIONAL HARDWOOD DOUBLE GLAZED FRENCH DOORS WITH MARGINAL GLAZING BARS, PAINTED. INTERNAL SHUTTERS, SOURROUNDS AND MOULDINGS RETAINED.

PROPOSED NEW SIDE EXTENSION - SEDUM / GREEN ROOF WITH SKYLIGHTS

PROPOSED LOCATION FOR REPLACEMENT TREE

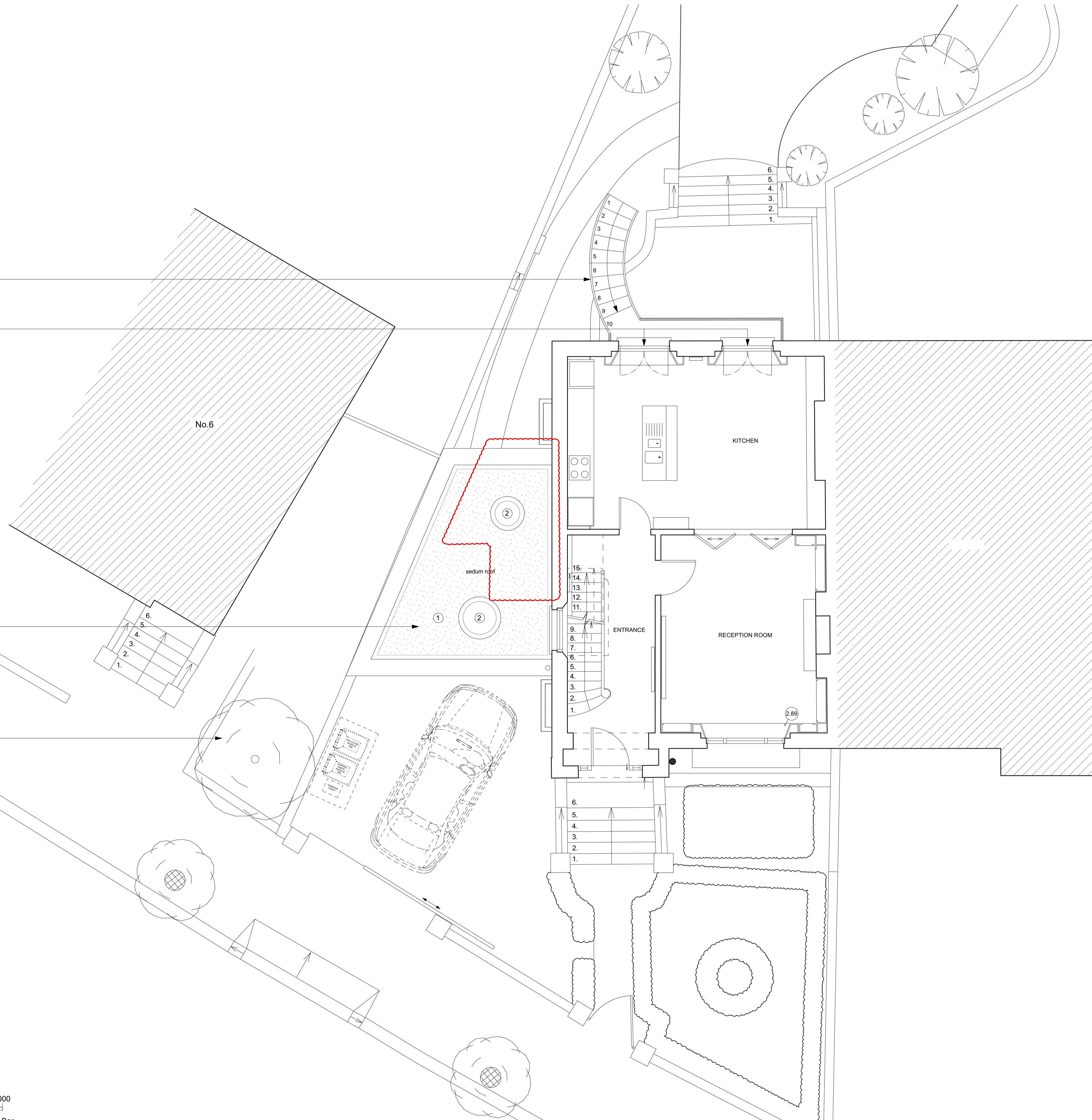
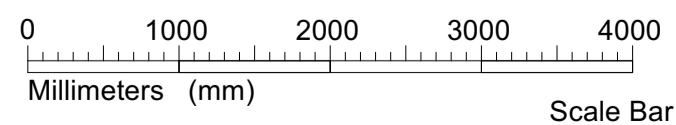
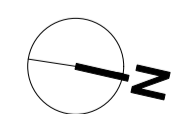

REV.	DATE	ISSUE NOTES
A	15/05/2024	REVISIONS SHOWN IN CLOUD BASED ON COMMENTS FROM COUNCIL RECEIVED ON 3RD MAY 2024

PLANNING

PROJECT: 8 DARTMOUTH PARK ROAD, LONDON, NW5 1SU	
PROJECT NUMBER:	1136
PROJECT STAGE:	PLANNING
ISSUE DATE:	DECEMBER 2023
SCALE:	1:50 @ A1 1:100 @ A3
DOCUMENT NUMBER:	PL111
REVISION:	A
SUBJECT: PROPOSED - UPPER GROUND FLOOR PLAN	
CLIENT:	OLIVIA WAREHAM & ALEXANDER COFFEY
CHARLES TASHIMA ARCHITECTURE Unit 6, Benwell Studios, 11-13 Benwell Road London, N7 7BL Phone: 44(0) 207 281 2351 Email: info@charlestashima.co.uk Website: www.charlestashima.co.uk	