

DISCLAIMER:
 DO NOT SCALE FROM THESE DRAWINGS. FOR ACCURACY ALL DIMENSIONS AND SPECIFICATIONS MUST BE CONFIRMED AT THE SITE AND WITH RELEVANT TECHNICAL DRAWINGS.
 TO BE READ IN CONJUNCTION WITH STRUCTURAL ENGINEER'S DRAWINGS AND SPECIFICATIONS.
 TO BE READ IN CONJUNCTION WITH ALL CONSULTANT DRAWINGS AND SPECIFICATIONS.
 ANY DISCREPANCY BETWEEN DRAWINGS AND DIMENSION ON SITE ARE TO BE BROUGHT TO THE ATTENTION OF THE ARCHITECT PRIOR TO CONSTRUCTION.

2023 © CHARLES TASHIMA ARCHITECTURE. ALL RIGHTS RESERVED.
 NO REPRODUCTION OR DISSEMINATION OF THIS DOCUMENT SHOULD BE COPIED OR REPRODUCED WITHOUT THE CONSENT OF CHARLES TASHIMA ARCHITECTURE.

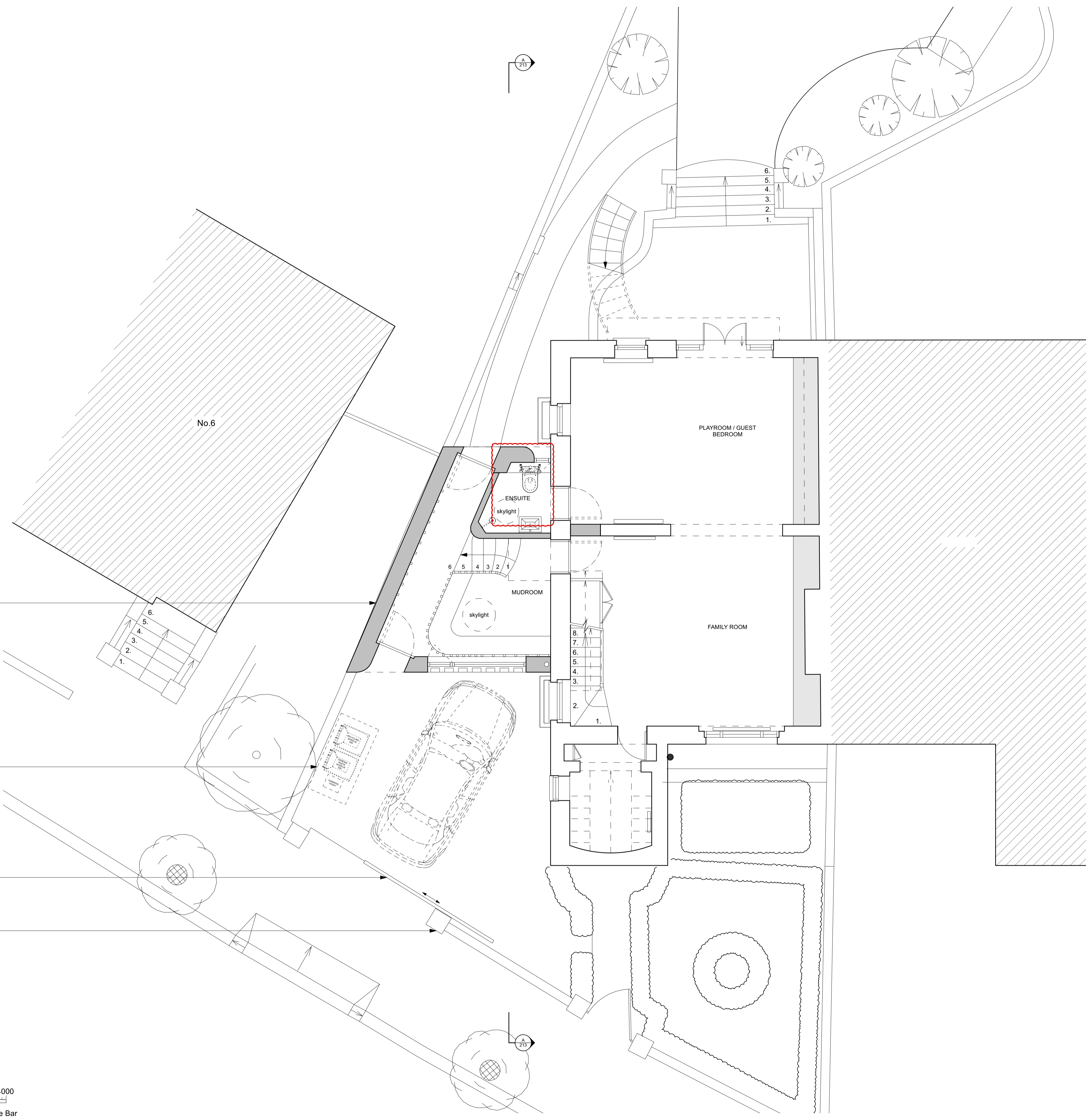

PROPOSED NEW SIDE EXTENSION - SUNKEN MUDROOM AND ENSUITE, EXISTING PASSAGEWAY TO REAR GARDEN MAINTAINED

PROPOSED NEW OFF THE SHELF BIN STORE. TIMBER CLAD WITH SEDUM ROOF TO ACCOMMODATE 2 WHEELIE BINS AND KERBSIDE CADDY.

PROPOSED ELECTRIC METAL SLIDING GATE TO MATCH EXISTING. TRADITIONAL SPEAR HEADED RAILING DETAIL RETAINED.

OPENING WIDENED. BRICK PIER REBUILT IN NEW LOCATION TO MATCH EXISTING. RAILINGS AND DWARF BRICK WALL ADJUSTED TO SUIT NEW OPENING WIDTH.

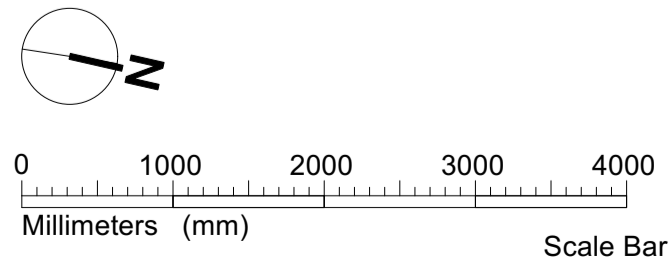

REV.	DATE	ISSUE NOTES
A	15/05/2024	REVISIONS SHOWN IN CLOUD BASED ON COMMENTS FROM COUNCIL RECEIVED ON 3RD MAY 2024

PLANNING

PROJECT:
8 DARTMOUTH PARK ROAD, LONDON, NW5 1SU

PROJECT NUMBER: 1136

PROJECT STAGE: PLANNING

ISSUE DATE: DECEMBER 2023

SCALE: 1:50 @ A1
 1:100 @ A3

DOCUMENT NUMBER: PL110

REVISION: A

SUBJECT:
PROPOSED - LOWER GROUND FLOOR PLAN

CLIENT: OLIVIA WAREHAM & ALEXANDER COFFEY

CHARLES TASHIMA ARCHITECTURE
 Unit 6, Benwell Studios, 11-13 Benwell Road
 London, N7 7BL
 Phone: 44(0) 207 281 2351
 Email: info@charlestashima.co.uk
 Website: www.charlestashima.co.uk