

91a Belsize Lane – Design & Access Statement – Front patio works



91a Belsize Lane – Design & Access Statement – Front patio works

Existing

- Damaged stone pavers in need of replacement;
- Existing drain gully insufficient capacity to handle heavy rain and needs upgrading;
- Current pavers are an inconsistent mix of concrete and natural stone.



Existing pavers – damaged in need of replacement



Existing stairs to lower ground floor entrance



Existing footwell drain with linear drain surround

91a Belsize Lane – Design & Access Statement – Front patio works

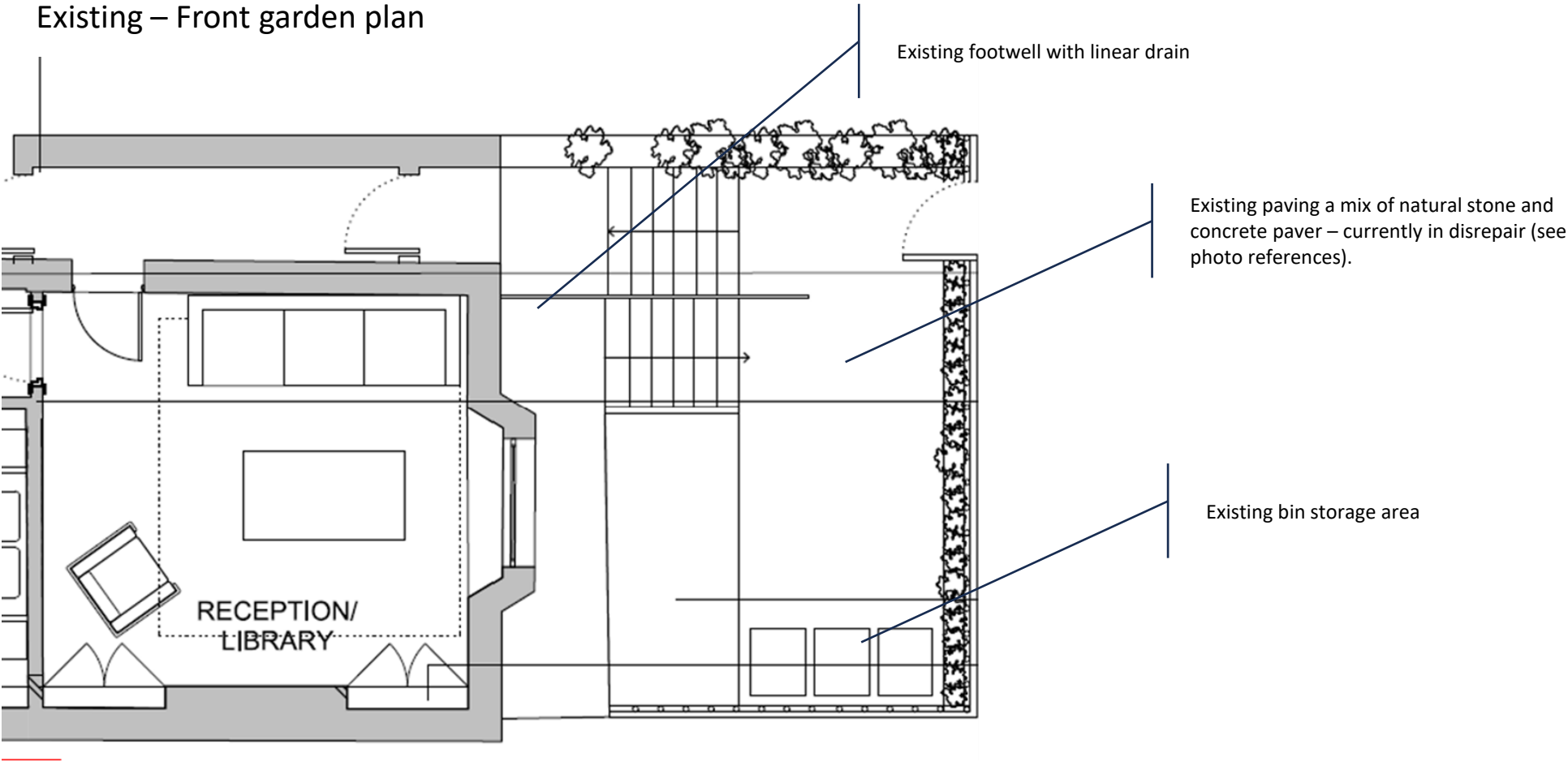

91a Belsize Lane – Design & Access Statement – Front patio works

Existing

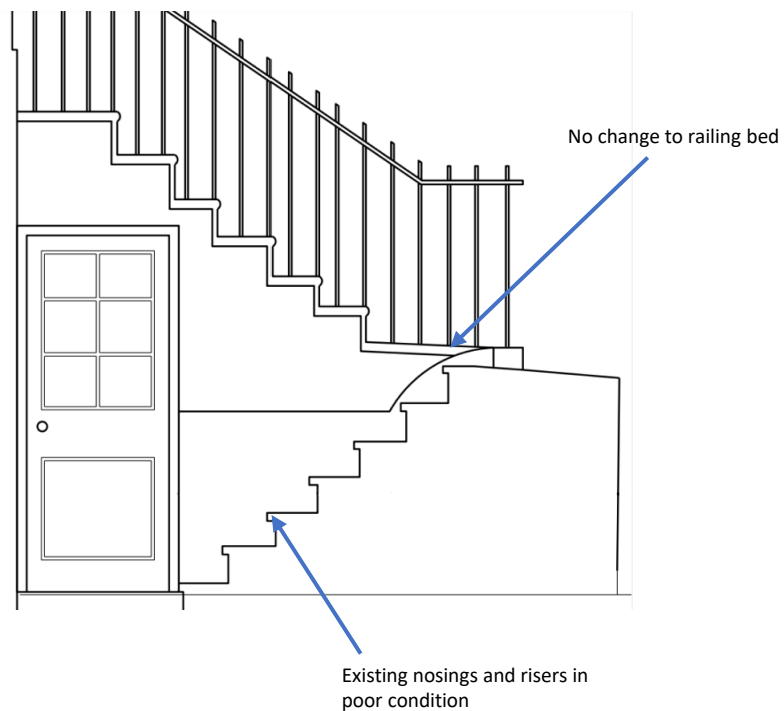

Existing stairs looking towards Belsize Lane

91a Belsize Lane – Design & Access Statement – Front patio works

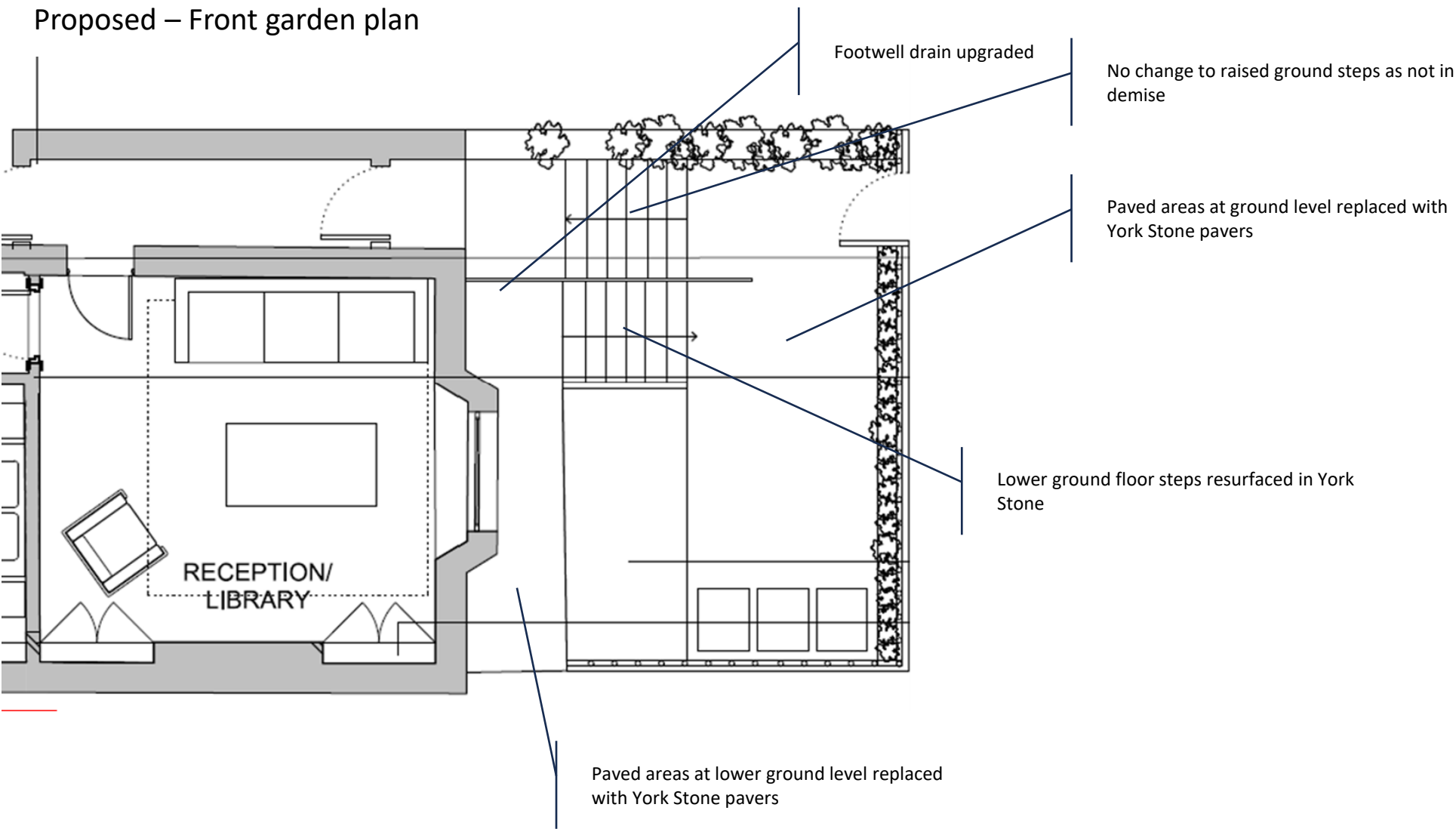

91a Belsize Lane – Design & Access Statement – Front patio works

Proposed - steps and nosing detail

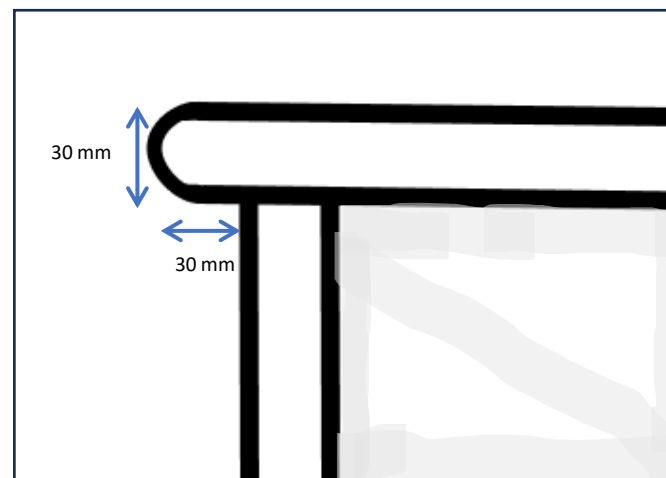
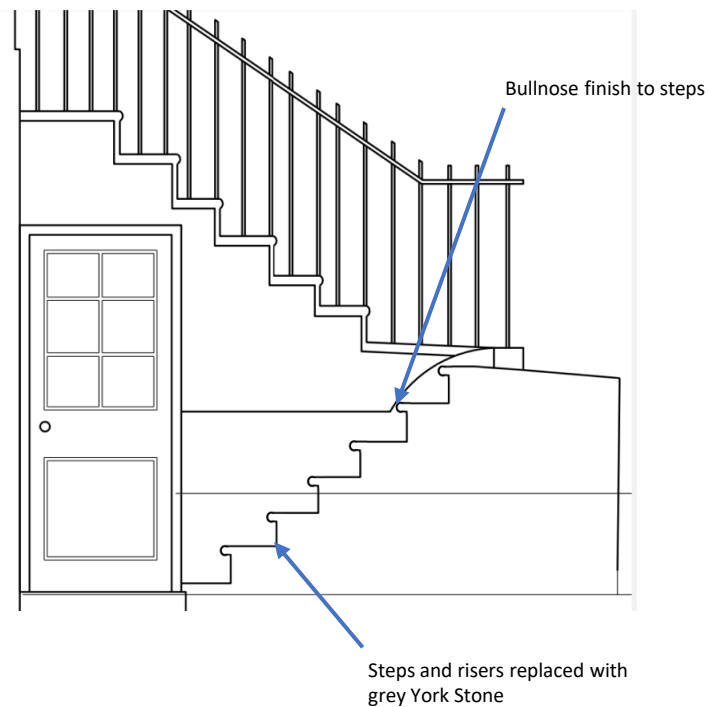

Nosing detail for steps

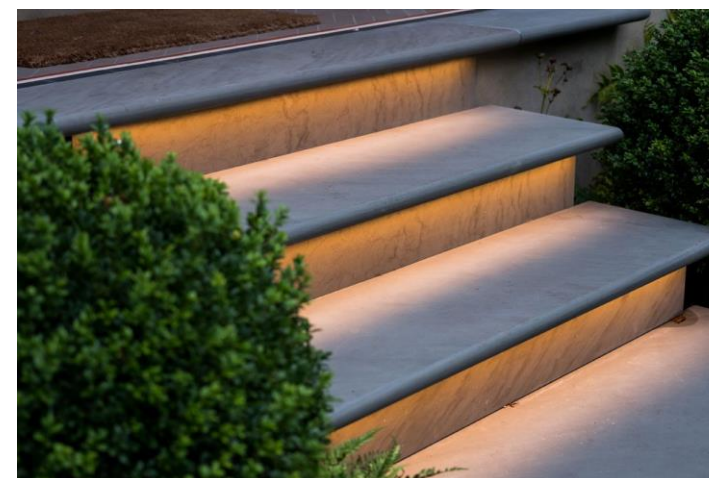

Reference image – grey York Stone

91a Belsize Lane – Design & Access Statement – Front patio works

Proposed – Footwell drainage

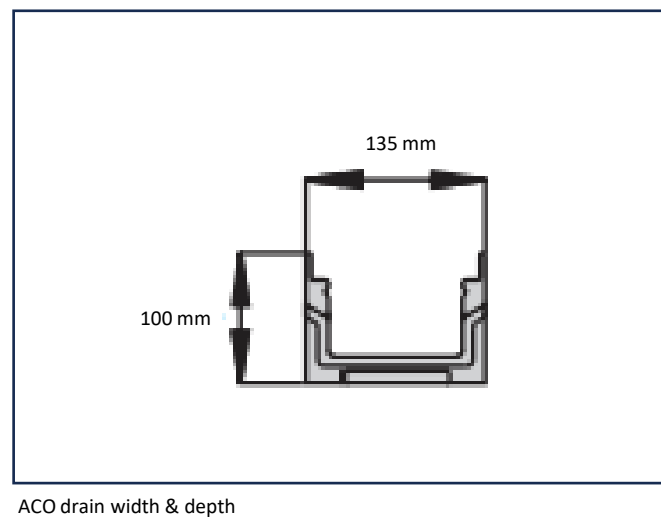
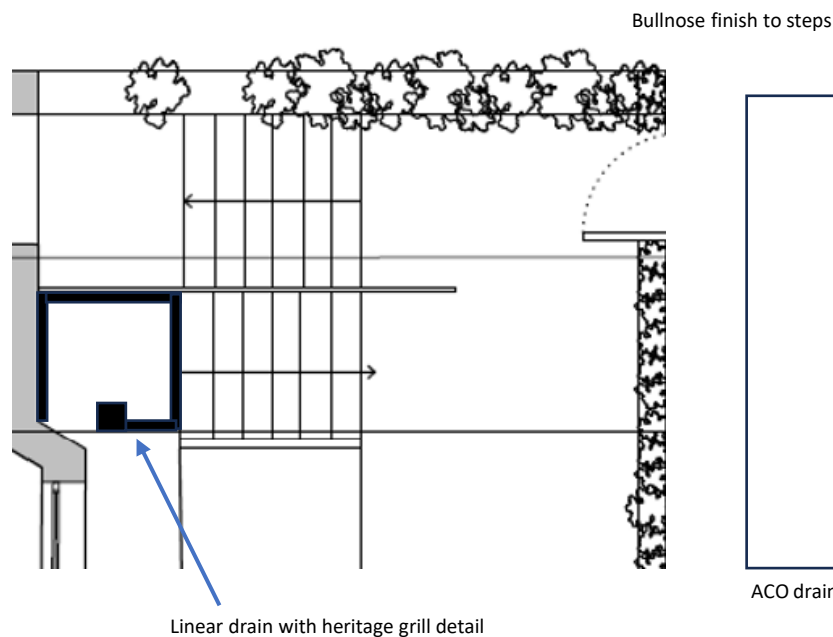

Galvanised iron heritage grill detail